



595 DESIGN

CHARLOTTE:  
508 West Fifth St., 250 t 704 348 7000  
Charlotte, NC 28202 f 704 348 7005

# WILDLIGHT

## PROPOSED SIGNAGE MASTER PLAN

Wildlight Phase 1 - East Nassau, Florida



|  |  |                             |               |
|--|--|-----------------------------|---------------|
| CLIENT:<br>Raydient<br>1901 Island Walkway<br>Fernandina Beach, FL 32034 | t (904) 321-1023<br>(c) (904) 568-2359<br>Greg Jones | ORIGINAL ISSUE: 30 AUG 2017 |               |
|  |  | REVISIONS: 1                | 13 SEPT 2018  |
|  |  | 2                           | 25 MARCH 2019 |
|  |  |                             |               |
|  |  |                             |               |
|  |  |                             |               |



| PROJECT ENVIRONMENTAL GRAPHICS PHASE 1 - SCOPE OF WORK |     |   |
|--|-----|---|
| Sign Type #  | Qty | Sign Name/Description   |
| Overall Project Site Sign Items                        |     |   |
| 10.01  | 4   | Project Entry Tower along A1A   |
| 10.02 (Temp)   | 2   | <b>Temporary</b> Identification Sign to be in Place During Hywy A1A Construction                      |
| 10.02A (Perm)  | 1   | <b>Permanent</b> Project Identification Sign with Tenant Listing at Village Entry, Hywy A1A Northside |
| 10.02B (Perm)  | 1   | <b>Permanent</b> Project Identification Sign, Hywy A1A Southside                                      |
| 10.03  | 1   | Large Project ID Sign with Tenant Listing   |
| 10.04  | 20  | Landscape Sculptural Bird(s) - (20 - Phase 1 & 10 - Phase 2 . Total quantity at build out = 30)       |
| 10.06  | TBD | Outparcel Ground Mounted Identification Sign - along Hywy A1A   |
| 10.07  | 1   | Wildlight Village Entry Gateway Portal - to hold a temporary banner spanning street                   |
| 10.09  | TBD | Main Site Vehicular Directional Sign  |
| 10.10  | TBD | Tenant Directional  |
| 10.11  | TBD | Project Street Sign   |
| 10.12  | TBD | Vehicular Traffic (D.O.T.) Post & Panel Sign(s)   |
| 10.13  | TBD | Secondary Wayfinding Sign   |
| Temporary Residential Sales Sign Items                 |     |   |
| 20.01  | 1   | Sales Center Identification   |
| 20.03  | TBD | Model Home Identity Sign  |
| 20.04  | TBD | Builder Lot Sign  |

Proposed Master Signage Plan



Wildlight  
PROJECT

Raydient  
OWNER

KK, CD, BJ, KK  
505 DESIGN TEAM

|                 |                |
|-----------------|----------------|
| ORIGINAL ISSUE: | 30 AUG 2017    |
| REVISIONS:      | 1 13 SEPT 2018 |
|                 |                |
|                 |                |
|                 |                |
|                 |                |
|                 |                |
|                 |                |

Package Index

These drawings are for the sole purpose of expressing visual design intent and are not intended for construction purposes. All aspects engineering, fabrication, installation, and any resulting documentation are the responsibility of the Fabricator.



Proposed Master  
Signage Plan



Wildlight  
PROJECT

Raydient  
OWNER

KK, CD, BJ, KK  
505DESIGN TEAM

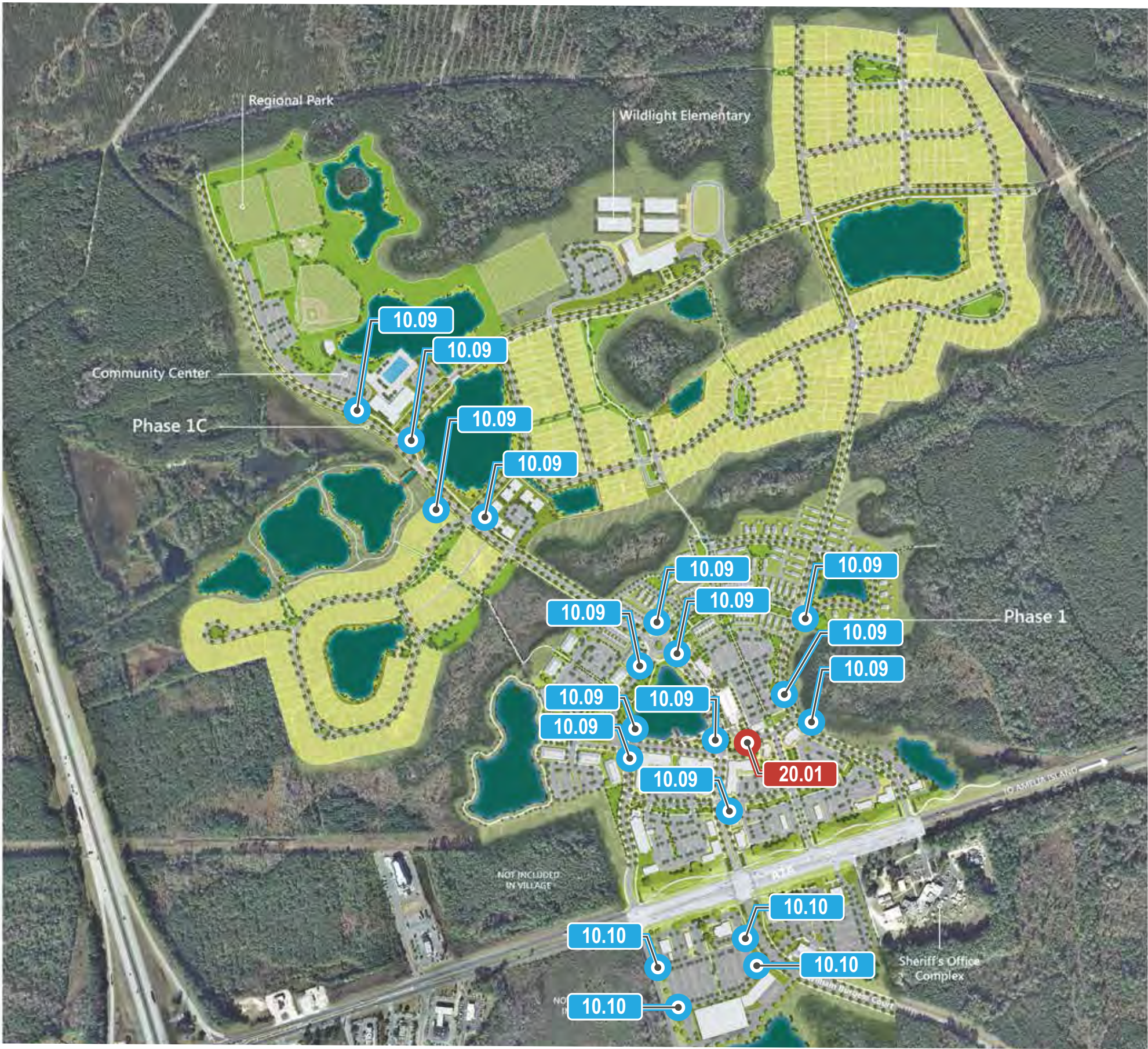

|                 |               |
|-----------------|---------------|
| ORIGINAL ISSUE: | 30 AUG 2017   |
| REVISIONS:      |               |
| <div>2</div>    | 25 MARCH 2019 |
|                 |               |
|                 |               |
|                 |               |
|                 |               |
|                 |               |

Wildlight Masterplan-  
Overall Sign Location  
Plan - PHASE 1

These drawings are for the sole purpose of  
expressing visual design intent and are not  
intended for construction purposes. All aspects  
engineering, fabrication, installation, and any  
resulting documentation are the responsibility of  
the Fabricator.



Proposed Master  
Signage Plan



Wildlight  
PROJECT

Raydient  
OWNER

KK, CD, BJ, KK  
505DESIGN TEAM

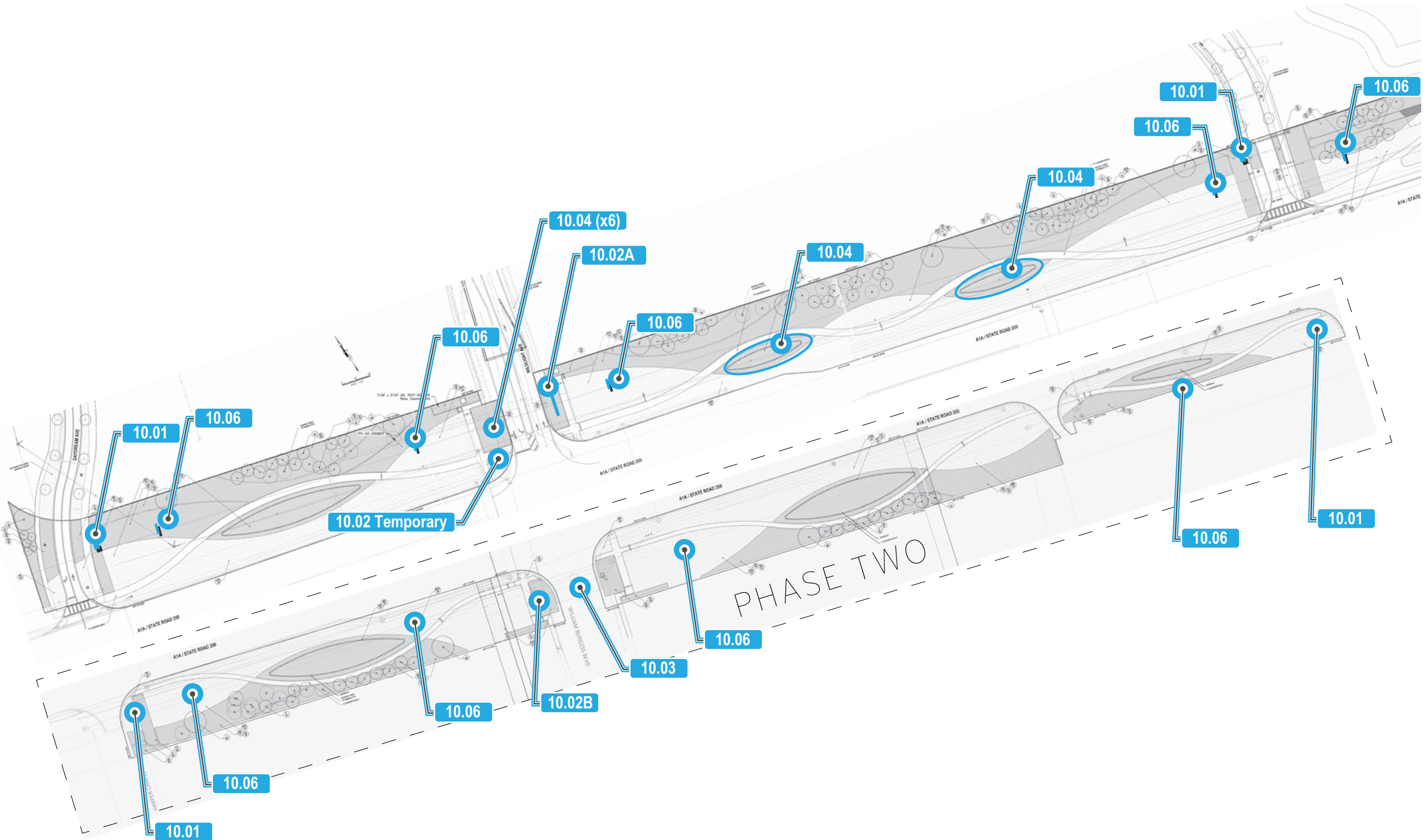

|                 |                |
|-----------------|----------------|
| ORIGINAL ISSUE: | 30 AUG 2017    |
| REVISIONS:      | 1 13 SEPT 2018 |
|                 |                |
|                 |                |
|                 |                |
|                 |                |
|                 |                |

Wildlight Highway A1A  
Entry - Overall Sign  
Location Plan -  
PHASE 1

These drawings are for the sole purpose of  
expressing visual design intent and are not  
intended for construction purposes. All aspects  
engineering, fabrication, installation, and any  
resulting documentation are the responsibility of  
the Fabricator.







## **SIGN TYPE 10.01**

Project Entry Tower along A1A

QTY: 2 (1 Phase One, 1 Phase Two)



Proposed Master  
Signage Plan



Wildlight  
PROJECT

Raydient  
OWNER

KK, CD, BJ, KK  
505DESIGN TEAM

|                 |                |
|-----------------|----------------|
| ORIGINAL ISSUE: | 10 JULY 2017   |
| REVISIONS:      | 1 13 SEPT 2018 |
|                 |                |
|                 |                |
|                 |                |
|                 |                |
|                 |                |
|                 |                |

Sign Type 10.01  
Project Entry Tower  
along A1A

These drawings are for the sole purpose of  
expressing visual design intent and are not  
intended for construction purposes. All aspects  
engineering, fabrication, installation, and any  
resulting documentation are the responsibility of  
the Fabricator.

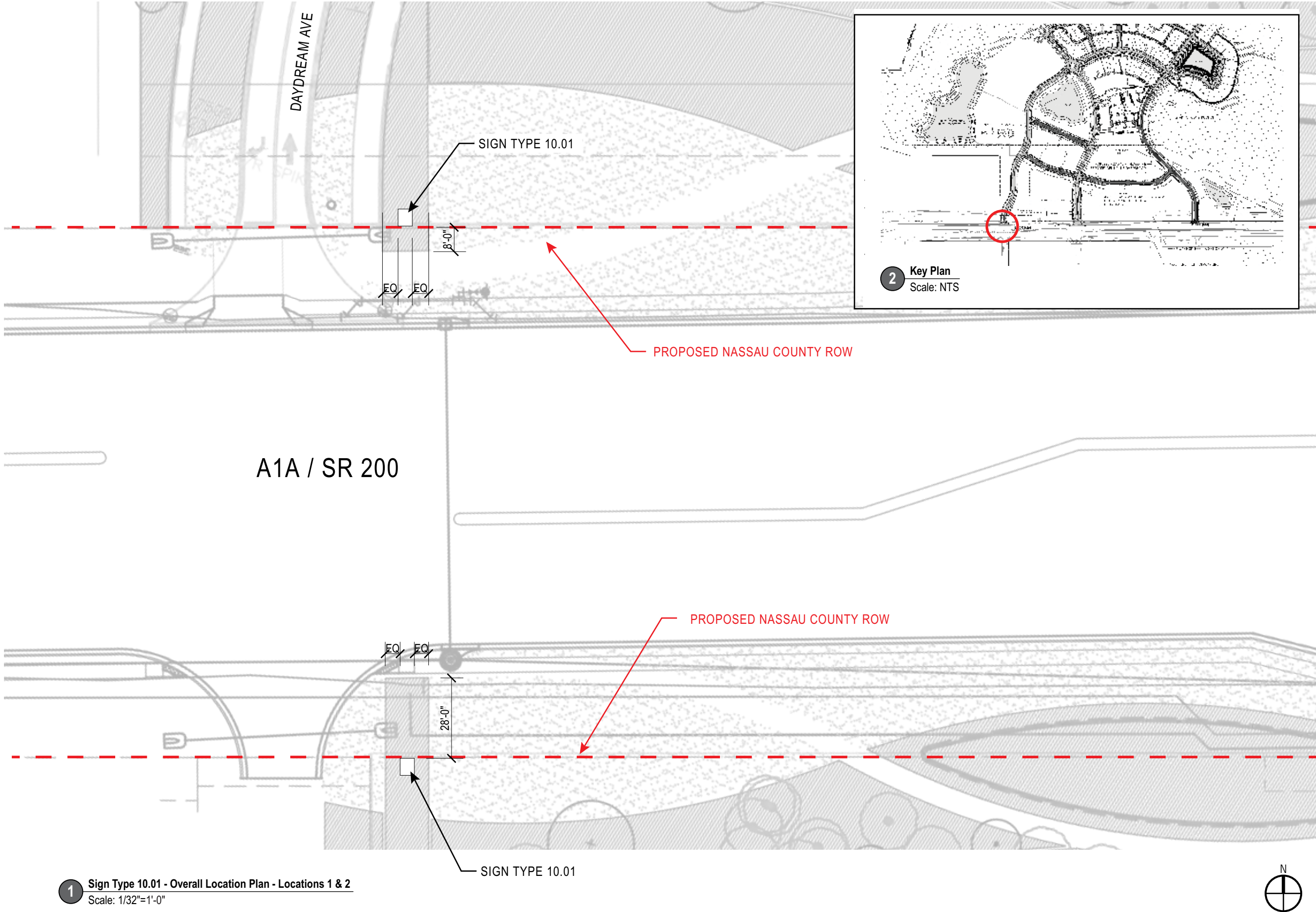



Proposed Master  
Signage Plan



Wildlight  
PROJECT

Raydient  
OWNER

KK, CD, BJ, KK  
505DESIGN TEAM

|                 |                |
|-----------------|----------------|
| ORIGINAL ISSUE: | 30 AUG 2017    |
| REVISIONS:      | 1 13 SEPT 2018 |
|                 |                |
|                 |                |
|                 |                |
|                 |                |
|                 |                |

Sign Type 10.01  
Project Entry Tower  
along A1A

These drawings are for the sole purpose of  
expressing visual design intent and are not  
intended for construction purposes. All aspects  
engineering, fabrication, installation, and any  
resulting documentation are the responsibility of  
the Fabricator.

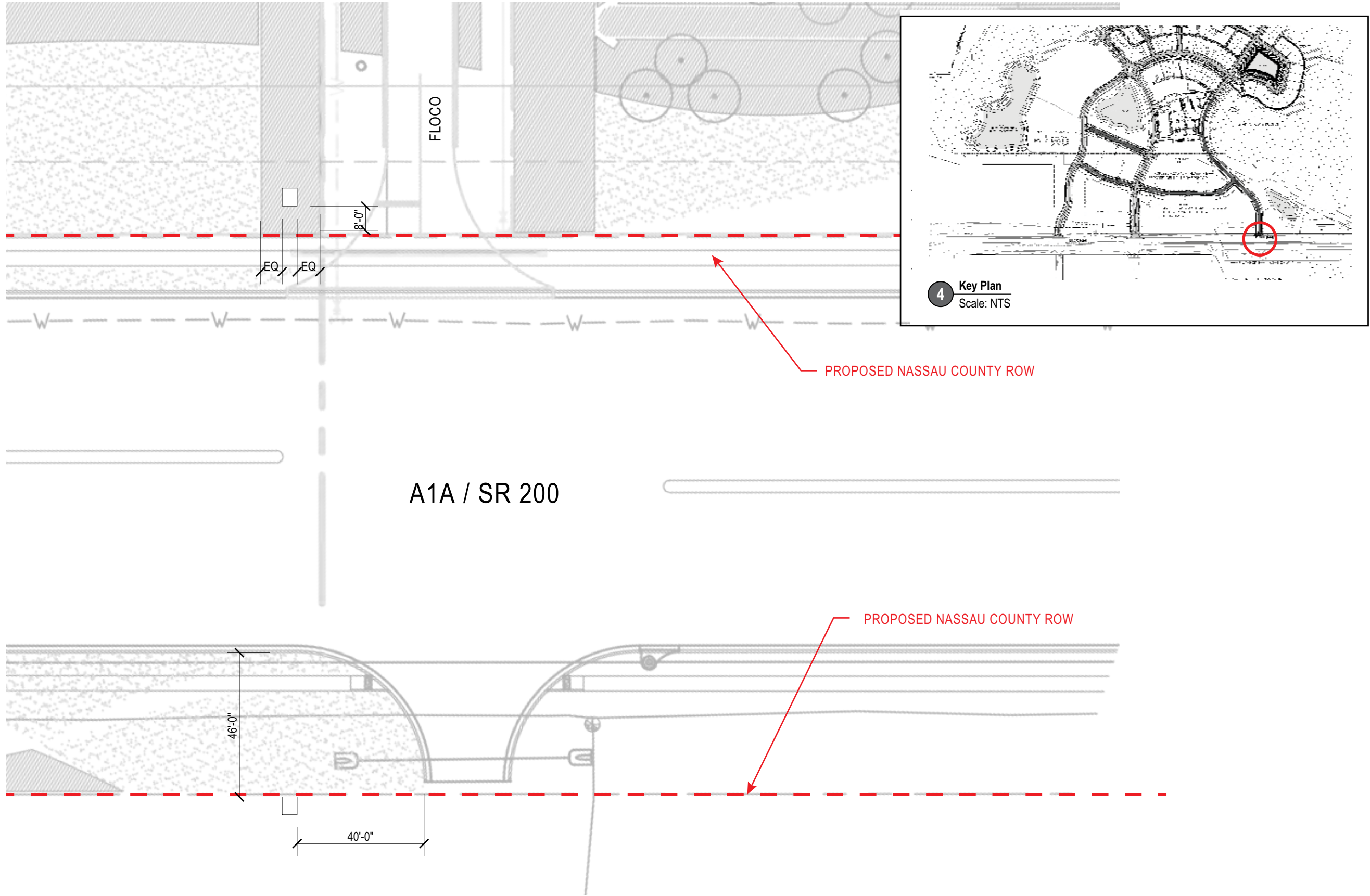

3 Sign Type 10.01 - Overall Location Plan - Locations 3&4  
Scale: 1/32"=1'-0"

4 Key Plan  
Scale: NTS





**1** Perspective View  
Scale: NTS



**2** Perspective View - Illumination  
Scale: NTS

**Proposed Master  
Signage Plan**



**Wildlight**  
PROJECT

**Raydient**  
OWNER

**KK, CD, BJ, KK**  
505DESIGN TEAM

|                 |                       |
|-----------------|-----------------------|
| ORIGINAL ISSUE: | <b>30 AUG 2017</b>    |
| REVISIONS:      | <b>1 13 SEPT 2018</b> |
|                 |                       |
|                 |                       |
|                 |                       |
|                 |                       |
|                 |                       |
|                 |                       |

**Sign Type 10.01 -  
Project Entry Tower  
along A1A**

These drawings are for the sole purpose of expressing visual design intent and are not intended for construction purposes. All aspects engineering, fabrication, installation, and any resulting documentation are the responsibility of the Fabricator.



Proposed Master  
Signage Plan



Wildlight  
PROJECT

Raydient  
OWNER

KK, CD, BJ, KK  
505DESIGN TEAM

|                 |                |
|-----------------|----------------|
| ORIGINAL ISSUE: | 30 AUG 2017    |
| REVISIONS:      | 1 13 SEPT 2018 |
|                 |                |
|                 |                |
|                 |                |
|                 |                |
|                 |                |
|                 |                |

Sign Type 10.01 -  
Project Entry Tower  
along A1A

These drawings are for the sole purpose of  
expressing visual design intent and are not  
intended for construction purposes. All aspects  
engineering, fabrication, installation, and any  
resulting documentation are the responsibility of  
the Fabricator.

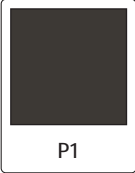

AkzoNobel Paints  
#492F5 Satin Finish  
PMS  
Pantone Black 7C



AkzoNobel Paints  
#500C2 Satin Finish  
PMS  
Pantone Cool Gray 9C

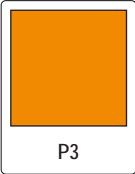

AkzoNobel Paints  
#417A6 Satin Finish  
PMS  
Pantone 144C  
Sherwin Williams  
Carnival - SW6892

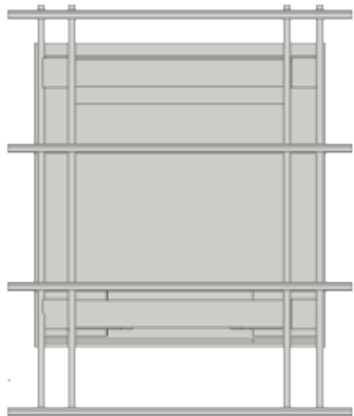

1 Plan View - Without Roof  
Scale: 3/8" = 1'

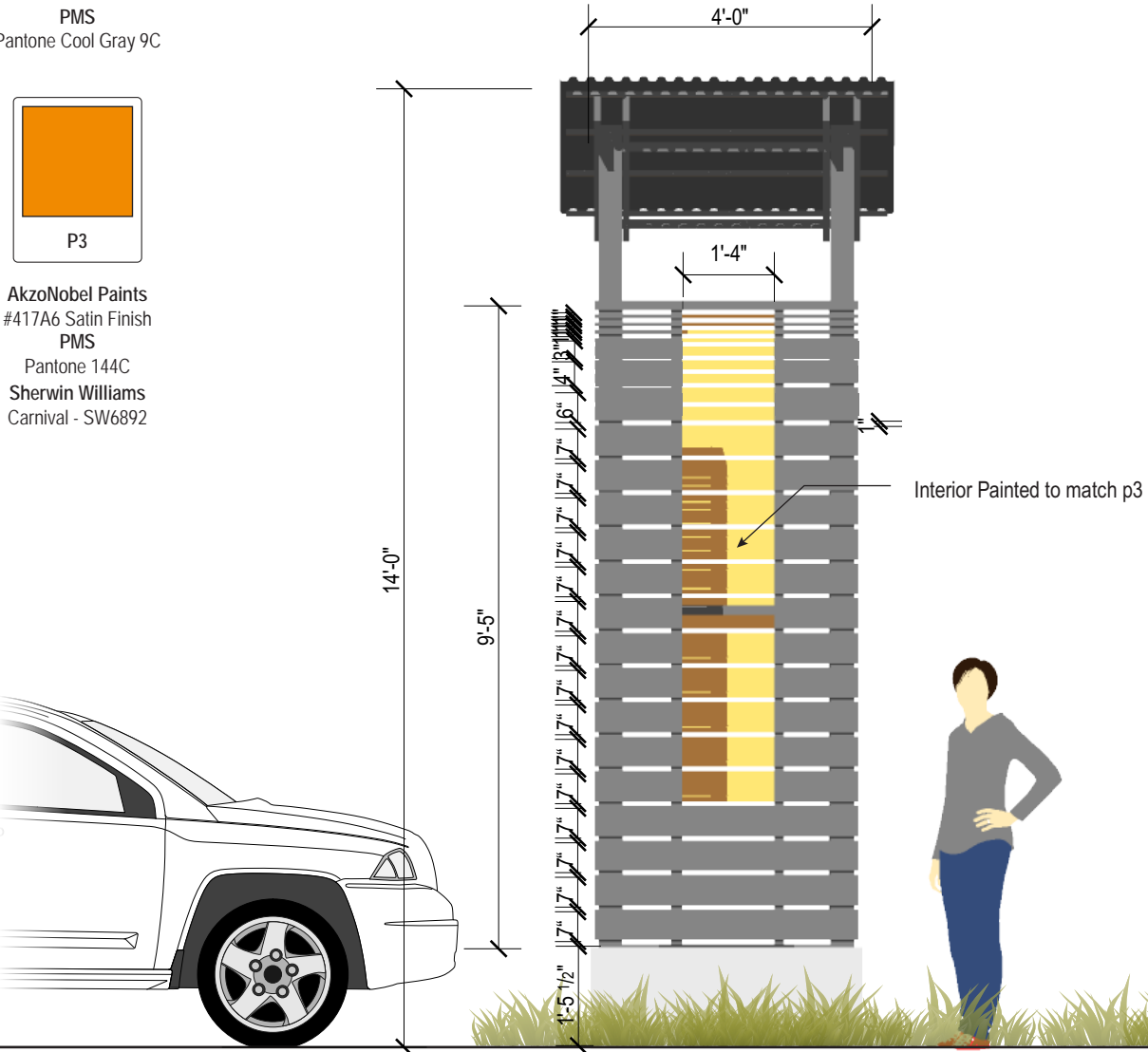

2 Front Elevation  
Scale: 3/8" = 1'

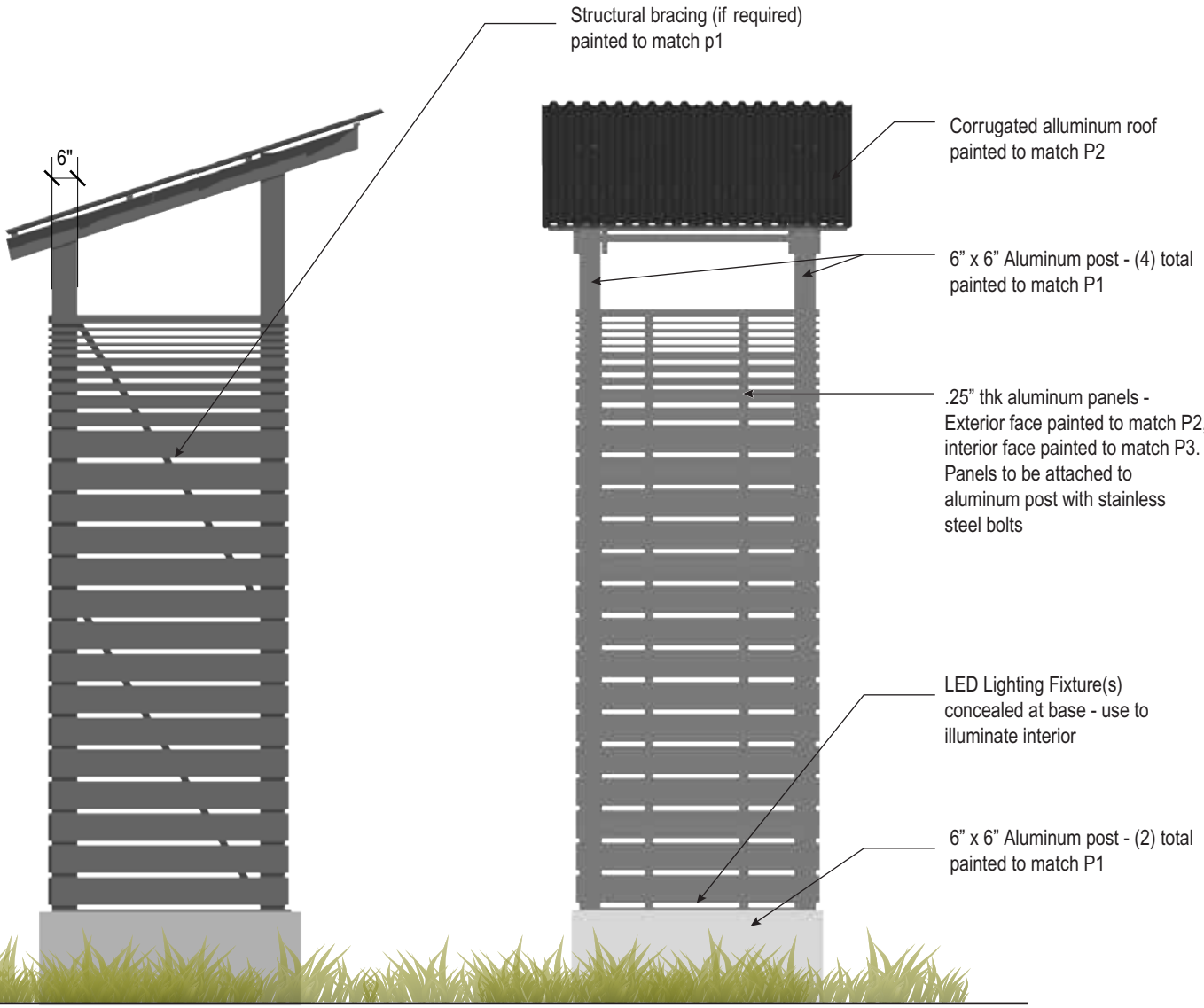

3 Side Elevation  
Scale: 3/8" = 1'

4 Rear Elevation  
Scale: 3/8" = 1'

## **SIGN TYPE 10.02 (TEMPORARY)**

Identification Sign to be in Place During  
Hywy A1A Construction

QTY: 2



Proposed Master  
Signage Plan



Wildlight  
PROJECT

Raydient  
OWNER

KK, CD, BJ, KK  
505 DESIGN TEAM



Temporary Entry Signage Concept - Perspective View

|                 |  |             |
|-----------------|--|-------------|
| ORIGINAL ISSUE: |  | 30 AUG 2017 |
| REVISIONS:      |  |             |
|                 |  |             |
|                 |  |             |
|                 |  |             |
|                 |  |             |
|                 |  |             |
|                 |  |             |

Sign Type 10.02  
(TEMPORARY) -  
ID Sign during Hywy  
A1A Construction

These drawings are for the sole purpose of  
expressing visual design intent and are not  
intended for construction purposes. All aspects  
engineering, fabrication, installation, and any  
resulting documentation are the responsibility of  
the Fabricator.

Proposed Master  
Signage Plan



**Wildlight**  
PROJECT

**Raydient**  
OWNER

**KK, CD, BJ, KK**  
505DESIGN TEAM

|                                |  |
|--------------------------------|--|
| ORIGINAL ISSUE: 03 AUGUST 2017 |  |
| REVISIONS:                     |  |
|                                |  |
|                                |  |
|                                |  |
|                                |  |
|                                |  |
|                                |  |

**Sign Type 10.02**  
**(TEMPORARY) -**  
**ID Sign during Hwy**  
**A1A Construction**

These drawings are for the sole purpose of  
expressing visual design intent and are not  
intended for construction purposes. All aspects  
engineering, fabrication, installation, and any  
resulting documentation are the responsibility of  
the Fabricator.

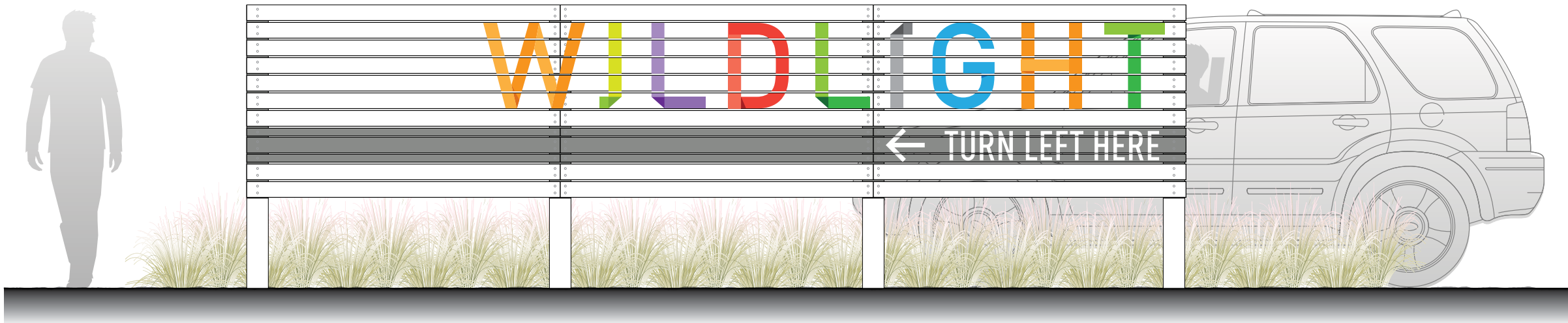

**1** Sign Type 10.02 Temporary - Elevation (Side A)  
Scale: 3/8"=1'-0"

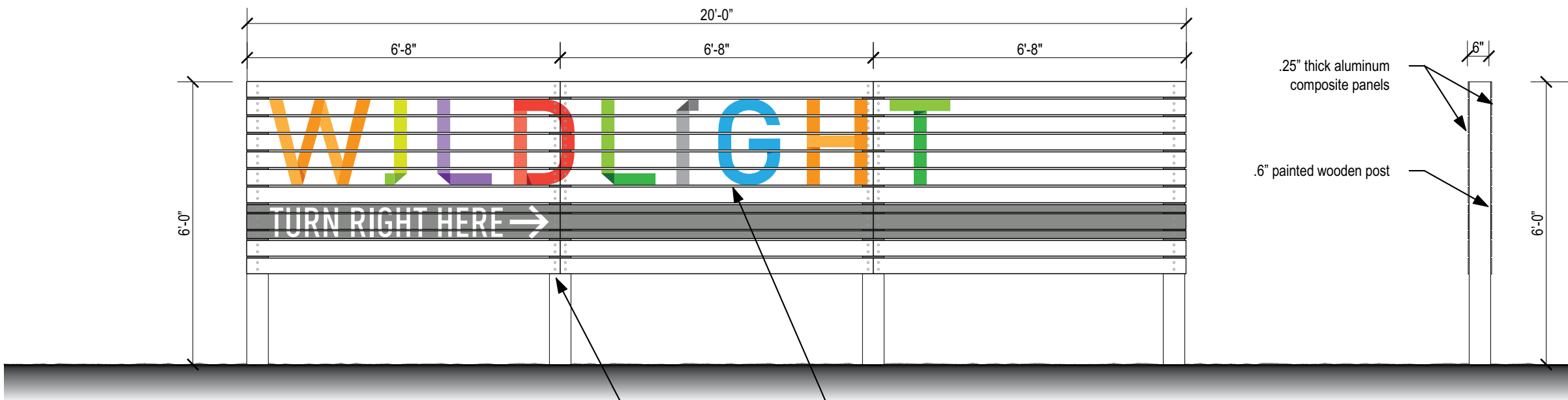

**2** Sign Type 10.02 Temporary - Elevation (Side B)  
Scale: 3/8"=1'-0"

6" painted wooden post      .25" thick painted aluminum composite panels with  
painted "Wildlight" logo. Panels to be attached  
to wooden posts with counter-sunk screws.  
Panels to be applied on both sides of posts - sign to be double-sided

**3** Side Elevation  
Scale: 3/8"=1'-0"



**SIGN TYPE 10.02A (PERMANENT)**

Project Identification Sign w/ Tenant Listing at  
Village Entry, Hywy A1A Northside

QTY: 1

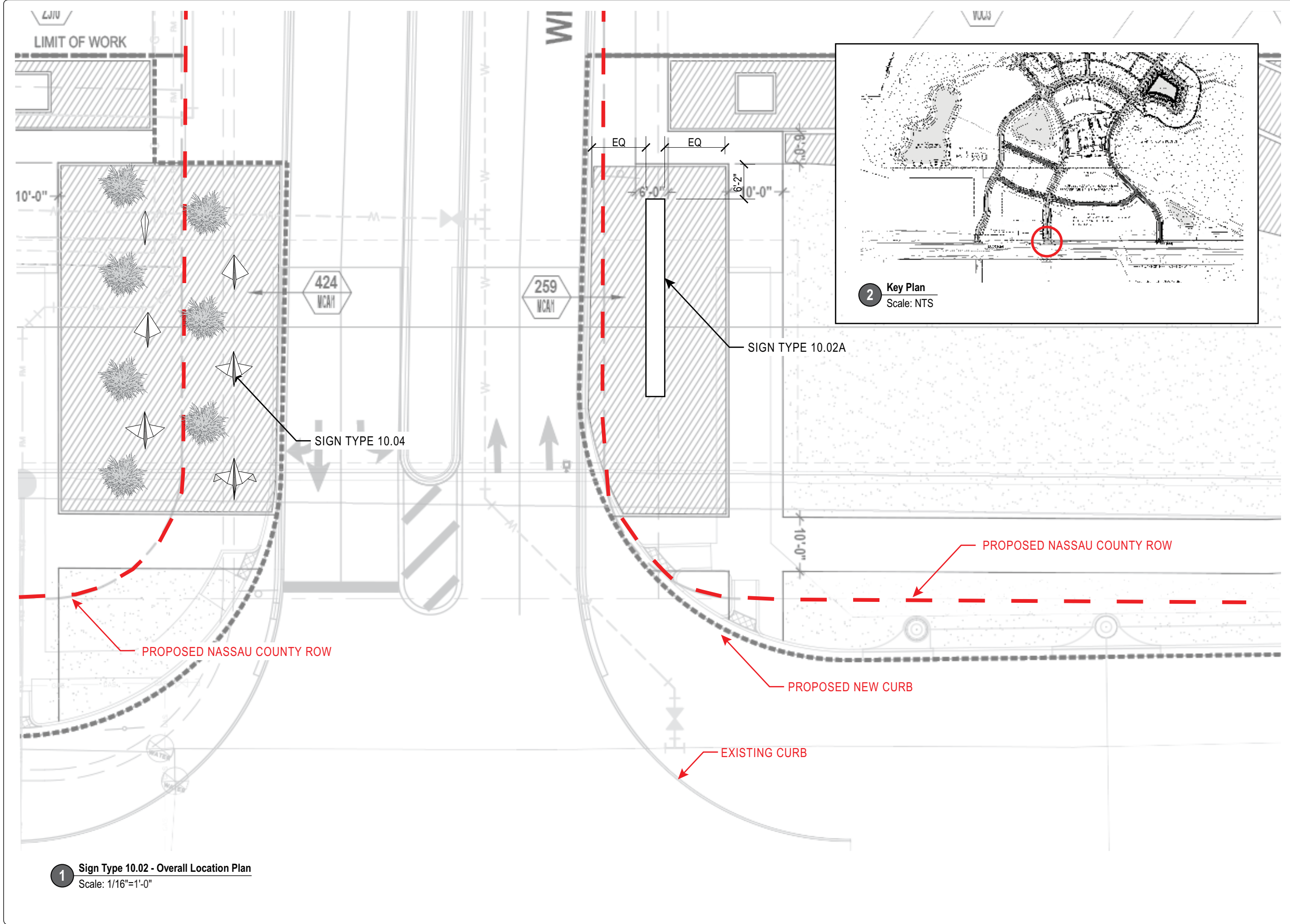

Proposed Master  
Signage Plan



Wildlight  
PROJECT

Raydient  
OWNER

KK, CD, BJ, KK  
505DESIGN TEAM

|                 |                |
|-----------------|----------------|
| ORIGINAL ISSUE: | 10 JULY 2017   |
| REVISIONS:      | 1 13 SEPT 2018 |
|                 |                |
|                 |                |
|                 |                |
|                 |                |
|                 |                |

Sign Type 10.02A  
Project ID Sign with  
Tenant Listing at  
Village Entry  
(Hwy A1A Northside)

These drawings are for the sole purpose of  
expressing visual design intent and are not  
intended for construction purposes. All aspects  
engineering, fabrication, installation, and any  
resulting documentation are the responsibility of  
the Fabricator.





Large Project Identification Sign with Tenant Listing at Village Entry along Hwy A1A - Updated

Proposed Master  
Signage Plan



Wildlight  
PROJECT

Raydient  
OWNER

KK, CD, BJ, KK  
505DESIGN TEAM

|                 |                |
|-----------------|----------------|
| ORIGINAL ISSUE: | 30 AUG 2017    |
| REVISIONS:      | 1 13 SEPT 2018 |
|                 |                |
|                 |                |
|                 |                |
|                 |                |
|                 |                |
|                 |                |

Sign Type 10.02A -  
Project ID Sign with  
Tenant Listing at  
Village Entry  
(Hwy A1A Northside)

These drawings are for the sole purpose of  
expressing visual design intent and are not  
intended for construction purposes. All aspects  
engineering, fabrication, installation, and any  
resulting documentation are the responsibility of  
the Fabricator.