



595 DESIGN

CHARLOTTE:
508 West Fifth St., 250 t 704 348 7000
Charlotte, NC 28202 f 704 348 7005

WILDLIGHT

PROPOSED SIGNAGE MASTER PLAN

Wildlight Phase 1 - East Nassau, Florida



CLIENT:
Raydient
1901 Island Walkway
Fernandina Beach, FL 32034

t (904) 321-1023
(c) (904) 568-2359
Greg Jones

ORIGINAL ISSUE: 30 AUG 2017

REVISIONS: 1 13 SEPT 2018

2 25 MARCH 2019

3 28 MARCH 2019

4 08 OCT 2019

5 10 OCT 2019

6 22 OCT 2019

PROJECT ENVIRONMENTAL GRAPHICS PHASE 1 - SCOPE OF WORK		
Sign Type #	Qty	Sign Name/Description
Overall Project Site Sign Items		
10.01	4	Project Entry Tower along A1A
10.02 (Temp)	2	Temporary Identification Sign to be in Place During Hywy A1A Construction
10.02A (Perm)	1	Permanent Project Identification Sign with Tenant Listing at Village Entry, Hywy A1A Northside
10.02B (Perm)	1	Permanent Project Identification Sign, Hywy A1A Southside
10.03	1	Large Project ID Sign with Tenant Listing
10.04	20	Landscape Sculptural Bird(s) - (20 - Phase 1 & 10 - Phase 2 . Total quantity at build out = 30)
10.06	10	Outparcel Ground Mounted Identification Sign - along Hywy A1A (9' TALL)
10.06.01	TBD	Outparcel Ground Mounted Identification Sign - (6' TALL) *
10.06.02	2	Outparcel Ground Mounted Identificaiton Sign (Multi-Family) - (6' TALL)
10.07	1	Wildlight Village Entry Gateway Portal - to hold a temporary banner spanning street
10.09	TBD	Main Site Vehicular Directional Sign
10.10	TBD	Tenant Directional
10.11	TBD	Project Street Sign
10.12	TBD	Vehicular Traffic (D.O.T.) Post & Panel Sign(s)
10.13	TBD	Secondary Wayfinding Sign
Temporary Residential Sales Sign Items		
20.01	1	Sales Center Identification
20.03	TBD	Model Home Identity Sign
20.04	TBD	Builder Lot Sign
* (1) Sign Type 10.06.01 - Limited to one sign per commercial parcel		
GENERAL NOTES:		
Building Signage is subject to review according to Nassau County Land Development Code Article 35-SR2--/A1A - Access Management Overlay District signage standards		
All signage shall be subject to review and approval of Wildlight Design Review Commitee		
All signage subject to permit requirements set forth by Nassau County		

Proposed Master
Signage Plan



Wildlight
PROJECT

Raydient
OWNER

KK, CD, BJ, KK
505DESIGN TEAM

ORIGINAL ISSUE:		30 AUG 2017
REVISIONS:		

Package Index

These drawings are for the sole purpose of expressing visual design intent and are not intended for construction purposes. All aspects engineering, fabrication, installation, and any resulting documentation are the responsibility of the Fabricator.

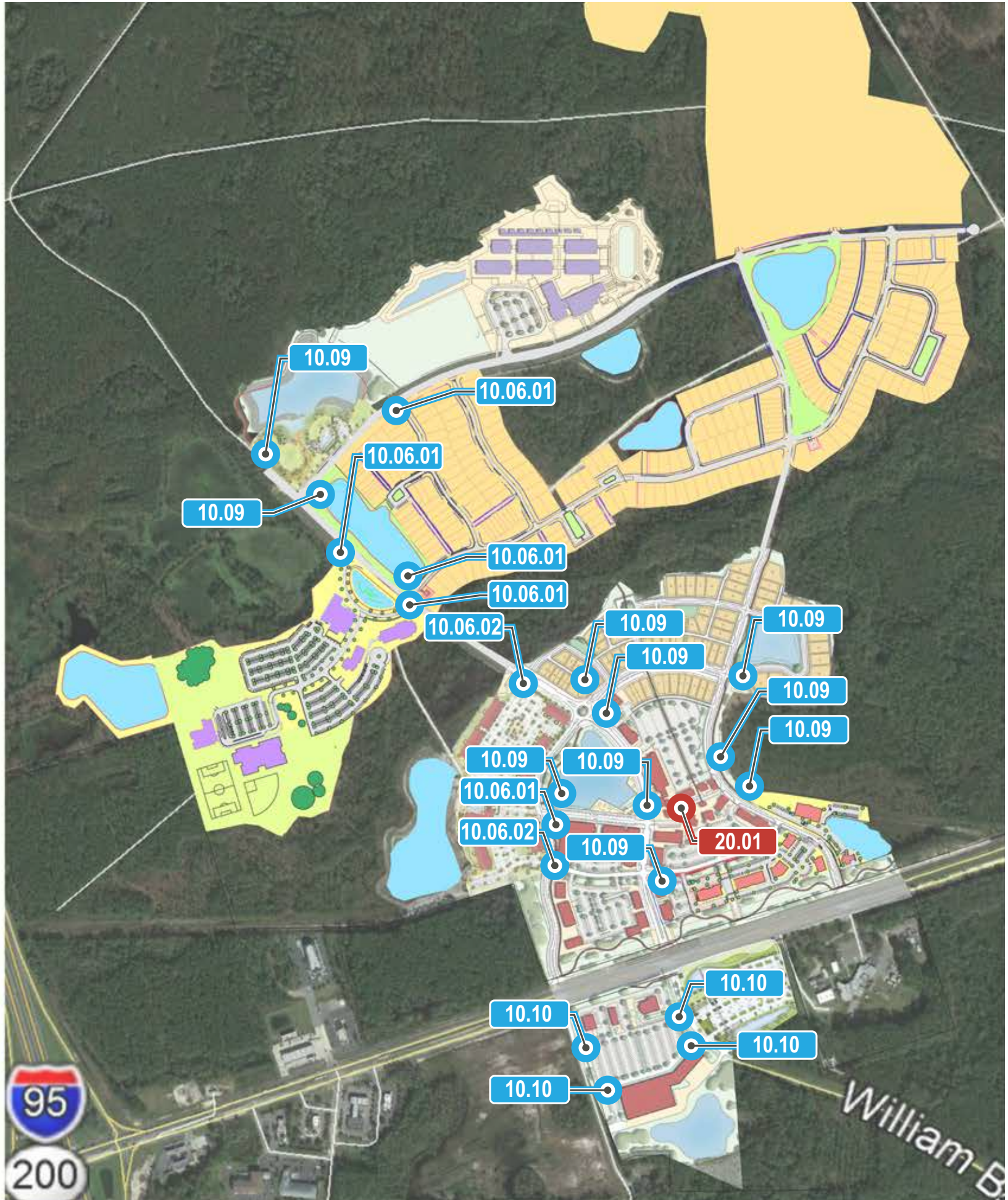

Proposed Master
Signage Plan



Wildlight
PROJECT

Raydient
OWNER

KK, CD, BJ, KK
505DESIGN TEAM

ORIGINAL ISSUE:	30 AUG 2017
REVISIONS:	

Wildlight Masterplan-
Overall Sign Location
Plan - PHASE 1

These drawings are for the sole purpose of
expressing visual design intent and are not
intended for construction purposes. All aspects
engineering, fabrication, installation, and any
resulting documentation are the responsibility of
the Fabricator.

Proposed Master
Signage Plan



Wildlight
PROJECT

Raydient
OWNER

KK, CD, BJ, KK
505DESIGN TEAM

ORIGINAL ISSUE:	30 AUG 2017
REVISIONS:	

Wildlight Highway A1A
Entry - Overall Sign
Location Plan -
PHASE 1

These drawings are for the sole purpose of
expressing visual design intent and are not
intended for construction purposes. All aspects
engineering, fabrication, installation, and any
resulting documentation are the responsibility of
the Fabricator.

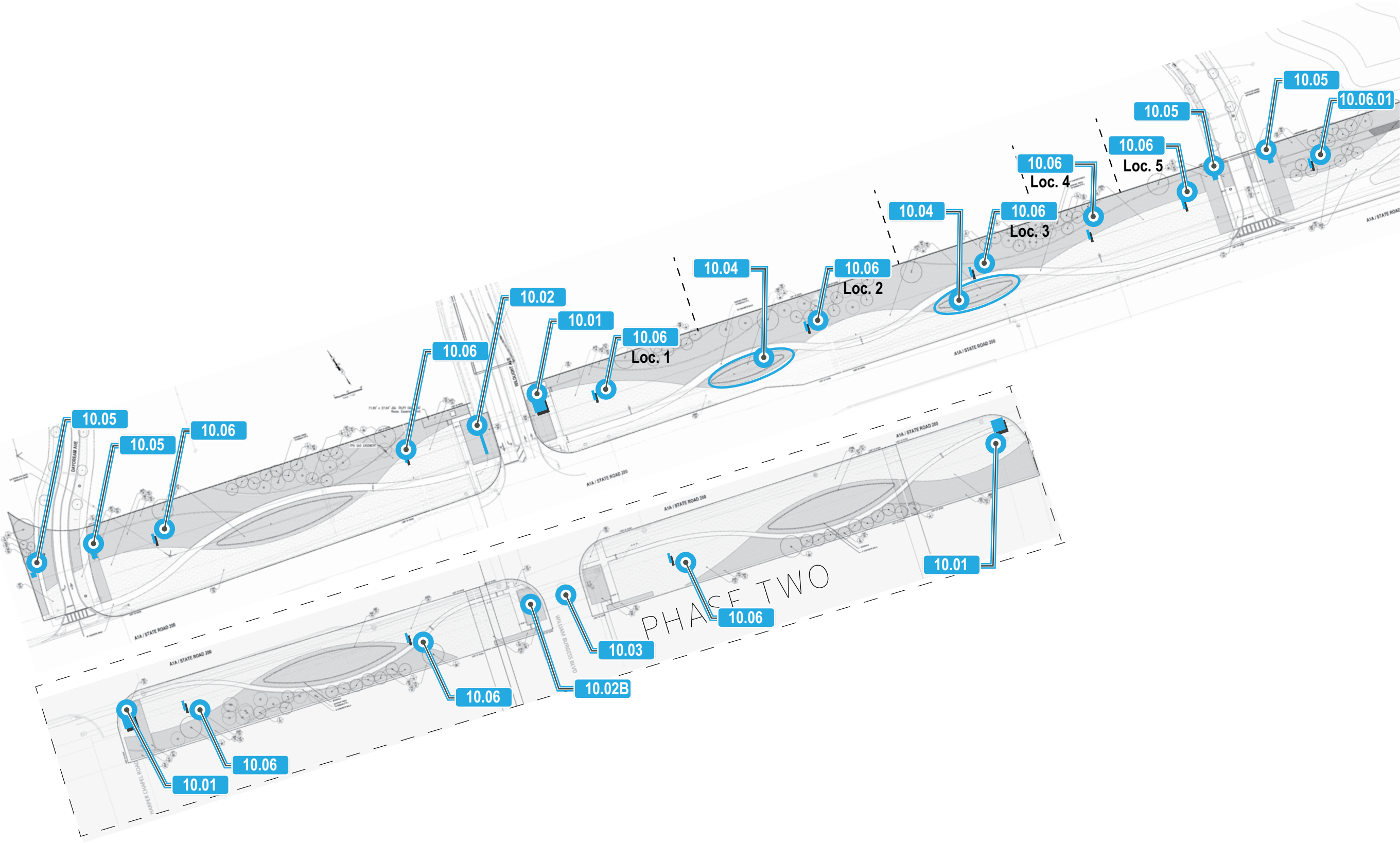

Overall Project Site Sign Items



SIGN TYPE 10.01

Project Entry Tower along A1A

QTY: 2 (1 Phase One, 1 Phase Two)

Proposed Master
Signage Plan



Wildlight
PROJECT

Raydient
OWNER

KK, CD, BJ, KK
505DESIGN TEAM

ORIGINAL ISSUE: 10 JULY 2017	
REVISIONS:	

Sign Type 10.01
Project Entry Tower
along A1A

These drawings are for the sole purpose of
expressing visual design intent and are not
intended for construction purposes. All aspects
engineering, fabrication, installation, and any
resulting documentation are the responsibility of
the Fabricator.

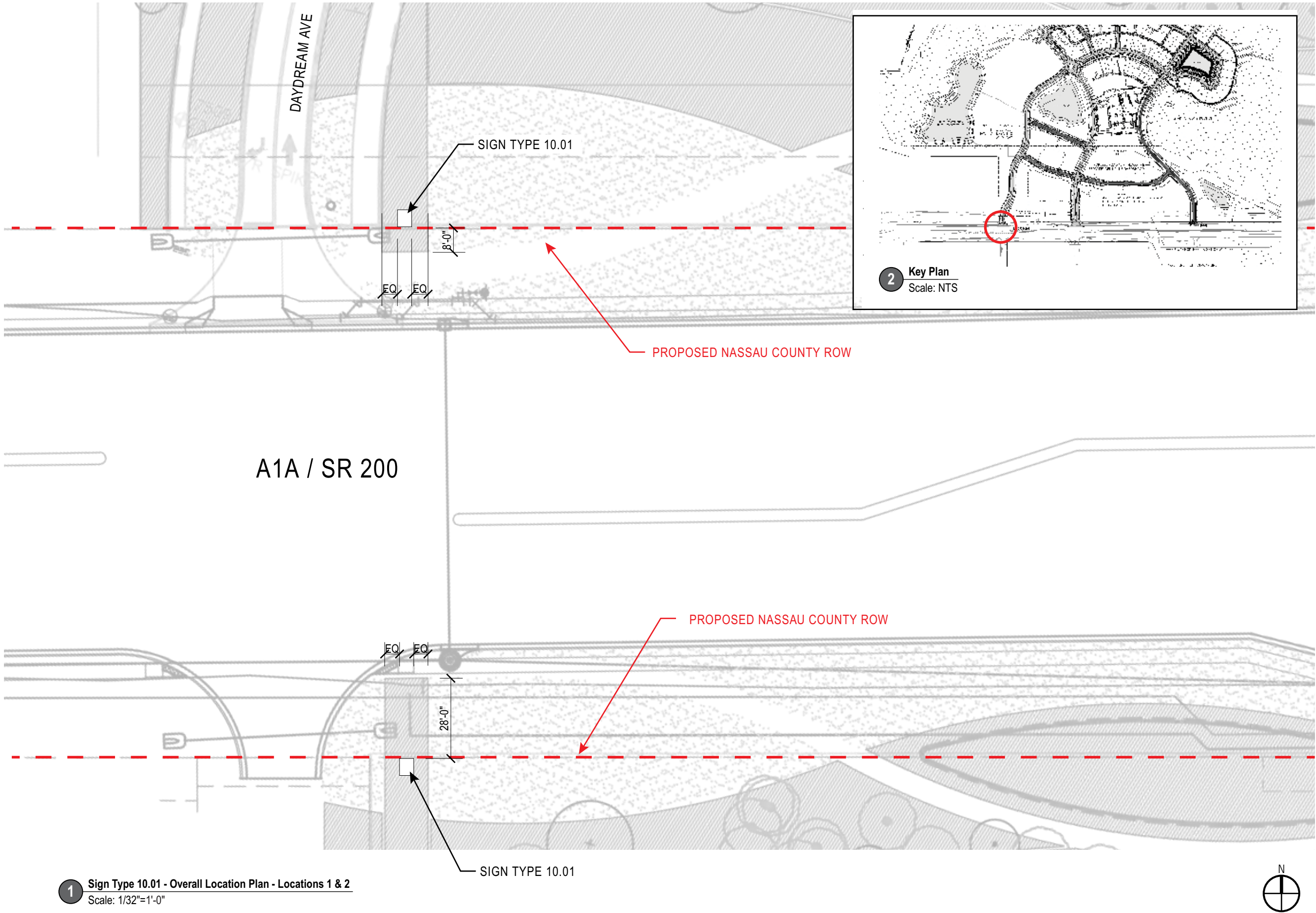

Proposed Master
Signage Plan



Wildlight
PROJECT

Raydient
OWNER

KK, CD, BJ, KK
505DESIGN TEAM

ORIGINAL ISSUE:	30 AUG 2017
REVISIONS:	

Sign Type 10.01
Project Entry Tower
along A1A

These drawings are for the sole purpose of
expressing visual design intent and are not
intended for construction purposes. All aspects
engineering, fabrication, installation, and any
resulting documentation are the responsibility of
the Fabricator.

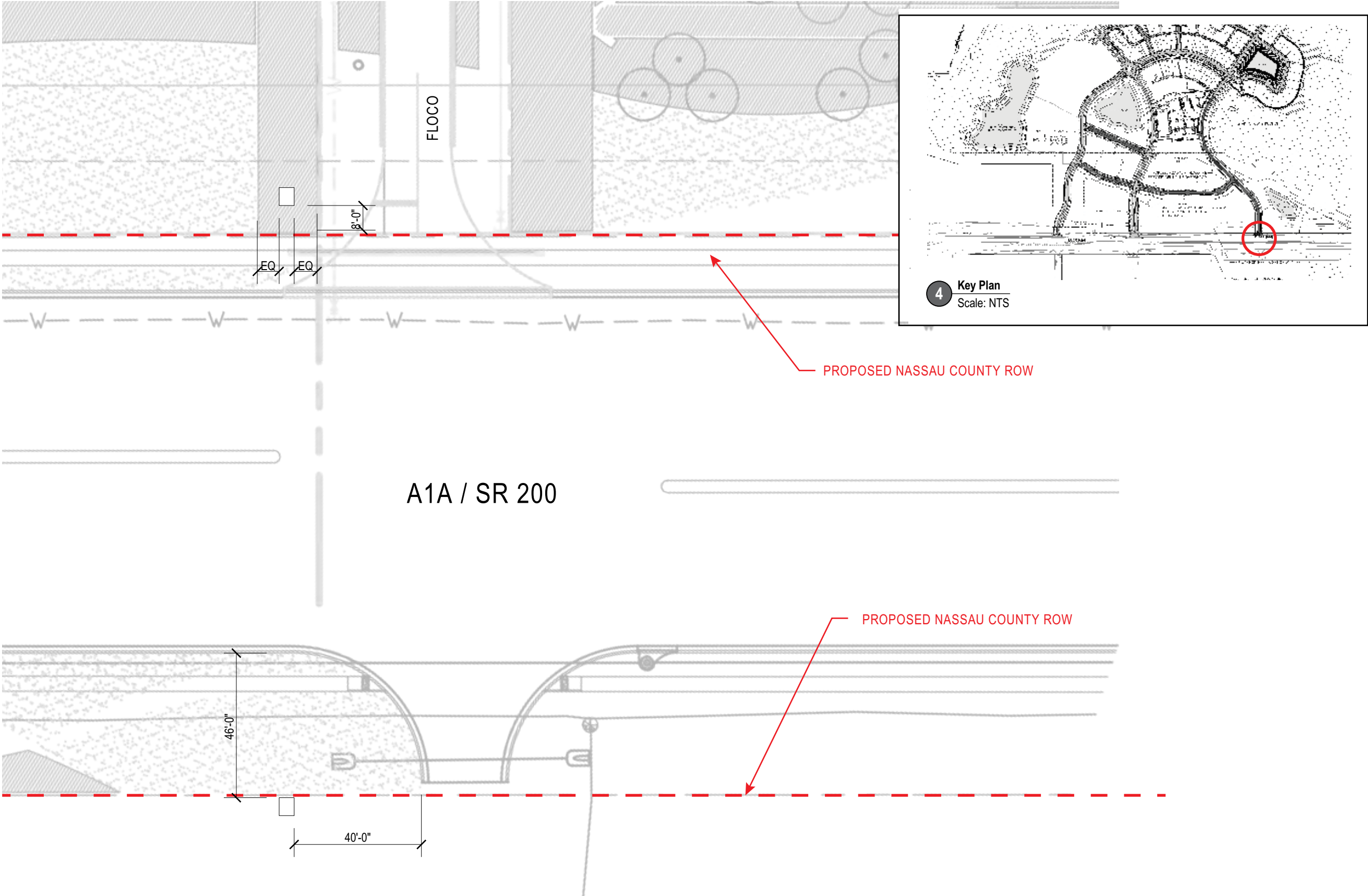



1 Perspective View
Scale: NTS



2 Perspective View - Illumination
Scale: NTS

Proposed Master
Signage Plan



Wildlight
PROJECT

Raydient
OWNER

KK, CD, BJ, KK
505 DESIGN TEAM

ORIGINAL ISSUE:	30 AUG 2017
REVISIONS:	

Sign Type 10.01 -
Project Entry Tower
along A1A

These drawings are for the sole purpose of
expressing visual design intent and are not
intended for construction purposes. All aspects
engineering, fabrication, installation, and any
resulting documentation are the responsibility of
the Fabricator.

Proposed Master
Signage Plan



Wildlight
PROJECT

Raydient
OWNER

KK, CD, BJ, KK
505DESIGN TEAM

ORIGINAL ISSUE: 30 AUG 2017	
REVISIONS:	

Sign Type 10.01 -
Project Entry Tower
along A1A

These drawings are for the sole purpose of
expressing visual design intent and are not
intended for construction purposes. All aspects
engineering, fabrication, installation, and any
resulting documentation are the responsibility of
the Fabricator.



AkzoNobel Paints
#492F5 Satin Finish
PMS
Pantone Black 7C

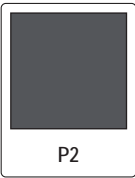

AkzoNobel Paints
#500C2 Satin Finish
PMS
Pantone Cool Gray 9C

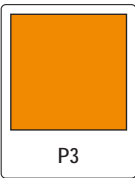

AkzoNobel Paints
#417A6 Satin Finish
PMS
Pantone 144C
Sherwin Williams
Carnival - SW6892

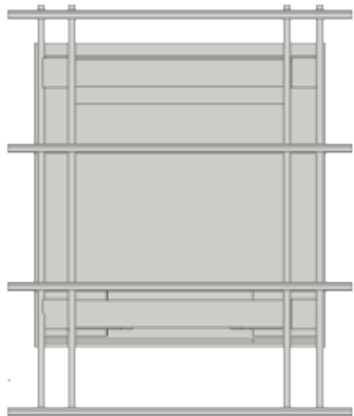

1 Plan View - Without Roof
Scale: 3/8" = 1'

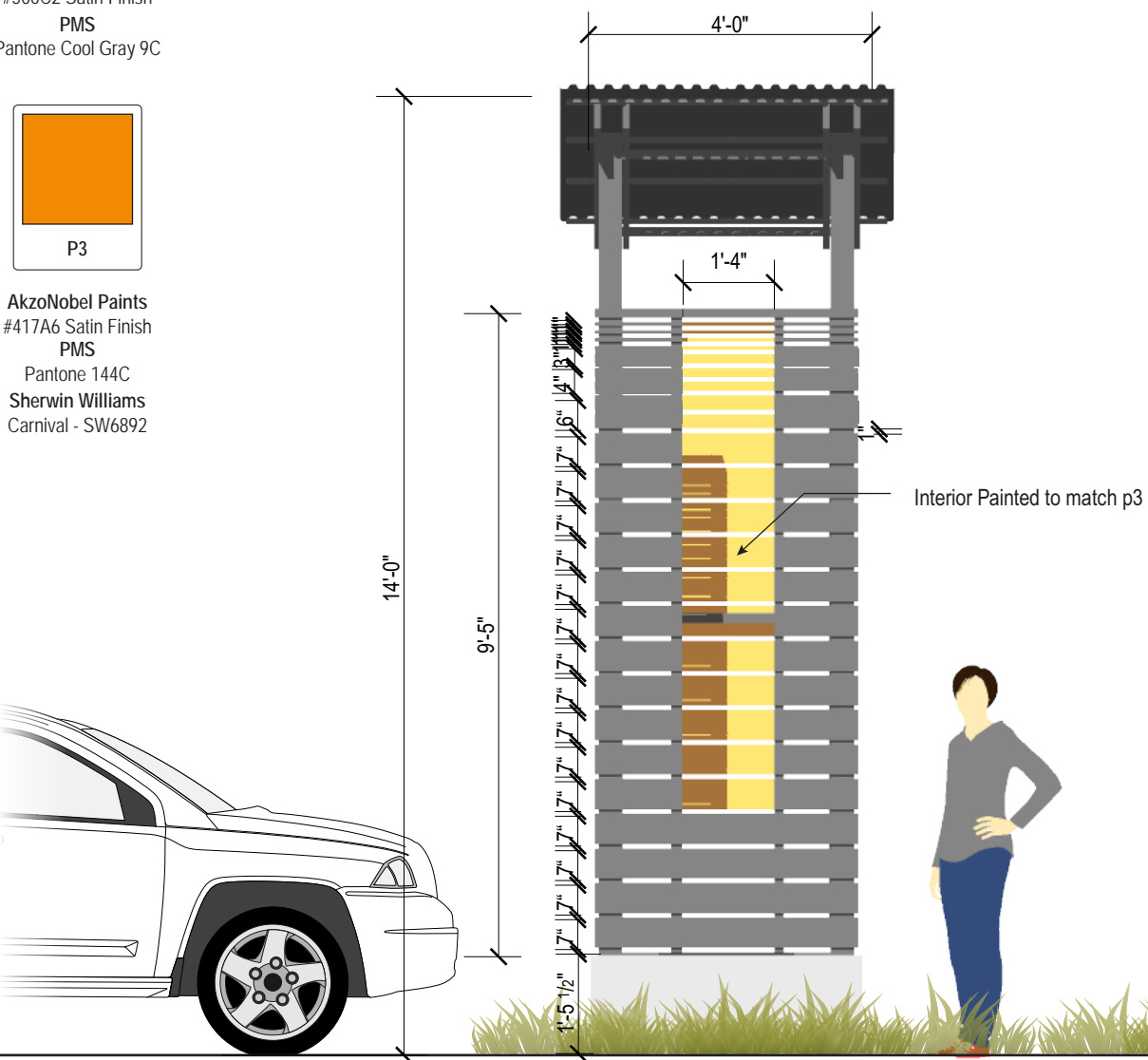

2 Front Elevation
Scale: 3/8" = 1'

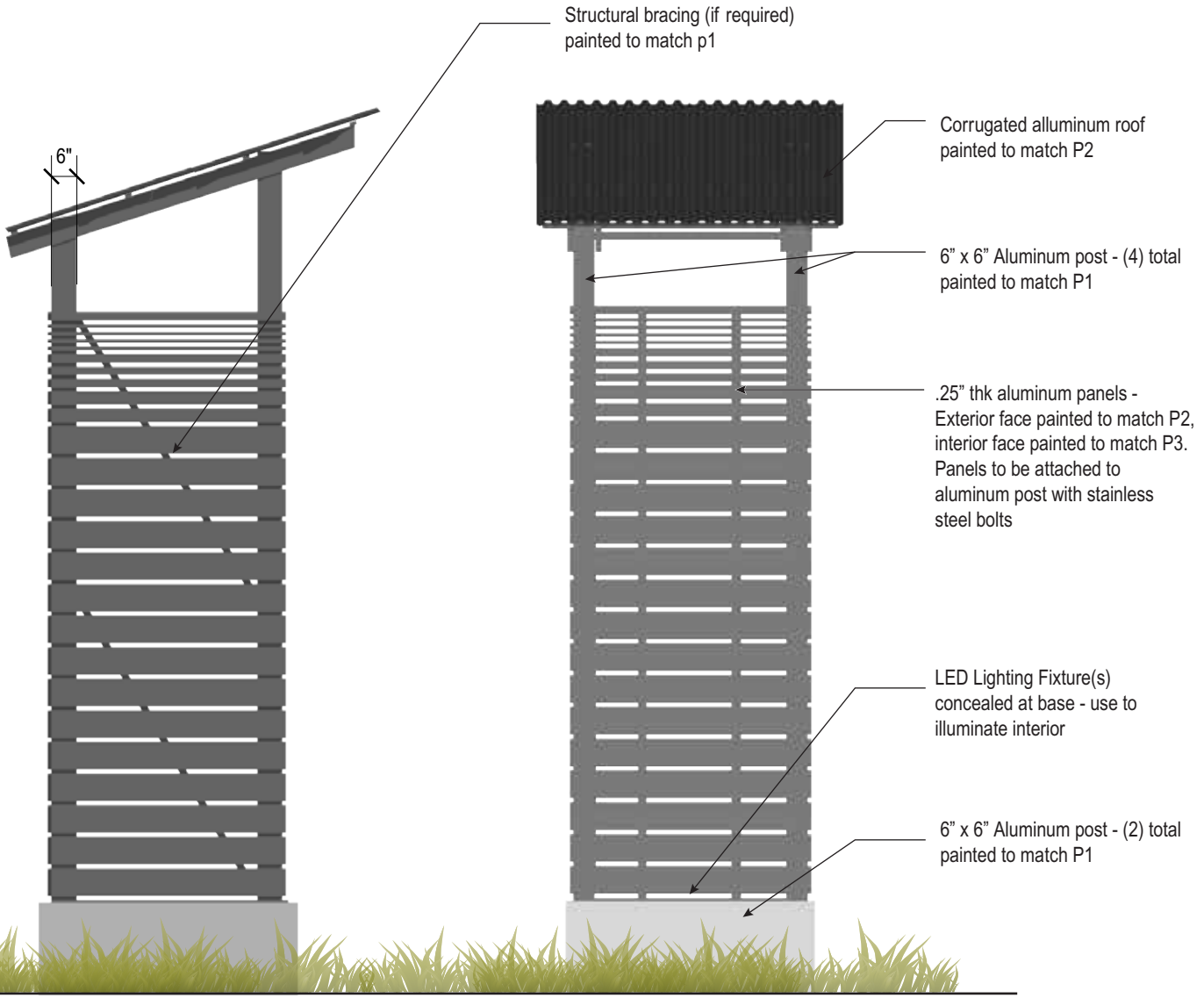

3 Side Elevation
Scale: 3/8" = 1'

4 Rear Elevation
Scale: 3/8" = 1'

SIGN TYPE 10.02 (TEMPORARY)

Identification Sign to be in Place During
Hywy A1A Construction

QTY: 2



Temporary Entry Signage Concept - Perspective View

Proposed Master
Signage Plan



Wildlight
PROJECT

Raydient
OWNER

KK, CD, BJ, KK
505 DESIGN TEAM

ORIGINAL ISSUE:		30 AUG 2017
REVISIONS:		

Sign Type 10.02
(TEMPORARY) -
ID Sign during Hywy
A1A Construction

These drawings are for the sole purpose of
expressing visual design intent and are not
intended for construction purposes. All aspects
engineering, fabrication, installation, and any
resulting documentation are the responsibility of
the Fabricator.

Proposed Master
Signage Plan



Wildlight
PROJECT

Raydient
OWNER

KK, CD, BJ, KK
505DESIGN TEAM

ORIGINAL ISSUE: 03 AUGUST 2017

REVISIONS:

Sign Type 10.02
(TEMPORARY) -
ID Sign during Hwy
A1A Construction

These drawings are for the sole purpose of
expressing visual design intent and are not
intended for construction purposes. All aspects
engineering, fabrication, installation, and any
resulting documentation are the responsibility of
the Fabricator.

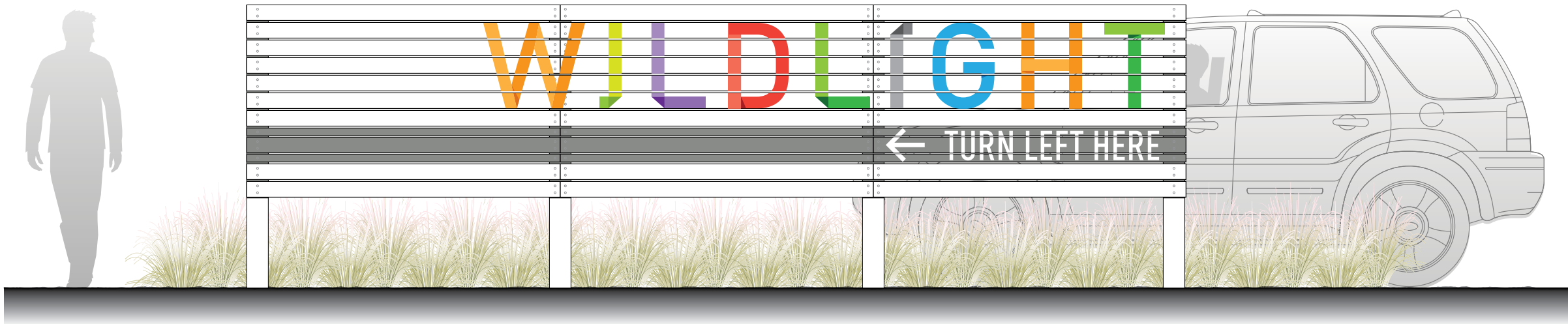

1 Sign Type 10.02 Temporary - Elevation (Side A)
Scale: 3/8"=1'-0"

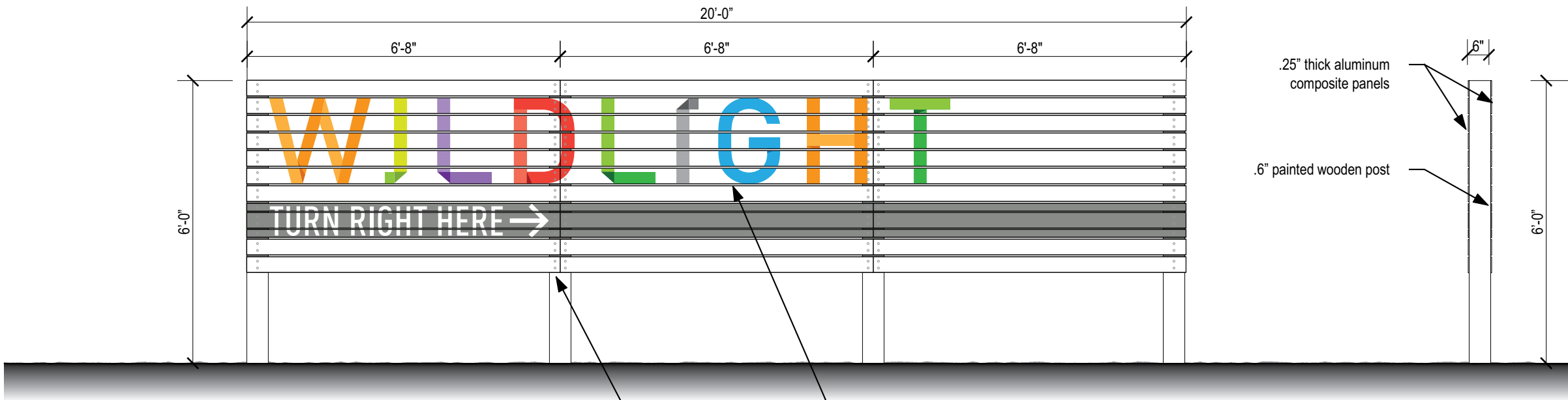

2 Sign Type 10.02 Temporary - Elevation (Side B)
Scale: 3/8"=1'-0"

6" painted wooden post

.25" thick painted aluminum composite panels with
painted "Wildlight" logo. Panels to be attached
to wooden posts with counter-sunk screws.
Panels to be applied on both sides of posts - sign to be double-sided

3 Side Elevation
Scale: 3/8"=1'-0"

SIGN TYPE 10.02A (PERMANENT)

Project Identification Sign w/ Tenant Listing at
Village Entry, Hywy A1A Northside

QTY: 1

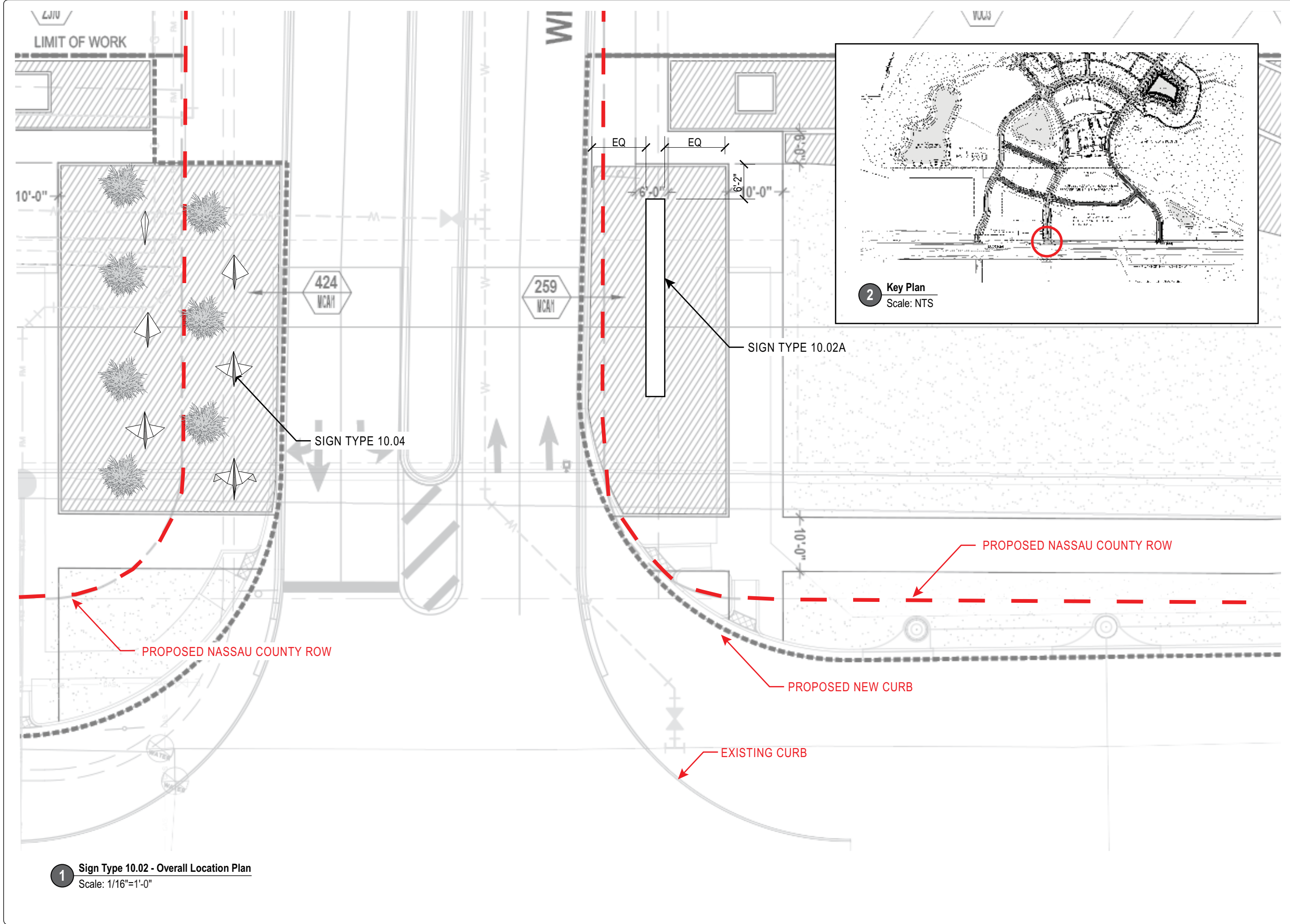

1 Sign Type 10.02 - Overall Location Plan
Scale: 1/16"=1'-0"

2 Key Plan
Scale: NTS

Proposed Master Signage Plan



Wildlight
PROJECT

Raydient
OWNER

KK, CD, BJ, KK
505DESIGN TEAM

ORIGINAL ISSUE: 10 JULY 2017	
REVISIONS:	

Sign Type 10.02A
Project ID Sign with
Tenant Listing at
Village Entry
(Hwy A1A Northside)

These drawings are for the sole purpose of expressing visual design intent and are not intended for construction purposes. All aspects engineering, fabrication, installation, and any resulting documentation are the responsibility of the Fabricator.