



Large Project Identification Sign with Tenant Listing at Village Entry along Hwy A1A - Updated

Proposed Master  
Signage Plan



Wildlight  
PROJECT

Raydient  
OWNER

KK, CD, BJ, KK  
505DESIGN TEAM

ORIGINAL ISSUE:	30 AUG 2017
REVISIONS:	

Sign Type 10.02A -  
Project ID Sign with  
Tenant Listing at  
Village Entry  
(Hwy A1A Northside)

These drawings are for the sole purpose of  
expressing visual design intent and are not  
intended for construction purposes. All aspects  
engineering, fabrication, installation, and any  
resulting documentation are the responsibility of  
the Fabricator.





**SIGN TYPE 10.02B (PERMANENT)**

Project Identification Sign w/ Tenant Listing at  
Village Entry, Hywy A1A Southside

QTY: 1

Proposed Master  
Signage Plan



Wildlight  
PROJECT

Raydient  
OWNER

KK, CD, BJ, KK  
505DESIGN TEAM

ORIGINAL ISSUE:		30 AUG 2017
REVISIONS:		

Package Index

These drawings are for the sole purpose of  
expressing visual design intent and are not  
intended for construction purposes. All aspects  
engineering, fabrication, installation, and any  
resulting documentation are the responsibility of  
the Fabricator.

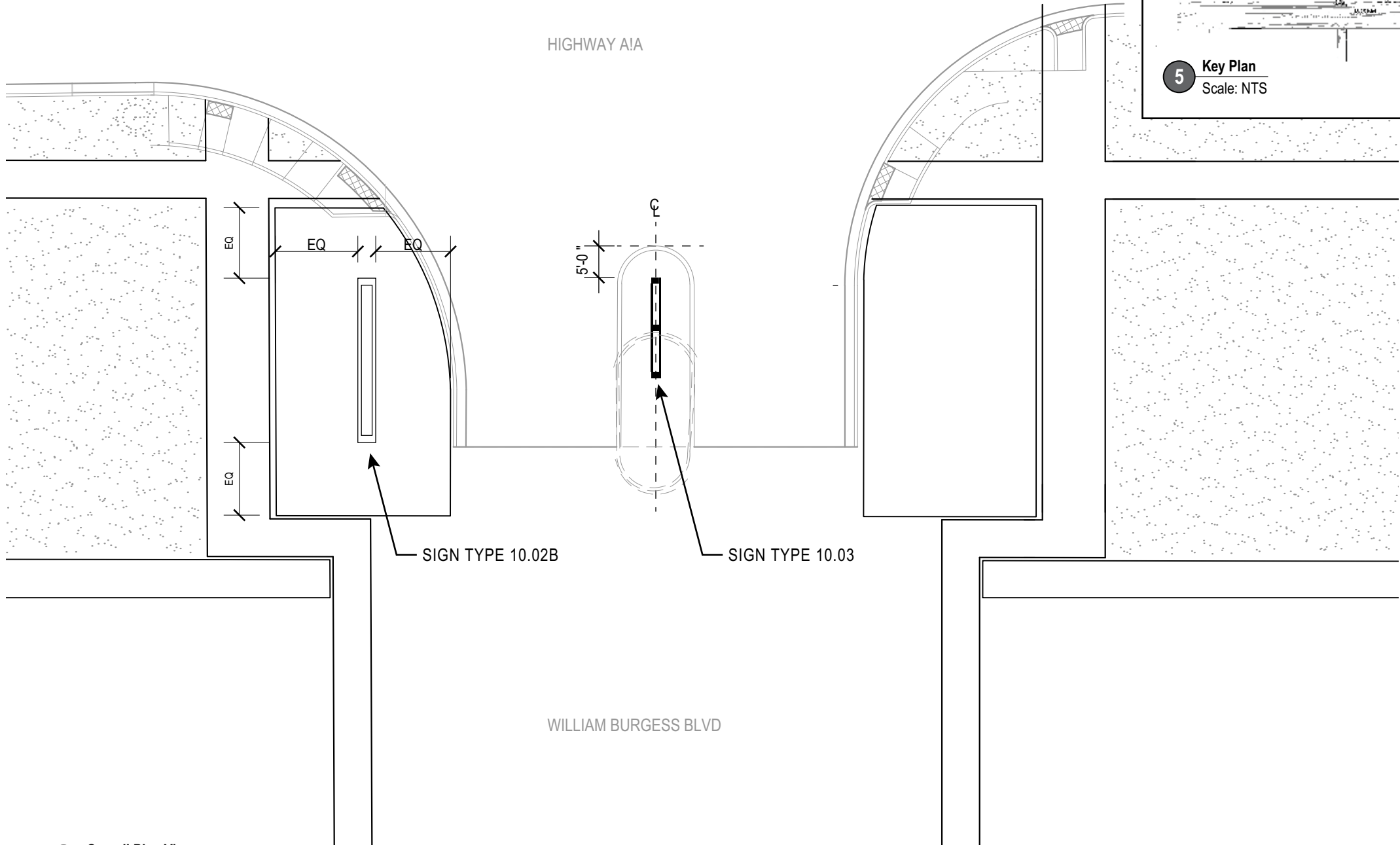

1 Overall Plan View  
Scale: 1"=20'-0"

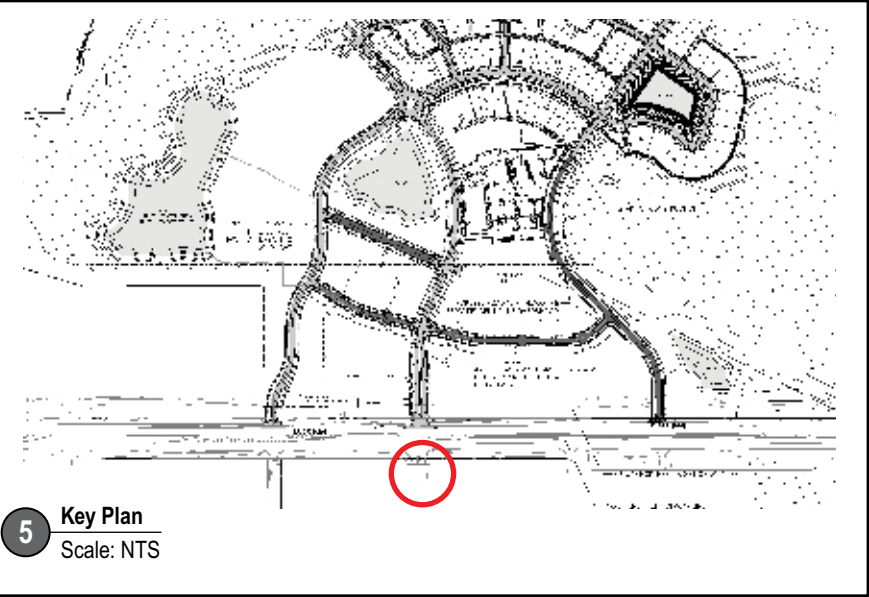

5 Key Plan  
Scale: NTS

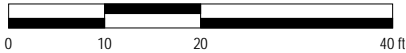



Proposed Master  
Signage Plan



**Wildlight**  
PROJECT  
**Raydient**  
OWNER  
**KK, CD, BJ, KK**  
505DESIGN TEAM

ORIGINAL ISSUE: 30 AUG 2017	
REVISIONS:	

Sign Type 10.02B -  
Project ID Sign with  
Tenant Listing at  
Village Entry  
(Hwy A1A Southside)

These drawings are for the sole purpose of  
expressing visual design intent and are not  
intended for construction purposes. All aspects  
engineering, fabrication, installation, and any  
resulting documentation are the responsibility of  
the Fabricator.

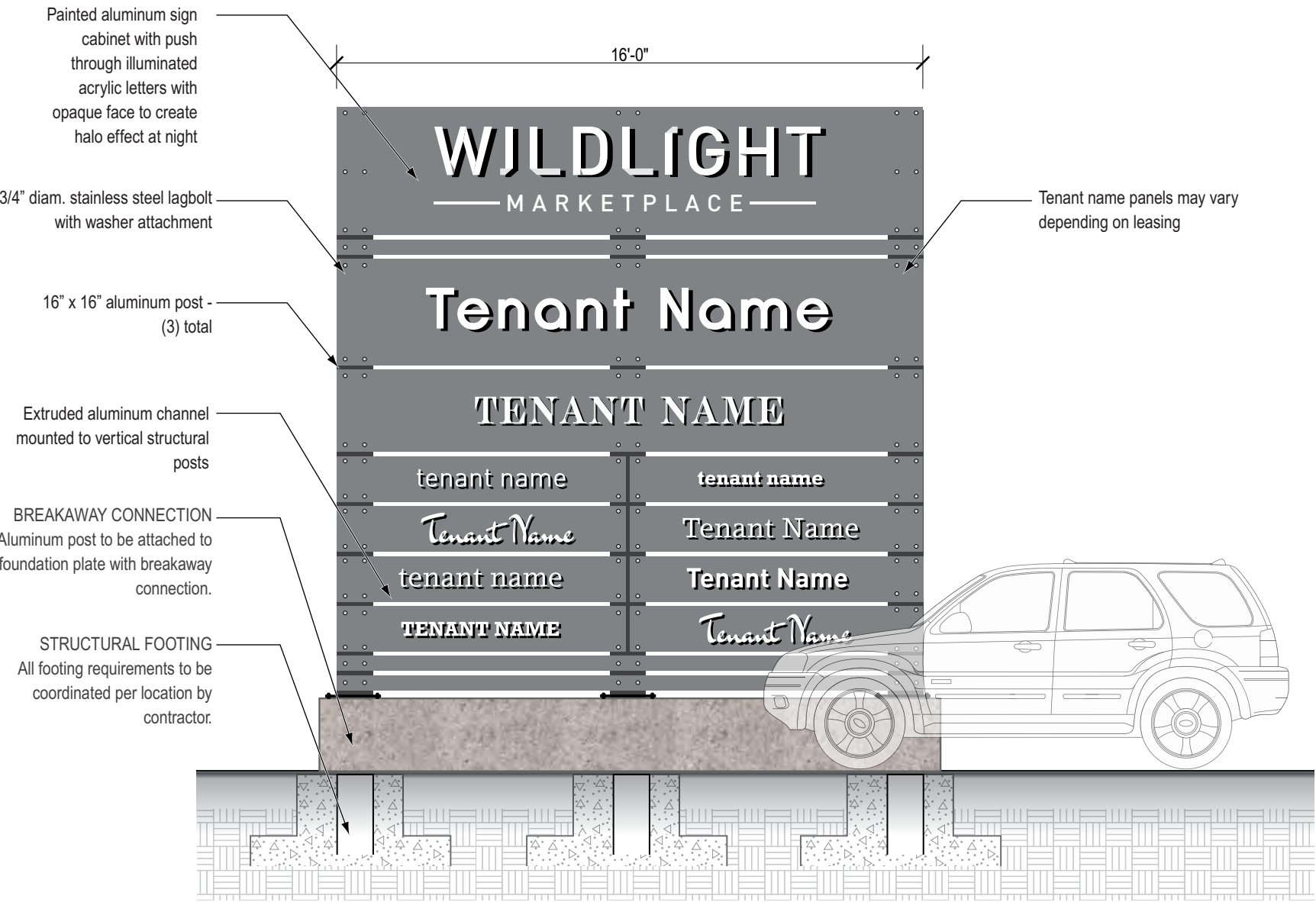

1 Sign Type 10.02B - Front View  
Scale: 1/4"=1'-0"

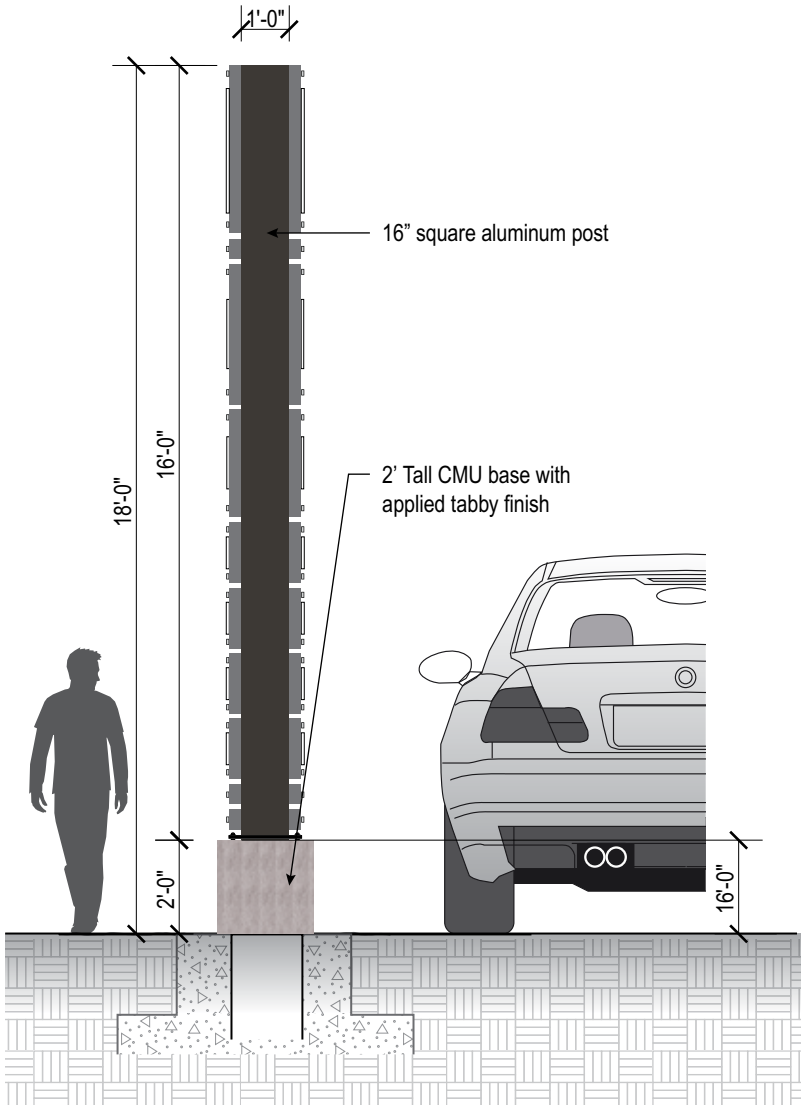

2 Sign Type 10.02B - Side View  
Scale: 1/4"=1'-0"

## **SIGN TYPE 10.03**

Large Project ID Sign with Tenant Listing  
QTY: 1



Proposed Master  
Signage Plan



Wildlight  
PROJECT

Raydient  
OWNER

KK, CD, BJ, KK  
505DESIGN TEAM

ORIGINAL ISSUE:	30 AUG 2017
REVISIONS:	

Sign Type 10.03 -  
Large Project ID Sign  
with Tenant Listing

These drawings are for the sole purpose of  
expressing visual design intent and are not  
intended for construction purposes. All aspects  
engineering, fabrication, installation, and any  
resulting documentation are the responsibility of  
the Fabricator.

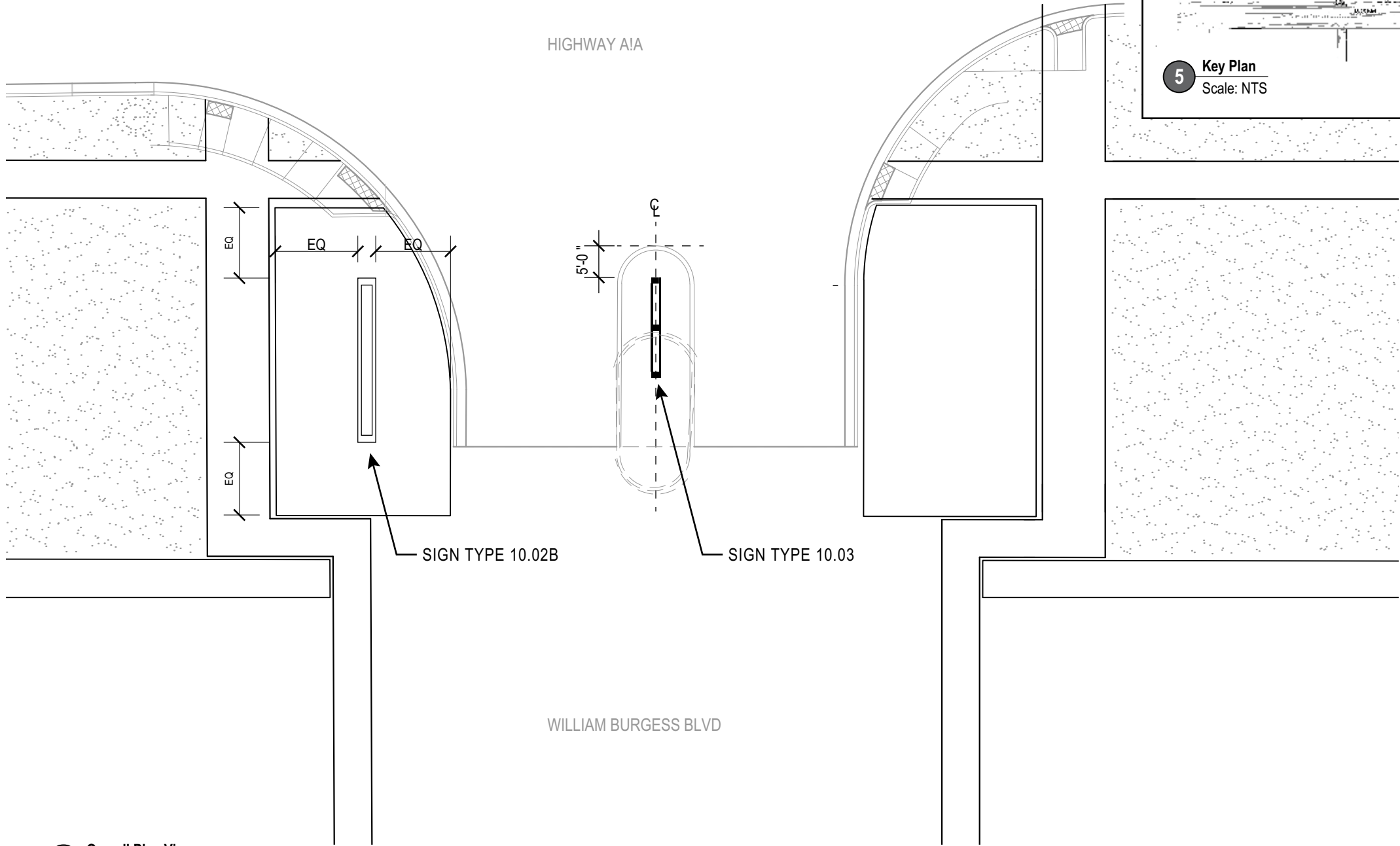

1 Overall Plan View  
Scale: 1"=20'-0"

5 Key Plan  
Scale: NTS

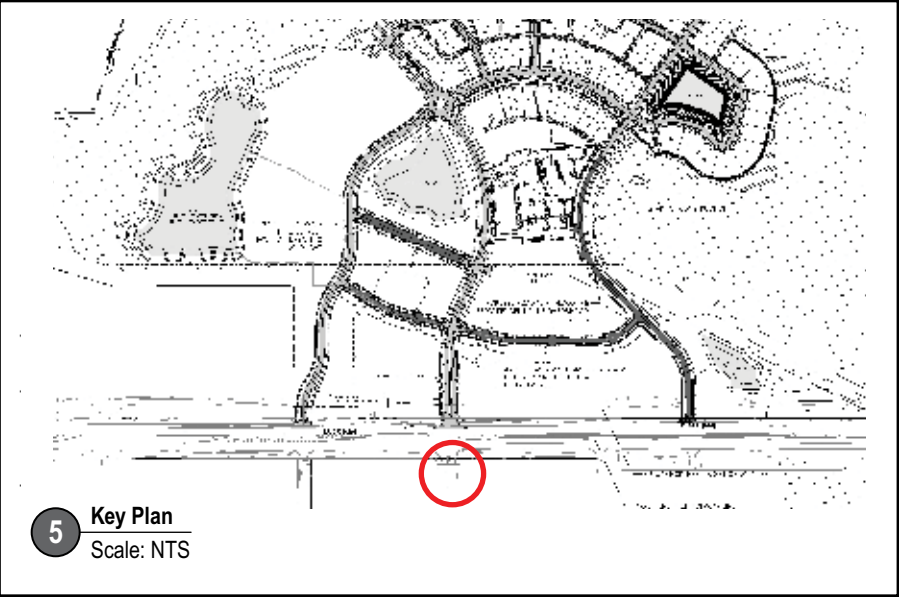

Proposed Master  
Signage Plan



Wildlight  
PROJECT

Raydient  
OWNER

KK, CD, BJ, KK  
505DESIGN TEAM

ORIGINAL ISSUE:	30 AUG 2017
REVISIONS:	

Sign Type 10.03 -  
Large Project ID Sign  
with Tenant Listing

These drawings are for the sole purpose of  
expressing visual design intent and are not  
intended for construction purposes. All aspects  
engineering, fabrication, installation, and any  
resulting documentation are the responsibility of  
the Fabricator.

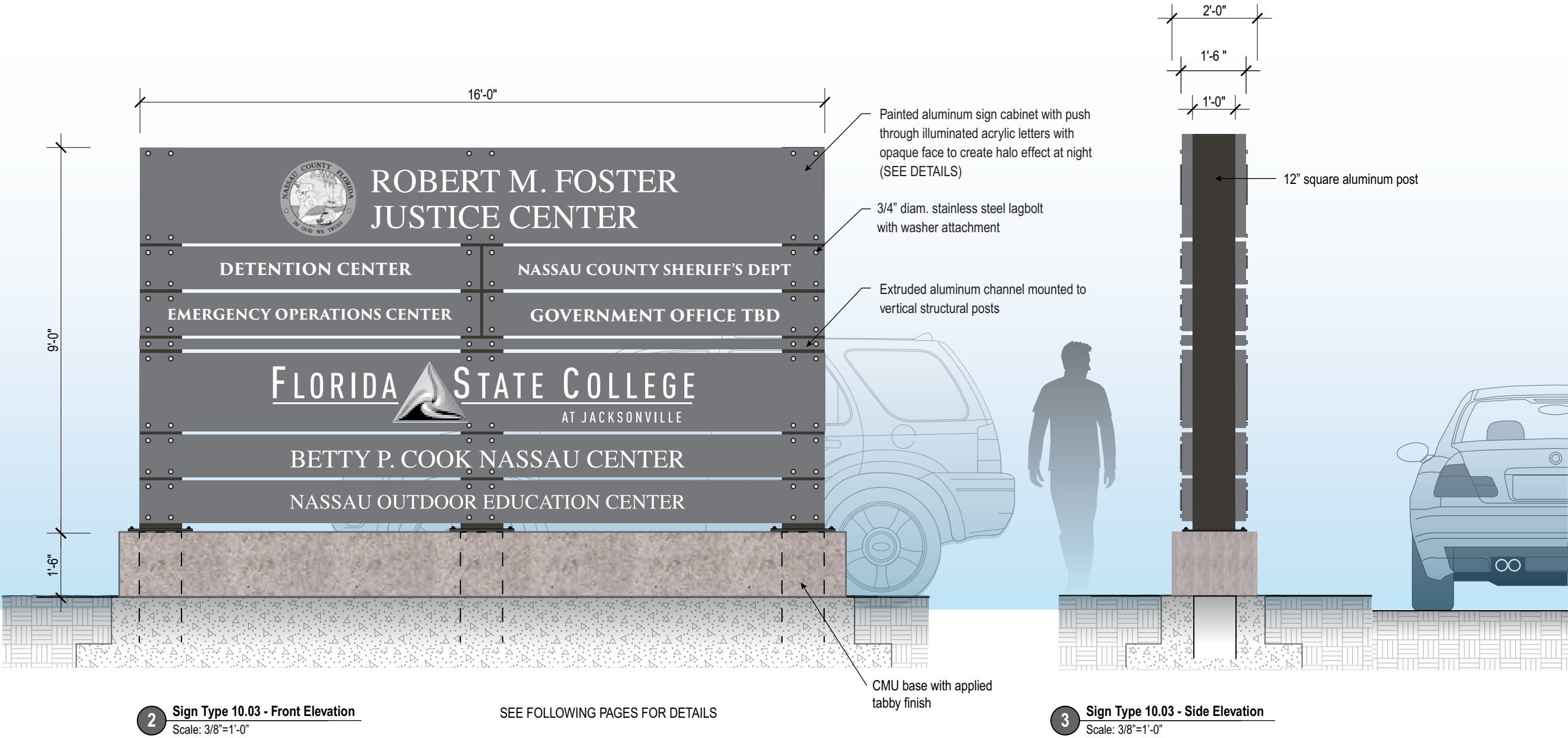



## **SIGN TYPE 10.04**

Landscape Sculptural Bird(s)

QTY: 30  
(20 Phase One - 10 Phase Two)

Proposed Master  
Signage Plan



Wildlight  
PROJECT

Raydient  
OWNER

KK, CD, BJ, KK  
505DESIGN TEAM

ORIGINAL ISSUE:	30 AUG 2017
REVISIONS:	

Sign Type 10.04 -  
Landscape Sculptural  
Bird(s)

These drawings are for the sole purpose of  
expressing visual design intent and are not  
intended for construction purposes. All aspects  
engineering, fabrication, installation, and any  
resulting documentation are the responsibility of  
the Fabricator.

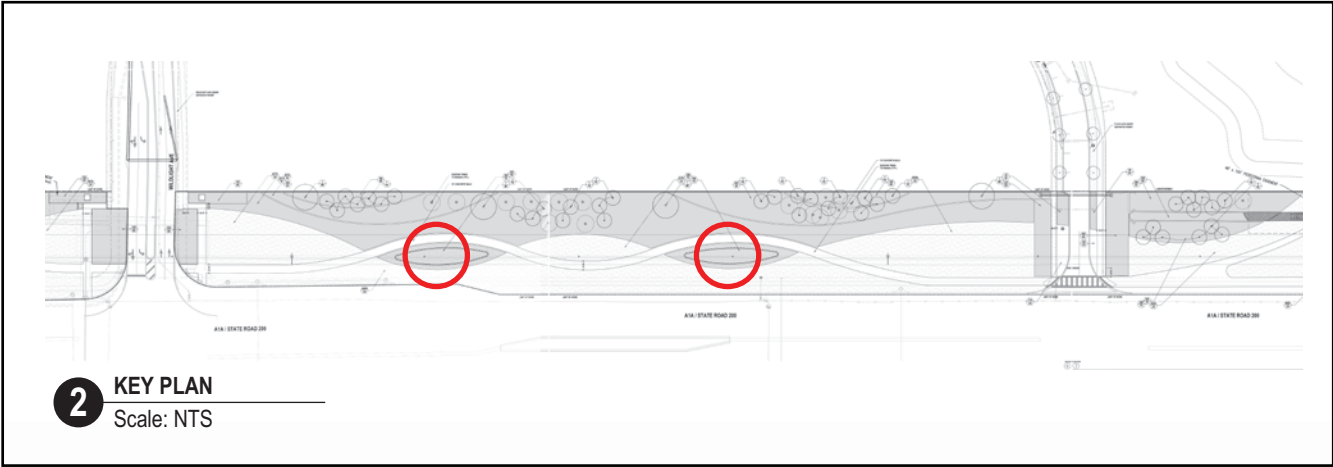

2 KEY PLAN  
Scale: NTS

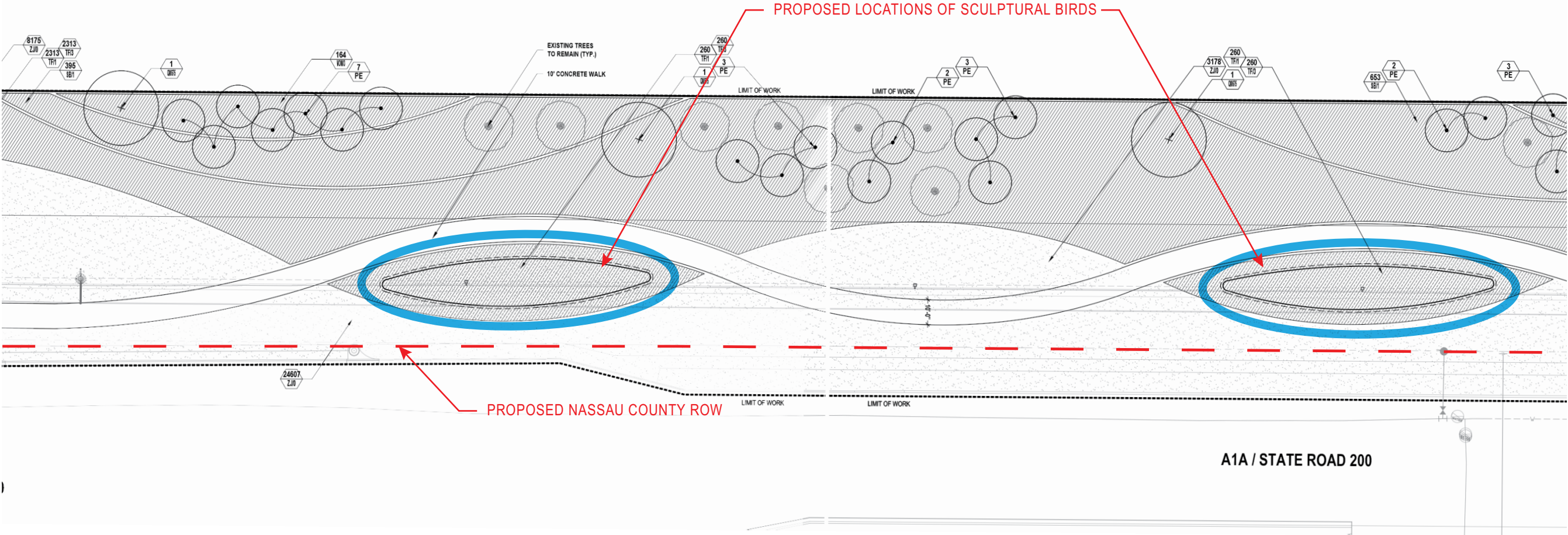

1 LANDSCAPE SCULPTURAL BIRD(S)  
Scale: 1 = 100



Proposed Master  
Signage Plan



**Wildlight**  
PROJECT

**Raydient**  
OWNER

**KK, CD, BJ, KK**  
505DESIGN TEAM



Perspsective View Along HWY A1A

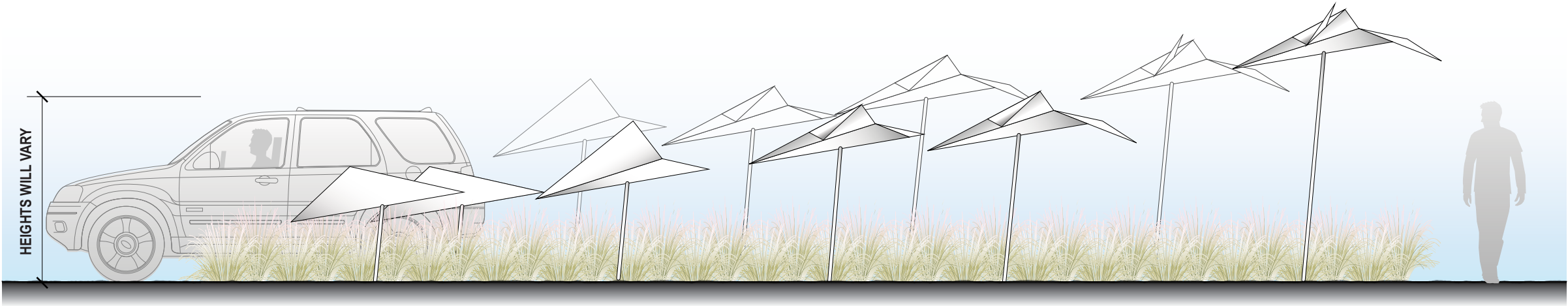

**1** Sign Type 10.04 - Front Elevation  
Scale: 3/16"=1'-0"

ORIGINAL ISSUE: <b>30 AUG 2017</b>	
REVISIONS:	

**Sign Type 10.04 -  
Landscape Sculptural  
Bird(s)**

These drawings are for the sole purpose of  
expressing visual design intent and are not  
intended for construction purposes. All aspects  
engineering, fabrication, installation, and any  
resulting documentation are the responsibility of  
the Fabricator.

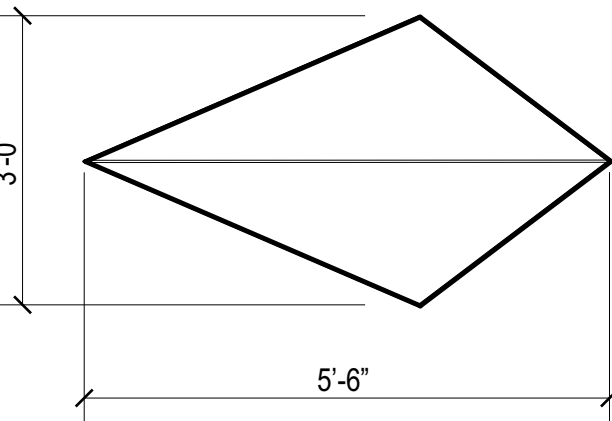

**1** Sign Type 10.04 - Plan View - Stage 1  
Scale: 1/2"=1'-0"

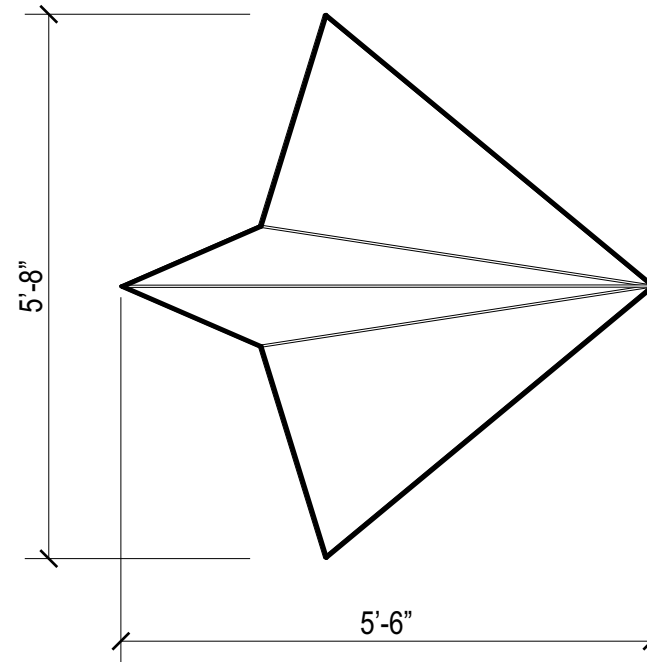

**2** Sign Type 10.04 - Plan View - Stage 2  
Scale: 1/2"=1'-0"

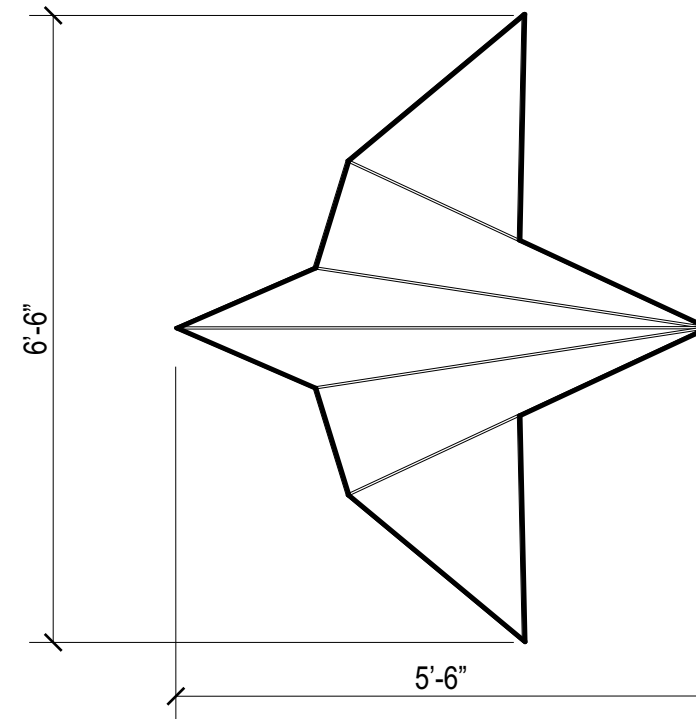

**3** Sign Type 10.04 - Plan View - Stage 3  
Scale: 1/2"=1'-0"

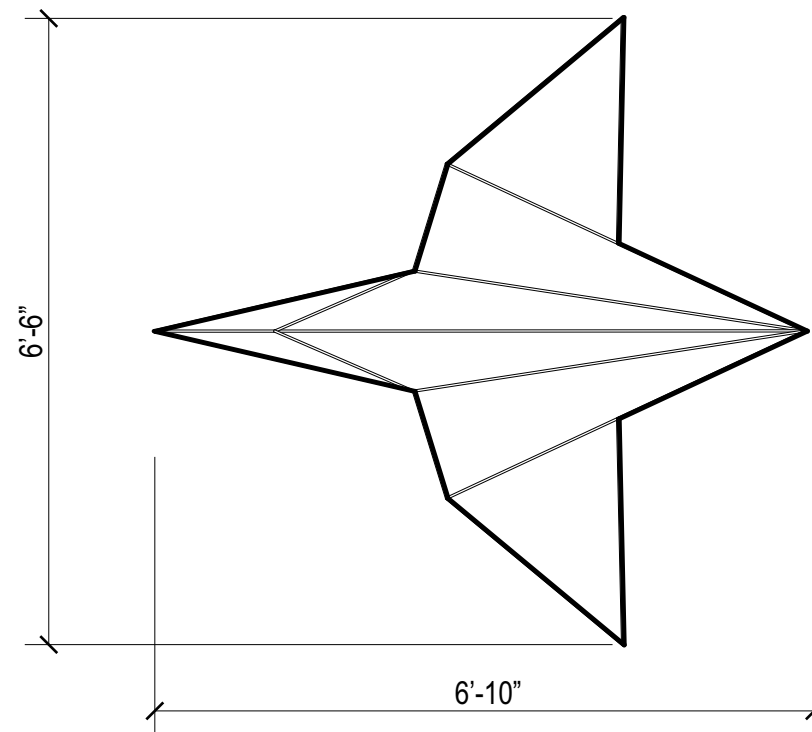

**4** Sign Type 10.04 - Plan View - Stage 4  
Scale: 1/2"=1'-0"

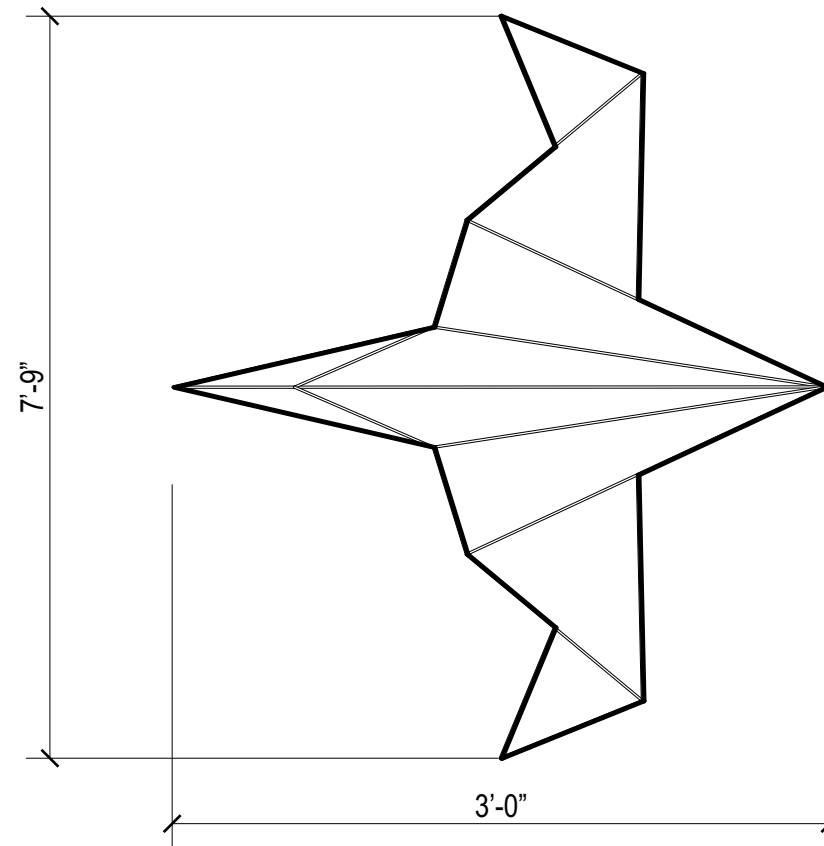

**5** Sign Type 10.04 - Plan View - Stage 5  
Scale: 1/2"=1'-0"

Proposed Master  
Signage Plan



Wildlight  
PROJECT

Raydient  
OWNER

KK, CD, BJ, KK  
505 DESIGN TEAM

ORIGINAL ISSUE:	30 AUG 2017
REVISIONS:	

Sign Type 10.04 -  
Landscape Sculptural  
Bird(s)

These drawings are for the sole purpose of  
expressing visual design intent and are not  
intended for construction purposes. All aspects  
engineering, fabrication, installation, and any  
resulting documentation are the responsibility of  
the Fabricator.



## **SIGN TYPE 10.06**

Outparcel Ground Mounted Identification Sign -  
along Hywy A1A (9' TALL)

QTY: 11

Proposed Master  
Signage Plan



Wildlight  
PROJECT

Raydient  
OWNER

KK, CD, BJ, KK  
505DESIGN TEAM

ORIGINAL ISSUE:	30 AUG 2017
REVISIONS:	

Sign Type 10.06 -  
Outparcel Ground  
Mounted ID Sign -  
Along Hywy A1A

These drawings are for the sole purpose of  
expressing visual design intent and are not  
intended for construction purposes. All aspects  
engineering, fabrication, installation, and any  
resulting documentation are the responsibility of  
the Fabricator.

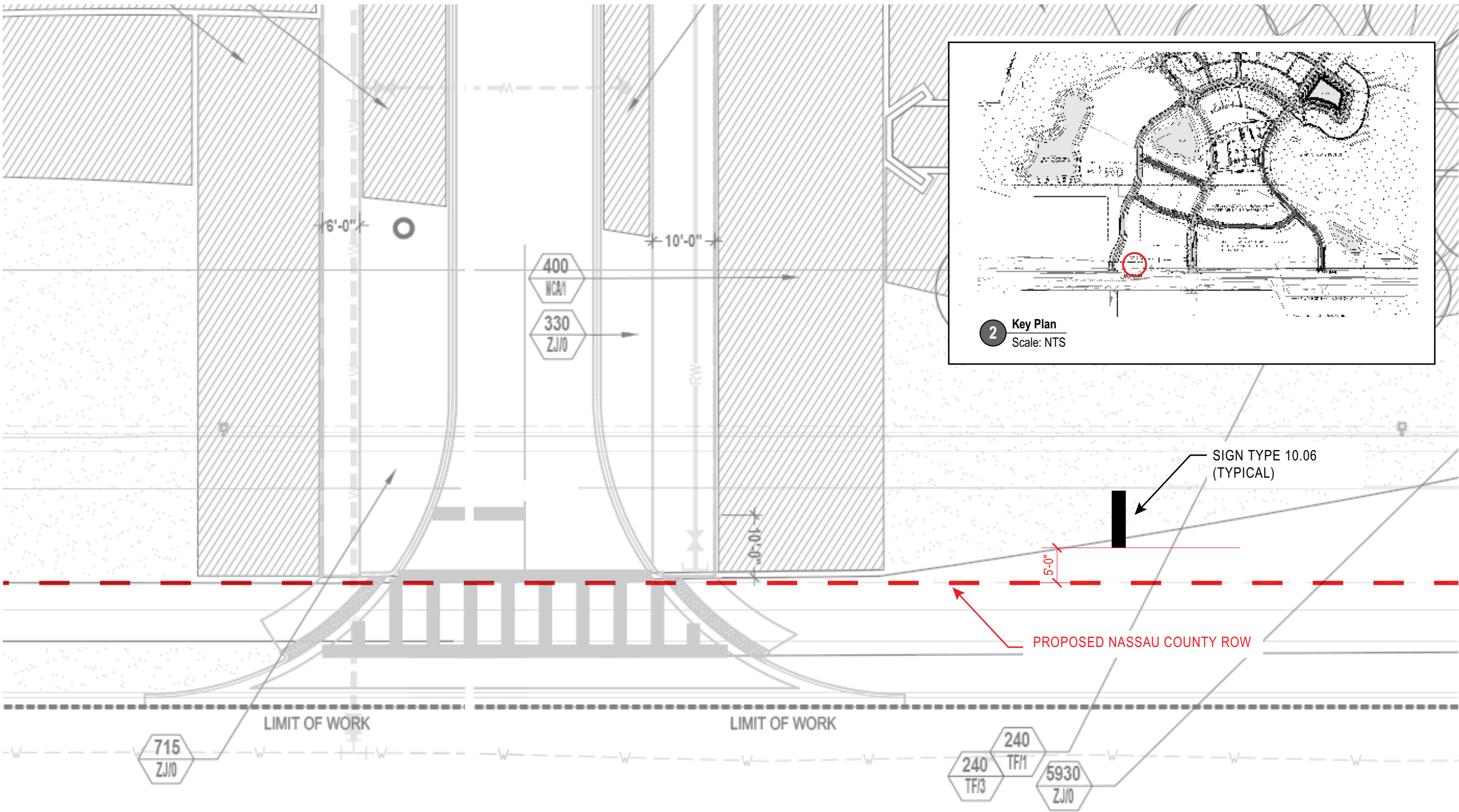

1 Sign Type 10.06 - Overall Location Plan - Typical  
Scale: 1/16"=1'-0"

2 Key Plan  
Scale: NTS

Proposed Master  
Signage Plan



Wildlight  
PROJECT

Raydient  
OWNER

KK, CD, BJ, KK  
505DESIGN TEAM

ORIGINAL ISSUE:	30 AUG 2017
REVISIONS:	

Sign Type 10.06 -  
Outparcel Ground  
Mounted ID Sign -  
Along Hwy A1A

These drawings are for the sole purpose of  
expressing visual design intent and are not  
intended for construction purposes. All aspects  
engineering, fabrication, installation, and any  
resulting documentation are the responsibility of  
the Fabricator.

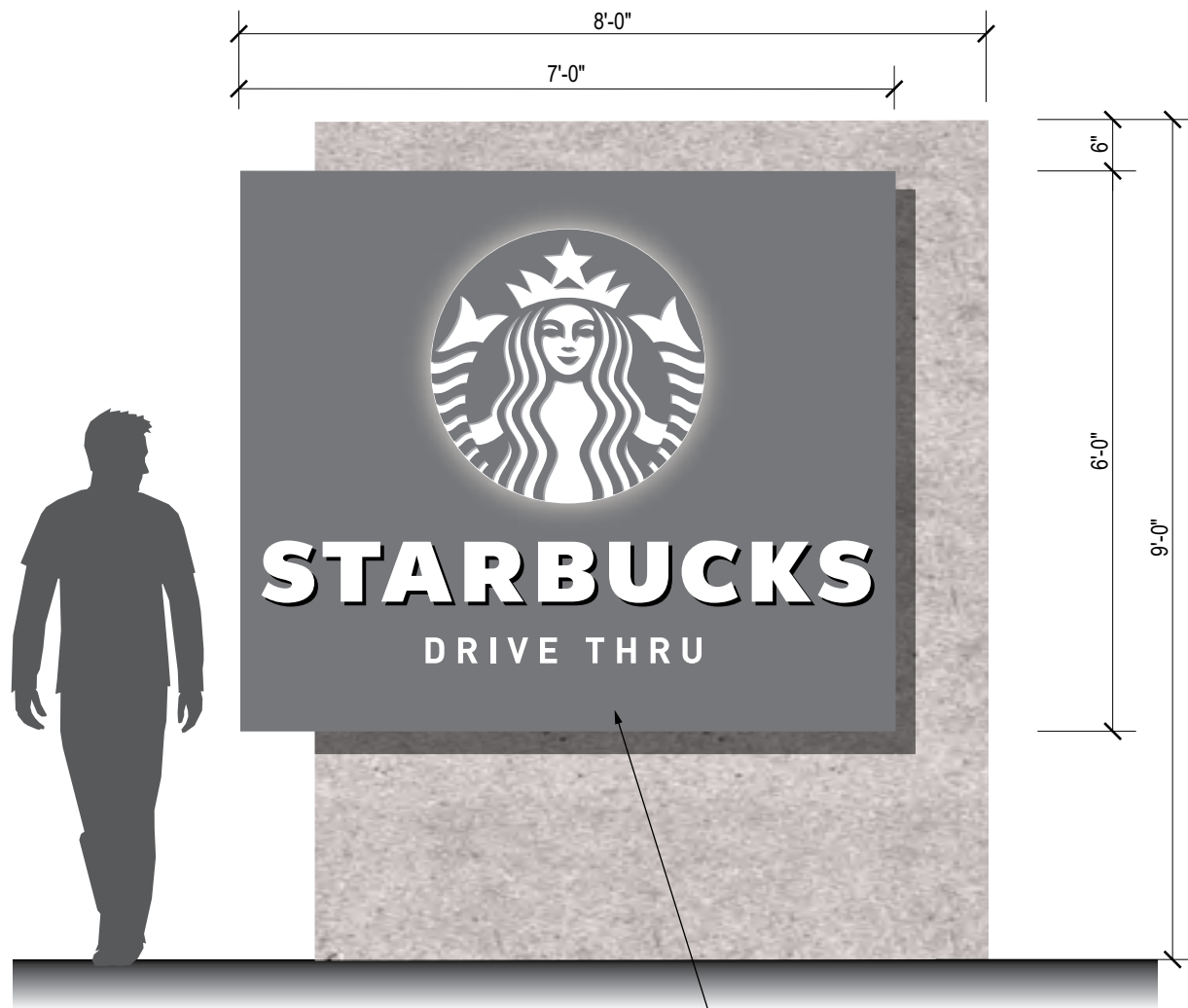

1 Sign Type 10.06 - Front Elevation  
Scale: 1/2"=1'-0"

Painted aluminum cabinet with white push-thru  
acrylic text/graphics

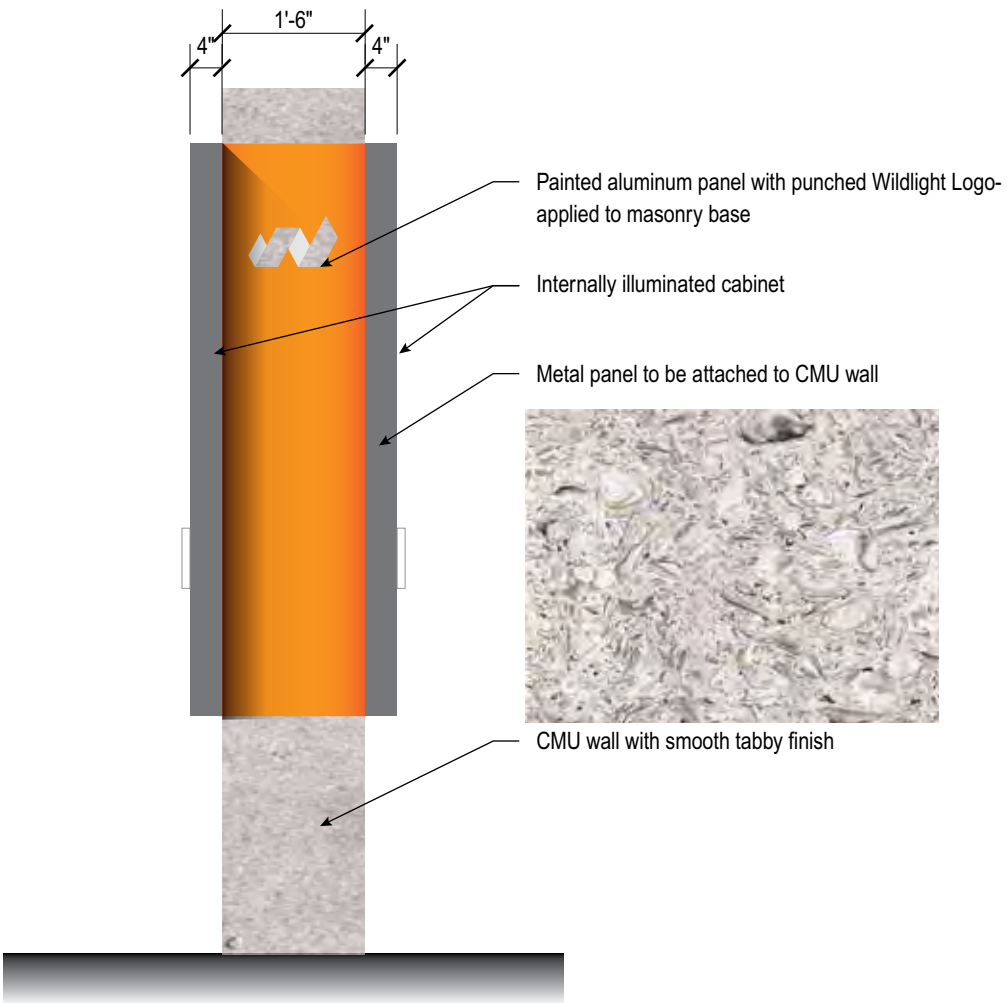

2 Sign Type 10.06 - Side Elevation  
Scale: 1/2"=1'-0"



3 Sign Type 10.06 - Context Elevation  
Scale: 1/4"=1'-0"

ALLOWANCES PER CODE:

Monument Sign

- maximum dimensions shall be 8 feet horizontal & 6 feet vertical
- to increase height, monument signs may have base concealed by shrubbery - 18" tall. No monument sign shall exceed 9 feet total height above natural grade