



Form Center

By signing in or creating an account, some fields will auto-populate with your information and your submitted forms will be saved and accessible to you.

American Beach Water and Sewer District Advisory Board Application

Date*

03/19/2021

First Name*

Eugene

Last Name*

Emory

Address1*

5576 Gregg St

Address2

City*

Fernandina Beach

State*

FL

Zip*

32034

Tax Parcel Number of Property Owned in the District*

00-00-30-010A-0007-0550

E-Mail Address*

eemory@emory.edu

Home Phone

Cell Phone

404-388-9968

Education, Training, or Experience Related to the activities of the Board to which appointment is sought (please feel free to attach additional documents):

See resume

Community/Civic Organization Memberships (please feel to attach additional documentation):

See resume

Have you ever served on a City, County, or other public advisory body in the past? *

☐ Yes

☒ No

If yes, please provide names and dates served (please feel free to attach additional documentation):

Resume*

No file chosen

Proof of Property Ownership*

No file chosen

Additional Information (cover letter, letter of recommendation, etc.)

No file chosen

protected by reCAPTCHA

[Privacy](#) - [Terms](#)

☒ Receive an email copy of this form.

Email address

This field is not part of the form submission.

* indicates a required field

Quick Links

Quick Links

Helpful Links



[Enable Google Translate](#)



[FY 20-21 Adopted
Budget](#)

[Public Information](#)

[Title VI |](#)

[Nondiscrimination | ADA
Plan](#)

[BOCC Statement on
Raydient/ENCPA](#)

[Employee Links](#)

[Agendas & Meetings](#)

[Live Board](#)

[Meetings/Meeting
Minutes](#)

[National Flood
Insurance Program](#)

[Affordable Housing](#)

[Development Review](#)

[Fee Schedule](#)

[Employee Links](#)

[Site Map](#)

[Accessibility](#)

[Copyright Notices](#)

[Translate](#)

CURRICULUM VITA-Condensed Version

Name: Eugene Kenneth Emory
Birthplace: Philadelphia, Pennsylvania
Education: University of Florida, Gainesville, Florida, Ph.D.
 Clinical-Developmental Neuro-Psychology, 1978.
 University of Florida, Gainesville, Florida, M.Ed.
 Educational Psychology, 1973.
 Edward Waters College, Jacksonville, Florida, B.S.
 Biological Sciences, Physical Education, 1969.
 Overbrook High School, Philadelphia PA
 General Academic Diploma,
 Athletics Honors, Basketball, Track & Field

Internship & Post Doctoral Training:

Children's Hospital, Harvard University, Boston Massachusetts, 1979.
 Certified Examiner with Brazelton Newborn Behavior Assessment Scale.
 University of California at Los Angeles, Post Doctoral Research Fellow in Clinical Psychology
 and Psychopathology, 1978-1979.
 Washington University School of Medicine, St. Louis. Child Guidance and Evaluation Clinic.
 Intern in Clinical Child Psychology. 1976-1977.

Faculty & Administrative Positions:

Distinguished Professor at Large: Edward Waters College,
 Jacksonville, Florida, 2008-present
Director of Clinical Training, APA approved Ph.D. program in clinical psychology, Emory
 University 2003-2008
Director: Center for Prenatal Assessment and Human Development, Department of Psychology,
 Emory University, 2000-present
Professor, Department of Psychology, Emory University, Atlanta, GA, 1992-present
Associate Professor, Tenure Department of Psychology, Emory University, Atlanta, GA, 1986-
 1992
Associate Professor-Tenure-Cornell University- Offer Declined
Assistant to Associate Professor, Department of Psychology, State University of New York at
 Binghamton, 1979-1986

Awards:

Delores P. Aldridge Faculty Excellence Award, Office of Multicultural Programs, Emory
 University, 2005
Outstanding Alumnus, College of Health Related Professions, University of Florida, 1997.
Outstanding Contributions to Clinical Neuropsychology, National Academy of
 Neuropsychology, 1997
Research Scientist Development Award, National Institute of Mental Health, 1989-1993.
United States Delegate to Chinese Association for Science & Technology (Peking, Zhengzhou,
 Shanghai, Hong Kong), October 1990-2000.
National Institute of Mental Health, Post Doctoral Research Fellowship in Psychology, UCLA,
 1978-1979.
U.S. Public Health Service Pre-doctoral Fellowship in Clinical Psychology, 1973-1976.
 Department of Clinical Psychology, University of Florida.

Minority Research Award, Institute of Black Culture, 1975, University of Florida.
Undergraduate Athletic Scholarship, basketball, track and field, 1964-1969

Civic Engagement:

Senior Class Ceremony: Keynote Speaker-Edward Waters College-1969

Property Owner-American Beach-1987-to present

Professional Civic engagement going back to 1994-Barnett Bank-News Leader Article-10/9/2020: See Attached

National Academy of Science Board for Behavioral, Cognitive and Sensory Sciences-1997-2007

Published Scientific Papers on Environmental Lead-and brain development-1999-2003

Emory, E., Patillo, R., Archibold, E., Bayorh, M. & Sung, R.
 (1999). **Neurobehavioral effects of low-level lead exposure in human neonates.** *American Journal of Obstetrics & Gynecology*, 188, S2-S11.

Emory, E., Ansari, Z., Patillo, R., Archibold, E., Chevalier, J. (2003). **Maternal Blood Lead Effects on Infant Intelligence at 7 Months of Age.** *New Scientific Developments*, *American Journal of Obstetrics and Gynecology*, 188: S26-32.

Women's Christian Alliance Board Member- Philadelphia PA, 2000-2016

Keynote Speaker-Franklin Town Church- Commemorating, National Register Designation-2012

Board Member-American Beach Property Owners Association-2014-2018

Science & History Symposium-NPS-Search for Franklin Town Series-2014-2018

Invited Keynote Speaker-Jacksonville Exchange Club-Understanding Foster Care-2015

Planner NANA Dune Interpretive Walking Trail with National Park Service-2015

Hosted National Park Service Funded College Collaboration between American Beach & HBCU to foster beach protection and research-2015

Founder, Franklin Town Historical Association-2017

Commissioner Gullah-Geechee Historical Corridor Commission-2019-present

Pending Grant Applications related to Civic Engagement

Organization: Franklin Town Historical Association Inc
 Form Name: African American Cultural Heritage Action Fund LOI
 Process Name: African American Cultural Heritage Action Fund 2021
 Project Name: **The Search for Franklin Town**

Authorized Organizational Representative (AOR) Name: Tiffani Patterson
Organization Name: Emory University
Temporary Proposal ID: 33076
Proposal ID: 2127905
Proposal Title: Enhancing Behavioral Science and STEM Education: Capacity Build and Broaden 2.0 at Minority-Serving Institutions (B2 2.0)
Submitted On: 03/12/2021 3:24 PM EST

Forensic Experience:***Civil Litigation:***

Expert Testimony: Testimony focusing upon residual effects of adult TBI, stroke, cerebral vascular disease and special expertise in peri-natal brain trauma and long-term outcome. Involved in over 50 depositions and court room appearances for both plaintiff and defense counsel, 1987-present.

Custody Evaluations

Expert Testimony is custody cases dating from 1979-present. Cases involving parental competence, best interest of child, long term care plan, parent training, foster care placement.

Criminal Litigation:

Neuropsychological Consultant to DeKalb, Gwinnett, Carrollton and Fulton Counties in Georgia along with consultant work throughout the East coast of the U.S. Expert Testimony for Public Defender's office related to mental competency, NGRI plea. Consultation with Capital Defender's Office, 2007-present

Have conducted over 1500 neuropsychological evaluations related to TBI, Learning Disabilities and Developmental Disorders, Organic vs. Functional Impairment, Malingered and effects of emotional trauma on later adjustment.

Professional Licensing and Certification:

Certificate in Clinical-Child Psychology, Washington University Medical School, St. Louis, Mo., 1976

Certification in Neonatal Neurobehavioral Assessment. Brazelton Neonatal Behavior Assessment Scale- Harvard University, Boston Massachusetts, 1979.

Licensed Clinical Psychologist, New York State, 1981, License # 6847

Panel Psychologist, New York State. Office of Vocational Rehabilitation, 1983.

Panel Certification in Neuropsychology, New York State. Office of Vocational Rehabilitation, 1984.

Licensed Psychologist, State of Georgia, 1987, License # 001197.

Panel Certification in Psychology & Neuropsychology, Georgia Division of Rehabilitation Services, 1990

Licensed Psychologist, State of Florida, 2013, License # PY 8701

United States Coast Guard, Master Captain's License Of Self-propelled Vessels of 100 GRT Upon Coastal Waters 100 nautical miles, July, 2016-Present

Teaching Experience - Undergraduate-Selected Courses

Abnormal Psychology
Developmental Psychology
 Research Methods in Developmental Psychology
Introduction to Human Neuropsychology
 Psychology in the Courts-Expert Witness & Testimony
 Laboratory Methods in Bio-Behavioral Psychology
 Stress & Pregnancy

Teaching Experience - Graduate-Selected Courses

Clinical Assessment (Intellectual and Personality)
 Clinical Assessment (Neuropsychological)
 Professional Issues in Clinical Psychology
Perinatal Neuropsychology
Prenatal Brain, Behavior and Cognition
 Introduction to Clinical Neuropsychology
 Research and Practice in Clinical Neuropsychology

Professional & Consultation:

Founding Partner: Georgia Behavioral Health Consortium, 2017-
Consulting Neuropsychologist-Georgia Department of Vocational Rehabilitation, 1995-
present
Chief Consulting Psychologist, MedPath Professional Services
Stockbridge, Georgia, 2006-2007
Consulting Psychologist; National Basketball Association Rookie Transition Program, 1995-
1999.
Founder & Consulting Psychologist: Institute for Psychological Development. Atlanta,
Georgia, 1996-Present
Clinical Neuropsychology Consultation, Eggleston Children's Hospital, Emory University,
1986-1988.
Psychologist, Lancaster Youth Development Center, Trenton, Florida, 1975-1976.
Psychologist, North Central Florida Community Mental Health Center, Gainesville, Florida,
1975-1976.

National Service Activities:

Charter Fellow of the American Psychological Society, 1997.
Board Member: National Academy of Sciences, Washington D.C., NRC, Board on Behavioral, Cognitive and Sensory Sciences, 1997-2007.
Member: National Research Council, Washington D.C., Committee on Developmental Outcomes and Assessment of Young Children, 2007-2009.
Board Member, Women's Christian Alliance, Freedom Charter School, Philadelphia, Pennsylvania, 2000-present
Member: Institute of Medicine Committee on Incorporating Social and Behavioral Science into Medical School Curriculum, Washington, D.C., 2002-2004
Member: National Academy of Sciences Committee on Juvenile Crime Prevention and Control, Washington D.C., 1998-2000.
Member: Institute of Medicine Committee on Capitalizing on Social Science and Behavioral Research to Improve the Public's Health, Washington D.C., 1999-2000

Selected Clinical & Research Publications from a total of 76

Emory, E., Lazarus, G., Faboyede, G. (2017) Teaching Psychology: An International Perspective on Biology & Human Behavior, In Rich, Gielen, & Takooshian (Eds.): pp. 191-212.

Internationalizing the Teaching of Psychology: Information Age Publishing Inc., Charlotte, NC 28271

Zhang, H., and Emory, E.K., (2015). A Mindfulness-Based Intervention for Pregnant African American Women. *Mindfulness* 6, (3), 663-674

Emory, E.K. (2010). A Womb with a View: Ultrasound for Evaluation of Fetal Neurobehavioral Development, *Infant Behavior & Child Development*, 19:119-124.

Alvarez, J. & Emory, E. (2006) Executive Function and the Frontal Lobes: A Meta Analytic Review, *Neuropsychology Review*, 16, (1): 17-42.

Emory, E., Dieter, J. (2006) Maternal Depression and Psychotropic Medication Effects on the Human Fetus, *Annals of the New York Academy of Science*, 10:1196:12-15.

Emory, E. K. (1991). A neuropsychological perspective on perinatal complications and the law. *The Clinical Neuropsychologist*, 5:1-25.

Emory, E. K., *Tynan., W. D., & Dave, R. (1989). Neurobehavioral anomalies in neonates with seizures. *Journal of Experimental & Clinical Neuropsychology*, 11:231.

Research Grant Support:

Principal Investigator

Training in Neonatal Behavioral Assessment. Biomedical Research Support Grant, National Institutes of Health, 1980, \$1200.

Perinatal Determinants of Physiologic and Behavioral Responses in the Human Infant. Biomedical Research Support Grant, National Institutes of Health, 1981-1982, \$6000.

Perinatal Influences on Infant Heart Rate and Behavior. University Awards Program, State University of New York Research Foundation, 1981-1983, \$3800.

Preliminary Study of Learning and Memory in High-Risk Infants. Biomedical Research Support Program, National Institutes of Health, \$2500.

Effect of Caffeine on Newborn Behavior. Biomedical Research Support Program, National Institutes of Health, \$750 (with Susan Hronsky, graduate student), 1983.

Fetal Heart Rate Responsivity and Newborn Behavior. National Science Foundation, 1984-1987, \$85,144.00.

Fetal Heart Rate Responsivity and Newborn Behavior. National Science Foundation, 1986-1990, \$101,399.00.

Effects of ECT and medication on Neuropsychological functioning in depressed patients. Biomedical Research Support Grant. 1986-1988 (with Adele Rabin), \$3700.00.

Research Scientist Development Award. National Institute of Mental Health, 1989-1994, \$450,000.

Individual and Sex Differences in Stress Reactivity, National Institute of Mental Health, 1991 - 1994, \$151,895.

Reliability and Validity Assessment of the Use of Stressful Life Events in African-American Women of Reproductive Age. Center for Disease Control and Prevention, 1993-1995, \$758,000.

Studies in Behavioral Perinatology. National Institutes of Health, 1993-1998, \$704,836.

Effects of Maternal Massage on Human Infant Development. University Research Committee. Emory University, 2002-2003, \$30,000.

Fetal Reactivity and Maternal Psychopathology, National Institutes of Mental Health, 2004-2009, \$1,450,000.

Fetal Brain Laterality and Maternal Vocalization, National Science Foundation, 2020-2022, in preparation

Pre and Post-doctoral Fellowship Sponsor:

Ontogenesis of the Stress Response in Infancy, Predoctoral Fellowship to Tammy Savoie, 2/89-2/91, \$22,000, NIMH.

Neuroendocrine Development of the Stress Response, Postdoctoral Fellowship to Jean King, Ph.D., 9/89-10/91, \$49,000, NIMH.

Sex Differences in Physiological Stress Reactivity, Postdoctoral Fellowship to Maryann Davis-DaSilva, Ph.D., 1/90-6/93, \$56,000, NIMH.

Differential Effects of Stimulation on Premature Infants, Predoctoral Fellowship to John Dieter, National Institute of Mental Health, 1995-1997, \$26,016.

Studies in Behavioral Perinatology, Research Supplement for Underrepresented Minorities to B. Denise Raynor, M.D., Associate Professor of Obstetrics and Gynecology, National Institutes of Health, 1996-1998, \$146,140.

Fetal Movement & Habituation, Predoctoral Fellowship to Marlyne Israelian National Institute of Mental Health, 1996-1998, \$26,016.

Fetal Brain Development and Emotional Development, Senior Research Fellowship to Dr. Kim Bard, 1998-2000, 96,000, National Institutes of Health

Maternal Depression and Fetal Behavior, Young Investigator Award to Dr. John Dieter, 2002-2004, National Alliance for Research on Schizophrenia and Depression, 100,000.

Education for Self-Reliance: A National Cross-Cultural Health Dissemination Model: National Science Foundation-Post Doctoral Fellowship for Kelly Lewis, 2004-2006, \$100,000.

PROPERTY INFORMATION

Parcel Number 00-00-30-010A-0007-0550

Owner Name	EMORY EUGENE K
Mailing Address	5576 GREGG ST
Location Address	FERNANDINA BEACH, FL 32034
	WALDRON ST
	FERNANDINA BEACH 32034
Tax District	UNINCORPORATED MIDDLE ISLAND
Millage	16.1909
Homestead	No
Property Usage	VACANT 000000
Deed Acres	0
Short Legal	BLOCK 7 LOT 55 IN OR 1062/1690 & PT OF VACATED PRICE ST

2020 Final Values

Land Value	\$162,500
(+) Improved Value	\$0
(=) Market Value	\$162,500
(-) Agricultural Classification	\$0
(-) SOH or Non-Hx* Capped Savings	\$16,090
(=) Assessed Value	\$146,410
(-) Homestead	\$0
(-) Additional Exemptions	\$0
(=) School Taxable Value	\$162,500
(-) Non-School HX & Other Exempt Value	\$0
(=) County Taxable Value	\$146,410

Note: 10% Cap does not apply to School Taxable Value

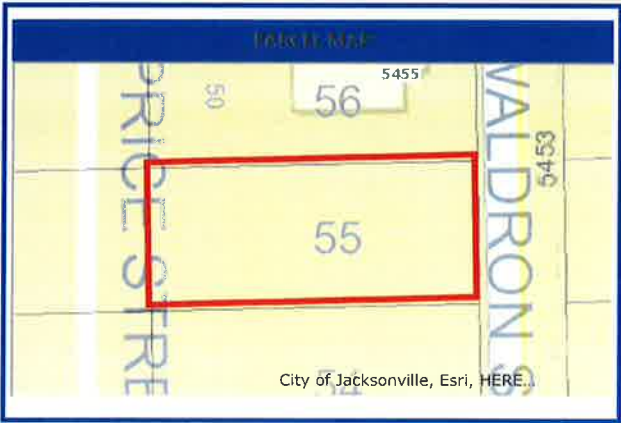

PROPERTY PHOTO



3/13/2020

If this picture is incorrect, please email info@nassauflpa.com

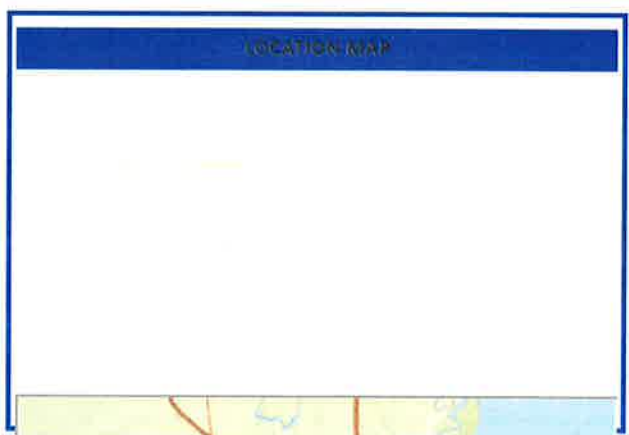

EVALUATION INFORMATION									
Type	Total Area	Heated Area	Bedrooms	Baths	Primary Exterior	Secondary Exterior	Heating	Cooling	Actual Year Built
IMPROVEMENT INFORMATION									
Description	Dimensions L X W	Units	Year Built						
SALES INFORMATION									
Sale Date	Book Page	Price	Instr	Qual	Imp	Grantor	Grantee		
2002-06-14	1062 / 1690	\$70,000	WD	U	N	JUDKINS ROBERT L & MARION B	EMORY EUGENE K		

1973-01-01

[154 / 23](#)

\$3,500

WD

U

N

Change of Address

FAQ

APP

PROPERTY INFORMATION

Parcel Number 00-00-30-010C-0001-0180

Owner Name EMORY EUGENE K &

Mailing Address HOOKS OLIVETTE M (JT/RS)(B&S)

5576 GREGG ST

FERNANDINA BEACH, FL 32034

Location Address 5576 GREGG ST

FERNANDINA BEACH 32034

Tax District UNINCORPORATED MIDDLE ISLAND

Millage 16.1909

Homestead Yes

Property Usage MULTI-FAMI 000800

Deed Acres 0

Short Legal BLOCK 1 LOTS 18 & 19 IN OR 534/308 AMERICAN BEACH #3 UNIT 1

2020 Final Values

Land Value \$840,000

(+) Improved Value \$319,161

(=) Market Value \$1,159,161

(-) Agricultural Classification \$0

(-) SOH or Non-Hx* Capped Savings \$453,090

(=) Assessed Value \$706,071

(-) Homestead \$25,000

(-) Additional Exemptions \$0

(=) School Taxable Value \$778,776

(-) Non-School HX & Other Exempt Value \$25,000

(=) County Taxable Value \$656,071

Note: 10% Cap does not apply to School Taxable Value

Property Search

Map This Parcel

GIS Report

Property Record Card

Print Friendly Page

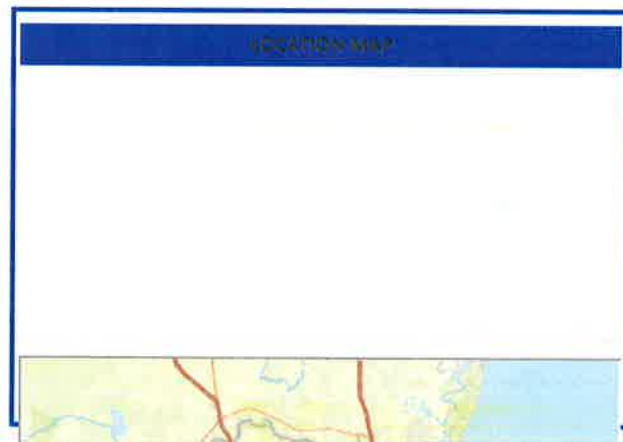

BUILDING INFORMATION									
Type	Total Area	Heated Area	Bedrooms	Baths	Primary Exterior	Secondary Exterior	Heating	Cooling	Actual Year Built
TRI/QUAD	5867	4230	10	5	WD FR STUC	CB STUCCO	AIR DUCTED	FORCED AIR	1963

VEHICLE INFORMATION			
Description	Dimensions L X W	Units	Year Built

SALES INFORMATION							
Sale Date	Book Page	Price	Instr	Qual	Imp	Grantor	Grantee
1987-12-31	534 / 308	\$125,000	MS	U	Y	NAIRN SARA G	EMORY & HOOKS

To: Nassau County Florida
Board of County Commissioners

From: Eugene K. Emory Ph.D.
American Beach Resident and Property Owner
Professor, Emory University, Atlanta, Georgia

March 19th, 2021

Serving on the American Beach Water & Sewer District Advisory Board would be a unique experience. My primary professional interest in the future of American Beach rest on the assumption that thoughtful, culturally sensitive development is consistent with the desires of all who care about this community. I have studied the pros and cons of public and private water systems, and have used both successfully. In the case of American Beach, I suspect the conversation draws to an end when everyone can turn on their faucet, flush their toilet and ride the waves of economic growth. Why do people come to American Beach despite the fact there is virtually no economic growth? Why are people willing to build multi-million dollar homes with wells and septic tanks? If one considers these questions carefully, it will guide deliberations of the Advisory Board towards recommendations with long-lasting beneficial results for American Beach and those who cherish its ambiance.

For me, the framework guiding development of a Water & Sewer District for American Beach should include a careful consideration of what the eventual outcome will be. In my opinion a fundamental question is, "How can American Beach develop infrastructure that honors its past and embraces a future that, upon reflection, makes us all proud?" Can we preserve and honor those physical and cultural monuments to help transcend fear and apprehension that a familiar way of life is slipping away? Can we embrace a future that honors the individual as an active participant in public safety decisions? I want American Beach to become the gold standard for how culturally sensitive and indigenous communities evolve in ways that augment economic growth, respect the need for public safety and insure that all citizens can become self-actualized.

Contrary as it might seem, I am not the voice of dissent. I have served successfully on boards of directors or trustees for social service agencies, property owners associations, federal scientific review boards, federal heritage commissions and university presidential task forces. I am the founder of the Franklin Town Historical Association. I plan to make it the poster child for Untold Stories of Enslaved Persons and Indigenous People. There is no place in this country where such a story could be better told. My talks to the National Park Service Science and History Symposia have been well received, partly because it is an untold story, but more importantly these talks help to contextualize American Beach in ways previously ignored.

The American Beach Water & Sewer District will hopefully become part of the natural evolution of "place", not an appendage with no contextual meaning. That is the perspective I hope to bring to the Advisory Board if selected. I am currently a commissioner of the Gullah-Geechee Cultural Heritage Corridor, of which American Beach is a part. Our charge is to help preserve cultural monuments to the culture of this area, with the goal of forming a more perfect union. I will close with one of my most cherished accomplishments. Over 20 years ago, as the keynote speaker for the institution's 150th anniversary I made a formal recommendation to the Emory University Board of Trustees and the broader community of students and scholars. Twenty years later in 2020, the new university president has made that recommendation a guiding priority for the schools efforts towards reconciliation and highlighting the

Annette M. Myers
P. O. Box 15024 - 5406 Ervin Street
American Beach, Florida 32035
904 261-4396

March 19, 2021

Nassau County Manager Taco Pope &
Nassau County Commission Board
96135 Nassau Place, Suite 1
Yulee, FL 32097

Dear County Manager Pope:

This letter is in regards to the American Beach Water and Sewer District Advisory Board.

I am Annette Myers, a Fernandina native, a longtime and full-time property owner at American Beach since the early 1960s. I am also a past president of the American Beach Property Owners' Association (ABPOA), serving as an officer and past president for over ten years.

At this time, I am recommending Dr. Eugene Emory, an African-American legal property owner for over thirty years, to serve on the upcoming American Beach Water and Sewer District Advisory Board. Dr. Emory lives in American Beach and currently serves as a professor at Emory University in Atlanta, Georgia. Dr. Emory is also a past president of the ABPOA. As a past president, he is aware of and has actively dealt with water and sewer issues in the American Beach community.

Dr. Emory is quite knowledgeable and he has done extensive research regarding the water and sewer situation in the community.

I am aware of his wide range of affiliations and qualifications which makes him highly capable to serve on the board. His application should list those qualifications.

I strongly recommend your consideration in appointing Dr. Eugene Emory to the Advisory Board.

Respectfully,

Annette Myers

Annette Myers
Past President, ABPOA
American Beach Author & Historian

EDWARD WATERS COLLEGE



Date: February 23, 2021

**To: Jacqueline A. Conley, PhD
Brian Seymour, PhD
Edward Waters College
Jacksonville, FL 32209**

**Eugene Emory, PhD
Emory University
Atlanta, GA 30322**

Re: Letter of Commitment from Edward Waters College Schell-Sweet Community Resource Center (EWC-SSCRC)

Dear Drs. Conley, Emory, and Seymour:

I am pleased to inform you that The Edward Waters College Schell-Sweet Community Resource Center (EWC-SSCRC) wishes to state its full unwavering support and commitment to the success of the NSF's Build and Broaden 2.0: Capacity at Minority Serving Institution's program. This collaboration, which will engage faculty and students in STEM related research, will benefit both Institutions and contribute to the research literature.

When this grant proposal receives funding, the Schell-Sweet CRC will support the use of space in the Schell Sweet CRC facility on a scheduled basis.

Please feel free to contact me with any questions.

Sincerely,

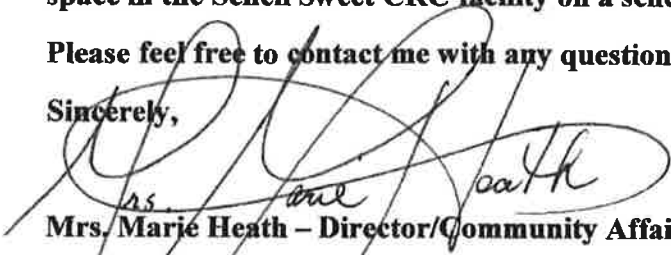
Mrs. Marie Heath – Director/Community Affairs

Edward Waters College

Schell Sweet Community Resource Center

1697 Kings Road, Jacksonville, Florida – 32209 - (904) 318-0678

AL LAWSON
5TH DISTRICT, FLORIDA
ASSISTANT MAJORITY WHIP
COMMITTEE ON FINANCIAL SERVICES
COMMITTEE ON AGRICULTURE

Congress of the United States
House of Representatives
Washington, DC 20515

1406 LONGWORTH OFFICE BUILDING
WASHINGTON, DC 20515
(202) 225-0123
(202) 225-2256 - FAX

CITY HALL
117 W. DUVAL STREET
SUITE 240
(904) 354-1652
(904) 379-0309

435 MACOMB STREET
JACKSONVILLE, FL 32202
(850) 568-9450
(850) 577-0833 - FAX

[HTTP://WWW.LAWSON.HOUSE.GOV](http://www.lawson.house.gov)

March 2, 2021

Siobhan Mattison
Program Officer
National Science Foundation
2415 Eisenhower Avenue
Alexandria, VA 22314

Dear Siobhan Mattison,

I am proud to support Edward Waters College (EWC) and Emory University in their grant submission for the National Science Foundation (NSF) Build and Broaden 2.0: Capacity at Minority Serving Institution (MSI)'s program.

The Science, Technology, Engineering, and Mathematics (STEM) career field is rapidly expanding, and new talent is desperately needed to meet the demands. For this reason, a focus on strengthening STEM majors in all educational settings has been a Congressional priority, but MSIs need additional resources to increase student exposure and immersion to the STEM field. That is why I support EWC and Emory University's proposal for the NSF Build and Broaden 2.0: Capacity at MSI's program. As the first historically black college in Florida, the hardworking students and faculty at EWC could not be more deserving of the research opportunities that would be created by this grant program. Emory University is a high-ranking, research university and a Predominately White Institution (PWI) that would provide advanced technology and innovative perspectives to EWC students in STEM fields. Additionally, the educational partnership of a Methodist-based MSI and PWI would shape a unique vantage point for students and faculty of both institutions.

This collaboration is needed in order to foster a more diverse, well-rounded STEM candidate pool. Therefore, I strongly approve of EWC and Emory University's proposal. Your favorable consideration of this application will be greatly appreciated. If you have any questions, contact my office at (202) 225-0123.

Sincerely,



Al Lawson
Member of Congress