



REQUEST FOR QUALIFICATIONS

NASSAU COUNTY BOARD OF COUNTY COMMISSIONERS

Solicitation Title: Nassau County Justice Center Courtroom #3 - Design Criteria Professional (RE-BID)	
Solicitation Number: NC21-052-RFQual-(RE-BID)	Project/Contract Duration: 90 days, or as negotiated
Requesting Department: Facilities Maintenance	Procurement Contact: Evelyn Burton
Contact Address: 96135 Nassau Place, Suite 2 Yulee, Florida 32097	Contact Information: eburton@nassaucountyfl.com 904.530.6040
Response Due Date and Opening Date/Time: Tuesday, December 7, 2021 @ 10:00 AM (Nassau County time)	
Pre-Response Meeting Date/Time: Thursday, November 18, 2021 @ 1:00 PM 76347 Veterans Way Yulee, FL 32097	Deadline for Questions: Tuesday, November 30, 2021 @ 4:00 PM (Nassau County time)
Location of Response Opening: Robert M. Foster Justice Center, 76347 Veterans Way, Second Floor, Yulee, Florida 32097	

In accordance with the intent and content of this solicitation, we the undersigned do hereby offer to perform as stipulated in this response. Failure to do so may result in the forfeiting of bid security, removal from the County's vendor list, or other remedies available to the County under the laws of the State of Florida.

Legal Name of Respondent: PQH Group Design, Inc.		
Business Address: 4141 Southpoint Drive East, Suite 200, Jacksonville, FL 32216		
Phone Number: 904-224-0001	Email: hoenshelr@pqh.com	FL License Number: AR98244
Authorized Signature: 		Date: 12/07/21
Printed Name of Signer: Ricardo Quiñones, AIA, LEED AP BD+C		Title: President

General Instructions/Declarations

1. Response results will be available pursuant to Florida Statute 119.071(b).
2. Responses must be submitted on the forms furnished by the County within this solicitation, unless otherwise specified below.
3. This page must be completed and returned as the top sheet of any response submitted.
4. It is the intent and purpose of Nassau County that this solicitation promotes competitive bidding. It shall be the Responder's responsibility to advise the Procurement Department via the County's electronic bidding platform if, in the Responder's opinion, any language, requirements, etc. inadvertently restricts or limits competition. Such notification must be submitted via the County's electronic bidding platform and must be received by the Procurement Department no later than the Deadline for Questions date and time stated above.

(THIS PAGE MUST BE RETURNED WITH YOUR RESPONSE)

• TABLE OF CONTENTS •

1. CONSULTANT PROFILE	PAGE 2
2. QUALIFICATIONS & EXPERIENCE	PAGE 4
3. STAFF QUALIFICATIONS & PROJECT TEAM	PAGE 6
4. PROJECT APPROACH	PAGE 8
5. QUALITY CONTROL	PAGE 12
6. RELATED EXPERIENCE & REFERENCES	PAGE 13
7. ATTACHMENTS	PAGE 16



G R O U P

ARCHITECTURE

INTERIORS

DESIGN BUILD SERVICES

- FRANK M. RINGHOFER, AIA ▪ JOSE M. PEREZ, CGC, AIA
- ALDO MINOZZI-FERNANDEZ, AIA ▪ RICARDO E. QUIÑONES, AIA
- CHRISTOPHER L. KAYE, AIA ▪ ROBERT D. HOENSHEL, AIA

December 7, 2021

Nassau County Board of County Commissioners
Evelyn Burton, Nassau County Procurement
Facilities Maintenance Department
96135 Nassau Place, Suite 2
Yulee, FL 32097

Re: Solicitation Number: NC21-052-RFQual-(RE-BID)
Nassau County Justice Center Courtroom #3 – Design Criteria Professional

Dear Ms. Burton:

Our Team of local Florida design firms have a passion for, and a rich history in the design of public facilities dedicated to the operations of government entities. We pride ourselves on our **commitment to the community** which is the foundation for our business. We would be honored to serve in support of Nassau County Board of County Commissioners in the enrichment and completion of Courtroom No. 3 at the Nassau County Courthouse.

SCOPE OF WORK

The project for the Criteria Architect will be to provide enough conceptual documentation of the proposed Courtroom remodeling to closely match the existing courtrooms with Judges bench, space for court reporting, bailiffs, jury box, public gallery and an arched coffered ceiling for Nassau County to secure competitive bids from a Design/Build firm or Joint Venture.

Much of the courtroom basics are already in place, such as the prisoner's elevator, holding area, HVAC separate Judge's access and public access. At the site review the only potential conflict that was noted was the existing sprinkler piping that would need to be adjusted for the new arched coffered ceiling. Additionally, one corner is taken up by the public restrooms.

Per the discussions at the site review it was reported that since the facility was not very old, that the drawings and specifications for the building were readily available. This should help us to be able to document the existing construction more closely for the Design/Build bid package.

We expect that the criteria document will include descriptions of energy efficient lighting (LED) to minimize operating costs going forward and updated technology to the latest standards.

QUALIFICATIONS

PQH and TLC Engineers (Team) represented here have all committed to **personally** collaborate in the service of preparing the Criteria Documents and following the project through Construction. This high level of participation is in account of the shared **passion and understanding** of and the value we place on our Judicial System. We would invite the board to review our qualifications with the understanding that many of these team members have already accomplished similar projects together in the state of Florida. We propose that our team will indeed benefit Nassau County through construction and completion of this project.

Our qualifications as Criteria Architect includes (3) projects for JEA where PQH provided 10% schematic plans to renovate facilities based on new technology, staffing and accessibility. The Criteria Package for the renovation of 17,803 sf for the Westside Service Center included, training rooms, manager offices, open office area, breakroom, restroom upgrades for accessibility and easier maintenance. The project also included more window openings to bring more natural light into the space.

The Criteria package for the renovation 13,360 sf for the Southside Service Center included similar elements noted above and also included an Assembly Area for large groups of employees and for Public gatherings.

The Criteria Package for the renovation of 14,380 sf of space for the JU Training Center started out as an evaluation of an existing property that JEA wanted to confirm that the property and existing building could accommodate their training needs for power poles, excavation welding, electric meter installation, classrooms and teachers offices. Additionally, we worked with St. Johns County on a Design/Bid/Build Contract to upgrade their existing Judicial Center with 2 phases where offices were relocated to accommodate Civil and Criminal Cases with offices for the Public Defender, Prosecutors, Clerk of Court and Courtroom Remodeling for two (2) Courtrooms. See attached floor plan. The above projects we feel make PQH an ideal fit to prepare the Criteria Documents for a Design/Build Contractors to bid on.

Our team's highlights include:

- **Experience** - Our team is comprised of industry leaders in the design of state of the art facilities such as emergency operation centers, fire departments and law enforcement stations. We understand how these facilities work: The need to prioritize functionality and safety while fostering a respect for our judicial system.
- **Commitment** - Our team members have served in the past as members and currently serve as board members to local community organizations such as the Police Athletic League among others. We understand the importance of getting involved and live by this standard.
- **Passion** - We love what we do and are committed to the development of our law enforcement and public safety officials. Our team has worked with each other on many projects and are intimately familiar with local conditions, construction trends, and contractors.

When you need us, we're here.

We look forward to assisting the Nassau County Board of Commissioners in the preparation and buildout of Courtroom #3. **We are committed to collaborate with your team to achieve your vision.** PQH along with our entire team, would like to thank you for your consideration of our qualifications.

Sincerely,

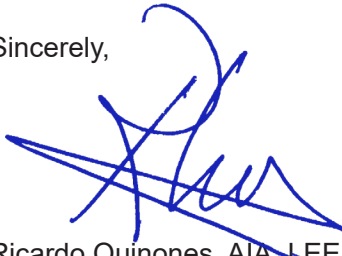
A handwritten signature in blue ink, appearing to read 'Ricardo Quinones', with a large, stylized 'X' or 'R' shape above it.

Ricardo Quinones, AIA, LEED AP® BD+C
President

A handwritten signature in blue ink, reading 'Robert D. Hoenshel'.

Robert D. Hoenshel, AIA
Project - Architect

1.

CONSULTANT PROFILE

CONSULTANT PROFILE

Legal Name:

PQH Group Design, Inc.

Address:

4141 Southpoint Drive East
Jacksonville, Florida 32216

Form of Ownership:

Private

Years in Business:

40 Years

Primary Contact:

Rob Hoenshel, AIA

P: 904.224.0001

F: 904.224.0023

E: hoenshelr@pqh.com

W: www.pqh.com

Firm Professional License #:

AR0009765

PQH GROUP... *By the Numbers*

#6 JBJ Top 25
Architectural Firms

Years of **39**
Continuous Service

80% Of Business from
repeat clients

Projects Designed **+\$40M**
Annually

PQH Group headquartered in Jacksonville Florida, is a Full Service Professional Design Firm with the knowledge and experience of providing professional design solutions to our local, state, and federal clients. Founded in 1982 by Jose Perez, AIA, CGC, PQH has grown to include six principals and a strong, committed support staff which includes Architects, Interior Designers, and General Contractors. With a history spanning over 40 years, PQH Group is Jacksonville's 6th largest Architectural Firm as ranked by JBJ. Our broad depth of experience, collaborative design approach, proactive leadership and emphasis on communication give us the capabilities to offer customized solutions for even the most demanding needs of our clients. We pride ourselves on providing personal attention to each client with key personal remaining with the project through completion.

With the addition on 3 new partners in the last 6 years, PQH looks forward to the future with the same drive and determination of the initial founders. Along with new partners come new ideas, new clients and new market areas that provide the foundation for the company to continue growing and taking on new challenges.

Awards Received by PQH



Embry Riddle Aeronautical
University, AZ 2018
AIA Jacksonville Winner 2018



First Federal Bank of Florida, 2010
U.S. Green Building Council Coalition



The Carling Apartments
Historic Preservation
Award Winner – City of
Jacksonville 2006
AIA Jacksonville
Winner, 2006



LETTERS OF RECOMMENDATION

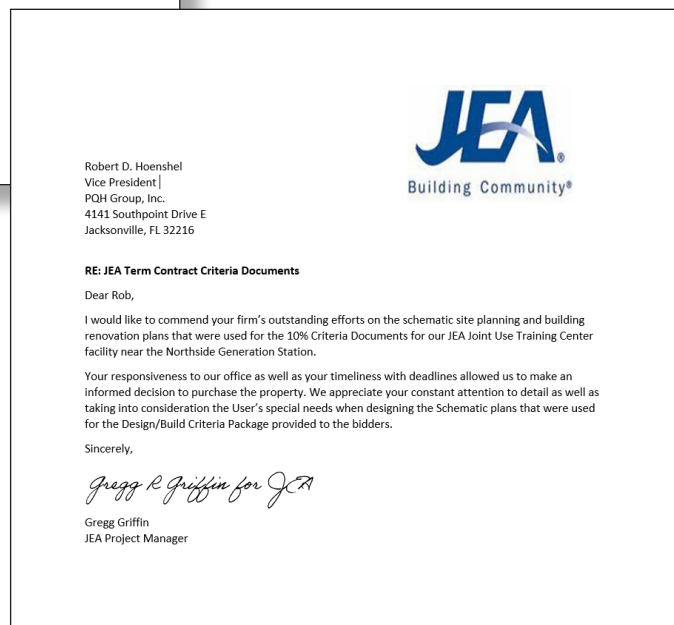
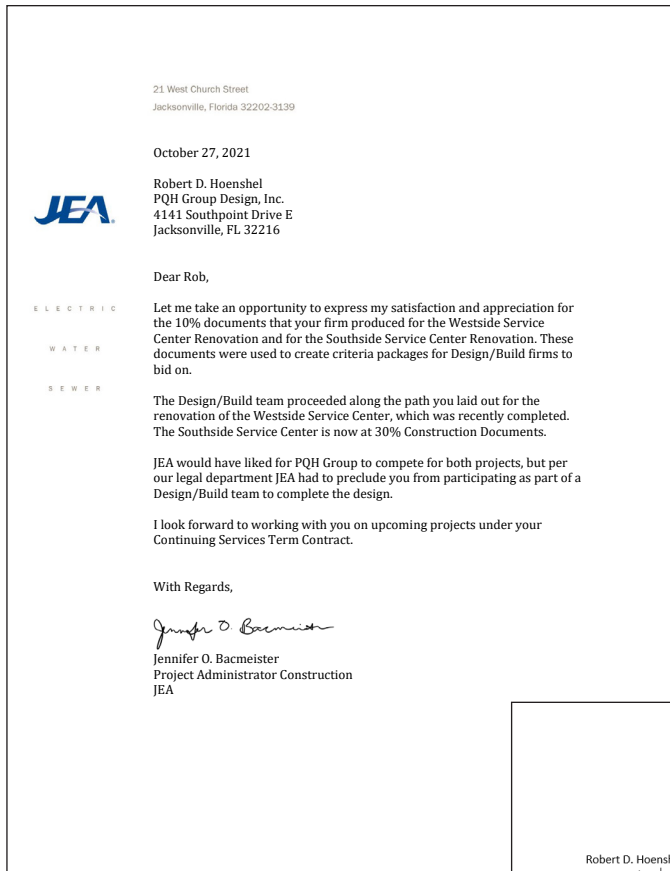

2.

**QUALIFICATIONS &
EXPERIENCE**

QUALIFICATIONS & EXPERIENCE

2A. PQH and other architectural firms are normally not in business to provide Design Criteria Packages, but we have worked on projects for JEA where we provided preliminary design services to determine the feasibility of locating various office and training functions within their existing properties and for properties they were looking to purchase. For JEA we met with the department heads and provided schematic and conceptual plans for the various departments to review, make comments and then incorporated those comments into a 30% design document that was referenced and incorporated into a Design/Build proposal package.

For the projects listed under Tab 6 each one received multiple submittals to provide Design/Build Services. The Westside Service Center has been completed and the other two, Southside Service Center and the Joint Use Training Center (JUTC) are in the early and last stages of design.

We were not provided with the information on the Guaranteed Maximum Price (GMP) and only know that JEA proceeded which is an indication that it was within their budget.

2B. Our experience on projects of similar scope was for the design for the St. Johns County Courthouse Complex that was constructed in two phases. The second phase included the design for two (2) Courtrooms to be built within the shell area similar to what is existing at the Nassau County Courthouse. For the St. Johns County Courthouse the plans developed were not designed to match the existing courtrooms but were laid out in accordance with the Judges wishes to have better eye contact with the jury so their bench was located in the corner of each courtroom. See Item A on the following page for the St. Johns County Courthouse floor plan.

2C. Our ability to communicate with the various department heads through the Project Manager is evident with the completed Office Remodeling for the Westside Service Center as there were only minimal changes required in the final design and construction.

2D. On projects that we design for construction, we are able to meet our clients budgets and schedules. We have an in-house Contractor on our staff that provides input on the budget and constructibility of our projects. The fact that 80% of our clients continue to work with us is a testament to our ability to meet budgets and schedules.

The CA process for this project will be headed by Roger Chastain, Construction Administration. He is a registered general contractor with over 20 years of industry experience. Our CA Team will work with the design and document production teams as well as the contractor in the areas of systems applicability/selection, constructibility, value engineering, cost control and schedule management. The CA Team is also responsible for the A/E's opinion of probable cost throughout the design process. Our CA's approach starts with the early and clear establishment of team objectives, responsibilities and communication procedures. PQH's Design and CA Team will be involved with your project from inception through its completion by performing constructibility reviews of working design documents as well as cost monitoring.

Item A: St. Johns County Courthouse



3.

**STAFF QUALIFICATIONS
& PROJECT TEAM**

PROJECT TEAM

The team represented in this proposal is committed to personally collaborate in service of the college for this project. We would like to invite you to review our qualifications with the understanding that many of the proposed team members have accomplished similar specific projects in the past.

Aldo Minozzi will be the Project Manager assigned to this project. Architectural support will include; Rob Hoenshel, Chris Boggess, and Roger Chastain. Structural, Mechanical, Electrical, Plumbing, Fire Protection and Technology Engineering will be provided by TLC Engineering, Inc.



Project Manager

Aldo Minozzi, AIA

Project Architect

Rob Hoenshel, AIA

Project Architect

Chris Boggess, AIA

Construction Administrator

Roger Chastain, CGC



Mechanical Engineer

Jeffrey Stone, PE, LEED AP

Plumbing/Fire Protection

Chadwick Schock

Electrical Engineer

Fredy Sarria, PE, LEED AP

Technology Engineer

Taw North, RCDD, LEED AP

Aldo Minozzi, AIA

Project Manager

*Years of Experience: 26 (6 with PQH)***Education**

Masters of Architecture, University of Puerto Rico School of Architecture

Bachelors of Environmental Design, University of Puerto Rico School of Architecture

Registration

Registered Architect, FL #98244 , PR #16724

**ALDO MINOZZI AIA,**

has a proven ability to impart a high level of professionalism and expertise to ensure objectives are met in the fastest, most efficient manner. His qualifications include a unique knowledge of all development phases within a project from initial client relationships to its final construction. He has demonstrated his capabilities and attention to cultural and environmental factors in order to create aesthetically functional designs.

Aldo's expertise includes renderings, presentations, 3-D graphics and tours, project design, specifications, and construction documents. Mr. Minozzi has tremendous artistic talent which combines favorably with his high level of technical expertise and industry knowledge

PROJECT EXPERIENCE**St. Johns County Continued Services***St. Johns County, FL***St. Johns County Warehouse Improvements***St. Johns County, FL***Quarry Storage Facility***Big Coppitt Key - Key West, FL***Municipality of Caguas - Office Building***Puerto Rico***Water and Sewer Authority of P.R. Operations Center***Puerto Rico***Jacksonville University Lazzara Renovation***Jacksonville, FL***Jacksonville University Lacrosse Field House***Jacksonville, FL***St. Joseph's Catholic Church Renovations***Jacksonville, FL***UNF Campus Architect Continued Services***Jacksonville, FL***St. Johns County School District Continued Service****Contract***St. Johns County, FL***North Florida School for Special Education***Jacksonville, FL***Jacksonville Classical Academy***Jacksonville, FL***Jacksonville University Health & Science Facility***Jacksonville, FL***Flagler College Campus Facilities Building***St. Augustine, FL***Jacksonville University Health & Science Facility***Jacksonville, FL***Daytona State Dormitories***Daytona Beach, FL***Flagler College Commons, Garage & Dormitory***Daytona Beach, FL*

Robert D. Hoenshel, AIA, LEED®AP BD+C

Project Architect

*Years of Experience: 48
(35 years with PQH)*

Education

BA, University of Florida

Registration

Registered Architect FL #7936

**ROBERT D. HOENSHEL, AIA, LEED®AP BD+C**

is Vice President, Principal for PQH. Rob also serves as Director of Production, responsible for the quality of documents and services produced by the firm. Mr. Hoenshel has an extensive background with public clients and has participated in each continuing contract that PQH has held over the past 16 years. He will be in charge of the technical aspects of building concepts and architectural elements for this project and will coordinate the efforts of the production staff.

PROJECT EXPERIENCE**Nassau County Courthouse Restoration**

Fernandina Beach, FL

**St. Johns County Courthouse Renovations
Phase 1 & 2**

St. Johns County, FL

Southside Substation

Jacksonville, FL

Randall Street Substation

Jacksonville, FL

Westside Service Center

Jacksonville, FL

Crew Shop-Sunbeam

Jacksonville, FL

Waterworks Building

Jacksonville, FL

**Feasibility Study for Training Facility at former
Coggin Dealership at Atlantic Blvd and Mill Creek
Road**

Jacksonville, FL

Breakroom Northside Generating Station

Jacksonville, FL

St. Johns County Administration Building

St. Johns County, FL

St. Johns County Continued Services Contract

St. Johns County, FL

St. Johns County Fire Station #5,9,11,15,16,18

St. Johns County, FL

St. Johns County Emergency Operations Center

St. Johns County

St. Johns County Warehouse Improvements

St. Johns County, FL

St. Johns County Anastasia Island Library

St. Johns County, FL

**City of Jacksonville Fire Station #21,
24,31,35,47,50,57,58,64,65**

Jacksonville, FL

**City of Jacksonville Fire and Rescue Facility,
Phases I, II, III**

Jacksonville, Florida

Chris Boggess, AIA

Project Architect

Years of Experience: 10

(5 years with PQH)

Education

Master of Architecture,
Southern Illinois University

Registration

Registered Architect, Florida AR100770



CHRISTOPHER BOGGESS, AIA, is involved in all stages of architectural design from design concept to completion of construction documentation. Allowing him to understand how BIM/ Revit will affect project workflows and project management throughout design to maximize its implementation for increased effectiveness. The primary responsibility is implementation, and enforcement on all related BIM projects, files and models. Chris' specialty is CADD/ Revit. He is responsible for providing code analysis, calculations, design documents, system studies and construction drawings.

PROJECT EXPERIENCE**JEA Continuing Services Contract**

Jacksonville, FL

City of Jacksonville Fire Station #65

Jacksonville, FL

Borland Groover Ambulatory Surgical Center & Outpatient Clinic

St. Augustine, FL

Flagler College Commons, Garage & Dormitory

Daytona Beach, FL

Volunteers for America Apartments

Jacksonville, FL

United States Navy (NavFac SE) USTWR & STARS at Naval Air Station

Jacksonville, FL

United States Navy (NavFac SE) Naval Ordnance Test Unit (NOTU) at Air Force Station

Jacksonville, FL

Quarry Storage Facility

Big Coppitt Key - Key West, FL

Jacksonville University Lazzara Renovation

Jacksonville, FL

Jacksonville University Health & Science Facility

Jacksonville, FL

Roger Chastain, CGC

Construction Administrator

Years of Experience: 36

(6 years with PQH)

Education

OSHA 10-HR Certified

OSHA 30-HR Certified

Registration

License: CGC1518354

Chair Commercial Builders Council of Jacksonville

**ROGER CHASTAIN, CGC,**

expertise incorporates full responsibility in cost control, value engineering, and time and quality assurance through both the design and construction phases of projects. Over the past twelve years in his role as a cost estimator and Construction Administrator, Mr. Chastain has overseen \$335 million in building construction. He is accountable for the oversight of project managers and their responsibilities in maintaining contractor/owner relationships, subcontractor control, budget maintenance, scheduling, submittal processing, and overall success of the project.

PROJECT EXPERIENCE**St. Johns County Administration Building**

St. Johns County, FL

Borland Groover Ambulatory Surgery Center & Outpatient Clinic

St. Augustine, FL

Flagler Commons & Garage

St. Augustine, FL

St. Joseph's Catholic Church

Jacksonville, FL

St. Joseph's Historic Church

Jacksonville, FL

Jacksonville Classical Academy

Jacksonville, FL

Embry Riddle Aeronautical University, Phase I, II, III

Daytona Beach, FL

The Arc of Jacksonville

Jacksonville, FL

Sulzabacher Community - Women's Center

Jacksonville, FL

Springfield Lofts

Jacksonville, FL

Ashley Square Apartments

Jacksonville, FL

Jacksonville University Health & Science Building

Jacksonville, FL

Jacksonville Classical Academy

Jacksonville, FL

North Florida School for Special Education

Jacksonville, FL

JEFFREY J. STONE, PE, LEED AP

Principal | Mechanical

BACKGROUND

Jeff has more than 18 years of extensive experience designing sophisticated mechanical and energy management systems. Jeff focuses on not only the initial building systems design, but also on the long-term functionality and efficiency for the users of the buildings that he engineers.

EXPERIENCE

Duval County Unified Courthouse, Jacksonville, Florida

Seven-story, design-build county courthouse. At the time of certification, the facility was the: Largest LEED NC-certified project in North Florida; Second largest LEED NC-certified project of any type in Florida; First LEED-certified county courthouse in Florida; Largest LEED-certified courthouse in the country. Certified LEED NC 2.2 Silver. \$181.5 million / 800,000 sf

East Hillsborough County Courthouse, Plant City, Florida

Two-story courthouse building with offices for the public defender, state attorney, sheriff's office, the Clerk of the Circuit Court, expanded courtroom space, secure staff parking and security enhancements. Certified LEED NC 2.2. \$13.5 million / 60,000 sf.

Fourth District Court of Appeals, West Palm Beach, Florida

New three-story courthouse with two-level, parking garage housing 350 cars, later redesigned for wall supported precast system rather than column support. LEED Registered. ENR Southeast 2018 Best Project, Government/Public Building. \$22.7 million / 150,000 sf (44,000 sf courthouse and 106,000 sf garage)

City of Tallahassee City Hall HVAC Renovations, Tallahassee, Florida

Replacement of air handling units and revision of zoning throughout the four-story facility. The upgrades are a result of recommendations made after TLC conducted an assessment of the HVAC system. \$1.2 million / 130,000 sf

Florida Department of Military Affairs Palm Coast Readiness Center, Palm Coast, Florida

New armory for the Florida National Guard to house reservists and Florida National Guard units including the 1-265th Air Defense Artillery Battalion. Certified LEED NC 2009 Silver. \$22.5 million / 76,708 sf

Leon County Elevator Upgrade, Tallahassee, Florida

Mechanical and electrical engineering for the replacement of two elevators in the existing courthouse complex.



EDUCATION

Auburn University
M.S., Mechanical Engineering
2003

Auburn University
B.S., Mechanical Engineering
1999

YEARS OF EXPERIENCE

TLC: 15 years
Prior: 3 years

REGISTRATIONS

PE FL 71466
PE GA PE037227

CERTIFICATIONS

LEED AP, GBCI

PROFESSIONAL AFFILIATIONS

ASHRAE, Member
Florida Healthcare Engineering
Association, Member

CHADWICK (CHAD) SCHOCK

Project Manager | Plumbing/Fire Protection | Senior Associate

BACKGROUND

Chad has provided plumbing/fire protection design for numerous complex projects. He has solid engineering analysis, design, and on-site construction administration experience in piping systems for water, wastewater, fuel oil, liquid gas, and natural gas. Chad is also experienced in the design and installation of fire pumps, clean-agent fire suppression systems, carbon dioxide, and foam systems.

EXPERIENCE

City of Jacksonville Sheriff's Office Gun Crime Intelligence Center, Jacksonville, Florida

Renovation of the unfinished area on the first floor of the State Attorney's Office Building. Spaces include open office area / collaborative space with modular workstations, enclosed offices, 20-person conference room, restrooms, breakroom and interview rooms. \$500,000 / 5,000 sf

Fourth District Court of Appeals, West Palm Beach, Florida

New three-story courthouse with two-level, parking garage housing 350 cars, later redesigned for wall supported precast system rather than column support. LEED Registered. ENR Southeast 2018 Best Project, Government/Public Building. \$22.7 million / 150,000 sf (44,000 sf courthouse and 106,000 sf garage)

Gainesville Police Department Headquarters, Gainesville, Florida

Delivered through design-build, the new two-story building is adjacent to a renovated 9,000-sf training center. Facility includes a sally port, holding cells, multiple meeting/briefing rooms, break room, gymnasium, and administrative spaces, and required extensive security measures. Facility is hurricane hardened with redundant systems. Certified LEED NC 2009 Silver. \$11.6 million / 67,800 sf

West Palm Beach Fire Station 5 and Emergency Operations Center, West Palm Beach, Florida

New two-story, three-bay fire station with integral Emergency Operations Center on the second floor complete with 911 call center, press conference room, and command center. Designed for 180 mph wind speed. \$9.5 million / 27,250 sf

Ft. Leavenworth - Utility Plant Building 344 Plumbing Study, Leavenworth, Kansas

Engineering Study to evaluate existing conditions for plumbing systems in the Utility Plant Building 344. 5,500 sf

JEA Headquarters Core & Shell, Jacksonville, Florida

New seven-story, Class A office building with enclosed offices and open office areas, conference rooms, visitor lobby and waiting area, cafeteria, break areas, support areas and interior and exterior collaborative spaces. Includes emergency operations center as well as substantial emergency power capabilities. Also includes an eight-level, 640-space parking garage with 30 electric charging stations. Designed to LEED v4 Core and Shell standards, targeting Gold certification. Pursuing WELL Core certification, with a goal of Bronze level certification. \$40 million / 160,000 sf



YEARS OF EXPERIENCE

TLC: 17 years

Prior: 12 years

FREDY SARRIA, PE, LEED AP

Principal | Electrical

BACKGROUND

Fredy's experience includes the design of power, lighting, voice/data, fire alarm system, electrical distribution, emergency power, intercom, lightning protection and security systems for educational, industrial, commercial, healthcare and governmental facilities. His experience also includes short circuit analysis, coordination studies and construction administration for a variety of projects.

EXPERIENCE

C. Clyde Atkins United States Courthouse, Miami, Florida

New 16-story building with 16 courtrooms and chambers; administrative offices, conference/training room, food services, detention areas, sally port, 50-space secure parking deck and 230-car parking deck. Security design with access control, CCTV, communications, intrusion detection, and command center. \$120.3 million / 540,000 sf.

City of Jacksonville Sheriff's Office Gun Crime Intelligence Center Jacksonville, Florida

Renovation of the unfinished area on the first floor of the State Attorney's Office Building. Spaces include open office area / collaborative space with modular workstations, enclosed offices, 20-person conference room, restrooms, breakroom and interview rooms. \$500,000 / 5,000 sf

City of Jacksonville, Old Federal Courthouse, Jacksonville, Florida

Interior fit out of 202,000 square feet of the existing historic federal courthouse to accommodate offices and support spaces for the state attorney. Included communications and technology engineering services and commissioning. Certified LEED NC 2009 \$2 million / 202,000 sf

Department of Military Affairs Armed Forces Reserve Center, Bunnell, Florida

New armory. \$21 million / 83,312 sf.

Federal Correctional Complex Fire Alarm Upgrade, Coleman, Florida

Upgrade fire alarm systems in multiple buildings to a new addressable fire alarm system with touchscreen computer operation. Design was prepared in five bid packages. Designed system incorporates beam detectors and is networked with ability to report all required alarm / trouble / supervisory conditions to a single location in each institution. \$3.1 million / 300,000 sf

USACE Ft. Worth District Unit Ops Hospital Operations Facility, Ft. Polk, Louisiana

Design-build delivery of a new attached administration facility (8,412 sf), Readiness Module (18,810 sf) and covered hardstand (4,656 sf). Designed to achieve LEED Silver. \$4 million / 31,878 sf



EDUCATION

Florida International University
B.S., Engineering
2001

YEARS OF EXPERIENCE

TLC: 16 years
Prior: 5 years

REGISTRATIONS

PE FL 86691
PE GA PE044435
PE KY 34930

CERTIFICATIONS

LEED AP, GBCI

PROFESSIONAL AFFILIATIONS

USGBC, Member

TAW NORTH, RCDD, LEED AP

Director of Technology | Technology | Principal

BACKGROUND

Taw has 20+ years of experience designing and commissioning low-voltage technology systems. Taw's expertise includes voice-data, security, access control systems, and AV systems specifically tailored to the unique demands of each facility. He works closely with owners to assure their project's technology and equipment goals are met and systems are fully operational upon occupancy. Taw has instructed BICSI accredited courses, authored various technical cabling papers, served as contributing author for a LAN design guide, and often speaks at industry conferences.

EXPERIENCE

Duval County Unified Courthouse, Jacksonville, Florida

Seven-story, design-build county courthouse. At the time of certification, the facility was the: Largest LEED NC-certified project in North Florida; Second largest LEED NC-certified project of any type in Florida; First LEED-certified county courthouse in Florida; Largest LEED-certified courthouse in the country. Certified LEED NC 2.2 Silver. \$181.5 million / 800,000 sf

Fourth District Court of Appeals, West Palm Beach, Florida

New three-story courthouse with two-level, parking garage housing 350 cars, later redesigned for wall supported precast system rather than column support. LEED Registered. ENR Southeast 2018 Best Project, Government/Public Building. \$22.7 million / 150,000 sf (44,000 sf courthouse and 106,000 sf garage)

Seminole County Five Points, Sanford, Florida

New design of a multi-story courthouse annex (104,223 sf), 450-space Garage structure, with 8,000 SF Sheriff's Office Support area (181,253 sf), CEP has 3,300 tons of capacity with the ability to expand to 4,200 tons of cooling capacity (9,582 sf)

Miami-Dade Civil Courthouse, Miami, Florida

New 23-story courthouse with 46 courtrooms, plus four additional shelled courtrooms. County's first social infrastructure P3 project. Target is LEED Silver certification. \$267 million / 607,000 sf

Old Federal Courthouse, Jacksonville, Florida

Interior fit out of 202,000 square feet of the existing historic federal courthouse to accommodate offices and support spaces for the state attorney. Included communications and technology engineering services and commissioning. Certified LEED NC 2009 \$2 million / 202,000 sf

Palm Beach County Courthouse / State Attorney and Public Defender Complex Security System Renewal and Replacement, West Palm Beach, Florida

Replacement and upgrade of electronics, security, life safety systems and critical communications infrastructure, including an expansion of the command center. \$14 million / 950,700 sf



EDUCATION

U.S. Military Academy, West Point
B.S., Mechanical Engineering
1995

YEARS OF EXPERIENCE

TLC: 15 years
Prior: 6 years

CERTIFICATIONS

LEED AP, GBCI
RCDD, BICSI

PROFESSIONAL AFFILIATIONS

Society of American Military
Engineers (SAME), Member

Florida Healthcare Engineering
Association (FHEA), Member

Healthcare Information and
Management Systems Society
(HIMSS), Member

FLORIDA PROFESSIONAL LICENSE

PQH LICENSES

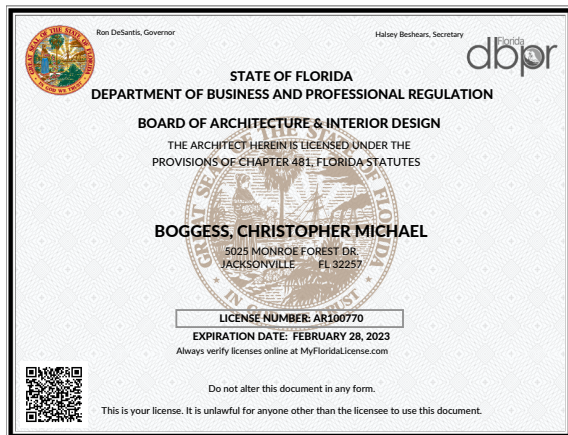
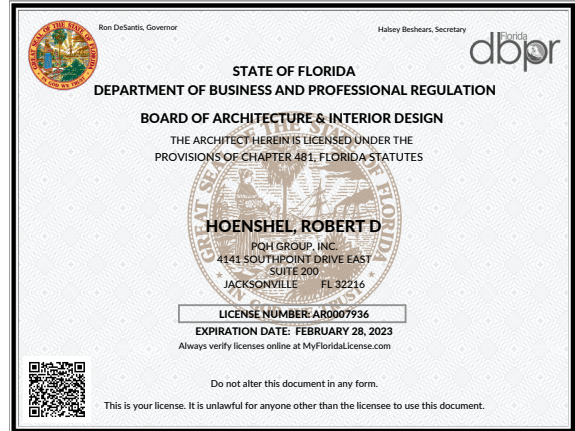

TLC LICENSES

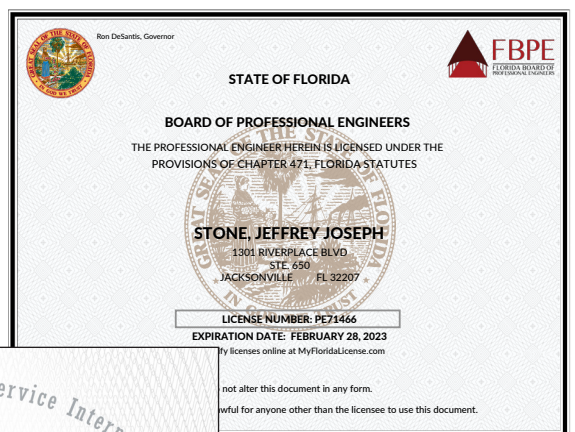
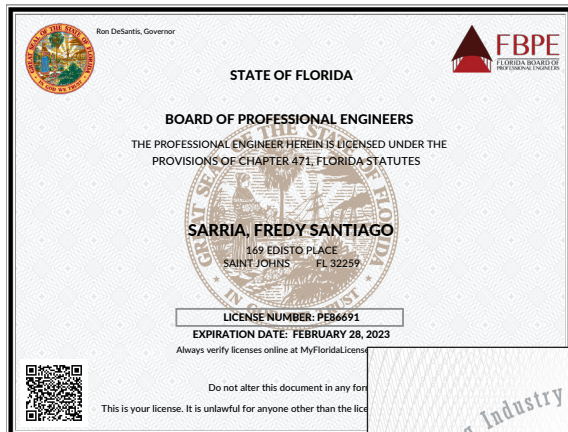

4.

PROJECT APPROACH

4A. Communications

The most important aspect in our Design Approach and Scope of Services is communication. We believe that our best Projects are those where the client's needs and aspirations are translated into a built reality in the form of Architecture. Our primary tasks are to listen and understand the Owner's and User's needs. Applying our knowledge and experience as tools we bring to the Owner to interpret his program needs and to realize the vision of what the project should look like.

As the Design Team Leader, PQH is responsible for the information management throughout the entire project starting during the initial programming, moving on to all phases of design and during construction. PQH utilizes industry standard system for managing information, document control and record keeping including project specific folders in various document management platforms such as;

- Share File
- BIM 360
- Procore



Once a project starts all information is sorted into categories and managed in the central file where the Owner; consultants and Contractor all can have access. Project information is logged in by Phase, Task and Date to facilitate tracking and includes periodic progress reports and project status.

Owner Communications

PQH understands its role as the Primary Source of Communication with the Owner's representative and/or Management Team. To that effect PQH will provide monthly status reports as well as milestone reporting at the conclusion of major tasks and upon completion of the construction phase of the project.

The PQH designated Project Manager with assistance from the lead design architect and engineer for the project will coordinate the orderly distribution of information and coordination of activities.

Nassau County Courthouse Approach

Our approach to this project would be to gather information on the existing courthouse documentation including drawings, specifications, shop drawings and change orders that impacted the existing courtrooms. We will meet with the County's Project Manager and users to determine if there are any problems or issues with any of the existing courtrooms that we could improve or correct. Through our engineers, we would seek to find out if there are any current technologies that were not available when the courthouse was built, but are available now. Once we have the input from the user we will get with our engineers to confirm the best way to incorporate any new technology. Our Project Management approach will be to have the information flow between the County's Project Manager and PQH's Product Architect. Notes from meetings will be distributed between the Project Manager and Project Architect for confirmation of the final decisions.

4B. Information Gathering & Programming

Our Design Process begins by listening to the Owner's Staff and Stakeholders goals and objectives, it is followed by assisting the Owner in quantifying and analyzing their program needs. After the Program Analysis is completed, we evaluate the Budget Parameters and verify that the Project Funding is in line with the Programmatic Needs and Aesthetic Objectives of the project. Throughout this interactive process, PQH is continuously exchanging input and feedback with the Owner to confirm the scope parameters for the Project. Our Design Process and Design Approach has allowed us to successfully deliver quality Architectural Design in a cost-efficient way for multiple clients.

Conceptual Design/ Master Planning

Based on the Owners overall program and objectives, a series of Conceptual Planning Design ideas are presented for review and consideration. From these conceptual ideas a preferred concept is selected for evaluation and development. The process of developing and refining the Concept Plan vision is the most important aspect of this phase of the project. Once the conceptual Plan is established they become the catalyst for all other design decisions, much like DNA in the development of life.

4B. Continued

By the conclusion of this phase the Owner has had the opportunity to select a Concept and Plan that can be translated into a working idea that can be developed into a building design.

Design and Documentation

During this Phase of Design, the Design Team articulates the selected concept into an Architectural Building envelope. The Floor plan is shaped to reflect the program needs and spatial adjacencies. The building volume is shaped along with its Aesthetic Character.

During this process, the Owner has the opportunity to review the architectural components of the building and provide input with regards to the program functions and spatial relationships. In addition, the exterior and interior character studies are discussed in an ongoing basis to assure that the Aesthetic Character and Branding of the exterior and interior are in line with the Owner's objectives and aspirations.

Code Compliance/ Permitting

PQH customarily meets with Plan Reviewers and Building Officials early in the Design to review Life Safety and any special building conditions that may require interpretation or clarification of code provisions to address any concerns, and to include specific information that document code compliance by reference to specific articles and sections in the Code during the permit review process. Customarily this proactive approach facilitates and expedites the permit review process to allow for a quick start to construction.



Construction Documents/ Design Reviews and Coordination

Once system selections are made and materials are selected, the final component is developing a comprehensive set of documents that coordinates all building elements into a cohesive design. This entails strict coordination between engineering disciplines to ensure build-ability and adherence to the project budget. The Owner is provided with updated plans at 60%, 90% and 100% to review for overall layout and provide specific input in detail areas such as millwork design, location of communication and power outlets, specialty aspects such as audio visual, lighting and other requirements.

As part of this phase, a binder of product cut sheets, including lighting and plumbing fixtures and other

specialty items are prepared to allow the Owner to review for appropriateness and aesthetic compatibility with the overall concept and budget parameters. The goal of this phase is to produce a set of documents that depict the Owner's vision in a concrete, tangible way that allows for permitting and bidding the project and ultimately constructing a building that correlates with the Owner's vision and objectives.

Construction of Occupied Facilities

PQH has worked on numerous renovation projects where the building was to remain in use and occupied. Some of those projects have been Offices/Commercial Buildings the courtroom buildout for St. Johns County.

PQH has also been involved in additions and renovations of schools where the buildings were to remain in use. For the St. Johns County courtrooms the work was scheduled in the evenings so as to not interrupt court proceedings in the adjacent courtrooms and offices. In most instances a bulk of the construction is scheduled to take place over the summer. Then in project is phased to allow construction to proceed in certain areas while other areas remained occupied. The objectives for this are many and include; Security and Separation of judicial proceedings from the noise of construction from workers.

- Environmental controls for systems and dust control
- Life safety measures to ensure safety of both judicial staff, jurors and workers.

Nassau County Courthouse Approach

PQH's Project Manager will gather relevant plans, specifications and shop drawings from the County's Archives. PQH's Project Architect and Project Manager will meet with the user and determine what can be improved in the new Courtroom. PQH will then meet with our engineers to determine the best way to incorporate what the County wants we will have our in house Contractor prepare an Opinion of Probable Cost (OPC) to share with the County. We would then meet with the County to review how we can achieve the desired results including the associated costs. Once the Scope and OPC are accepted we will advance the production of the Criteria Documents and instructions for the Design/Build firms.

4C. We propose to use TLC Engineering as follows:

- To confirm that the existing fire sprinkler system will accommodate the new courtroom and adjacent spaces.
- To review and confirm that there is sufficient electrical capacity to provide power and lighting for the courtroom and adjacent spaces.
- To confirm that communication, data and fire alarm systems can be incorporated into the Criteria Documents.
- To document the information and provide a written description of the work that will be required for the Design/Build firm to include in their Bid.

4D. From our experience with the additions and renovations for the St. Johns County Courthouse it was beneficial to have the contractor do the courtroom buildout at night so that the noise generated by the construction would not disrupt any court proceedings going on in the adjacent courtrooms. There were no added overtime costs as the superintendent and labors 8 hour work day was during the night and only



PQH Group takes its role as a full service design firm very seriously. We understand the importance of relationships and embrace the collaborative design process and project approach. We believe a successful project is one in which the voices of collaboration sing harmoniously and loud. We pride ourselves on our ability to integrate the multiple facets of a highly performing team in each of our projects to create **Firmness** (*durability*), **Commodity** (*economical*) and **Delight** (*aesthetic wonder*).

We understand and value the unique perspective and expertise team members **contribute** to each project toward its successful realization. For the full team to succeed its parts come together much in the same way the instruments of an orchestra perform and dialogue with each other. Not a cacophony of noise; but a triumphant symphony of wonder where each element complements and pushes the other to greater achievement. While this team approach does not manifest itself in the moment with notes, it is realized by the often subtle manipulation of space; light, shadow, and texture that is a result of the collaborative discussion. The maturity of these discussions continuously shape our approach to **maximize each others strengths** with the philosophy that no one can do it alone.

We Listen, We Plan, We're here for you.

5.

QUALITY CONTROL

QUALITY CONTROL

DESIGN PHASE

During the design phase, the focus is on attaining quality by achieving conformance to requirements when work is first performed, while during the construction phase, more traditional technical means of monitoring conformance are applied. Critical quality elements of each project are identified and technical measures of conformance are then applied according to a specific and detailed quality control plan designed for that project. As in the design phase, the focus is on attaining quality by achieving conformance to requirements when work is first performed.

QUALITY CONTROL CHECKLIST REPORT

Prepared by our Construction Administrator to monitor and report field activities - including:

- Review of specified project submittals/shop drawing for general conformance
- Site observation visits and reports during construction, on a weekly or as-needed basis
- Compliance with schedule and other general conditions
- Review of contractor's requests for information
- Review of contractor's applications for payment per the schedule of values
- Prepare Punchlist
- Final inspection

POST CONSTRUCTION PHASE

These services usually start after substantial completion has been achieved; however, in many situations where the Owner needs to occupy parts of the facility as they become available (Beneficial Occupancy) this post construction period may span various phases of construction. The usual tasks include:

- Punch List Preparation
- Assistance with Occupancy and Start Up
- Assistance with Guaranteed Performance Issues
- Maintenance, Warranty and Operating Personnel Program
- Assembling all Close-out Documentation
- Final Completion Inspections
- Assistance with Warranty Period Issues
- One year Warranty Inspection

6.

**RELATED EXPERIENCE
& REFERENCES**

1) JEA Westside Service Center

Jacksonville, Florida



The scope for this project includes design for office renovations, and provide 30% concept documents that utilized JEA standards to be used for bidding as design/build criteria documents.

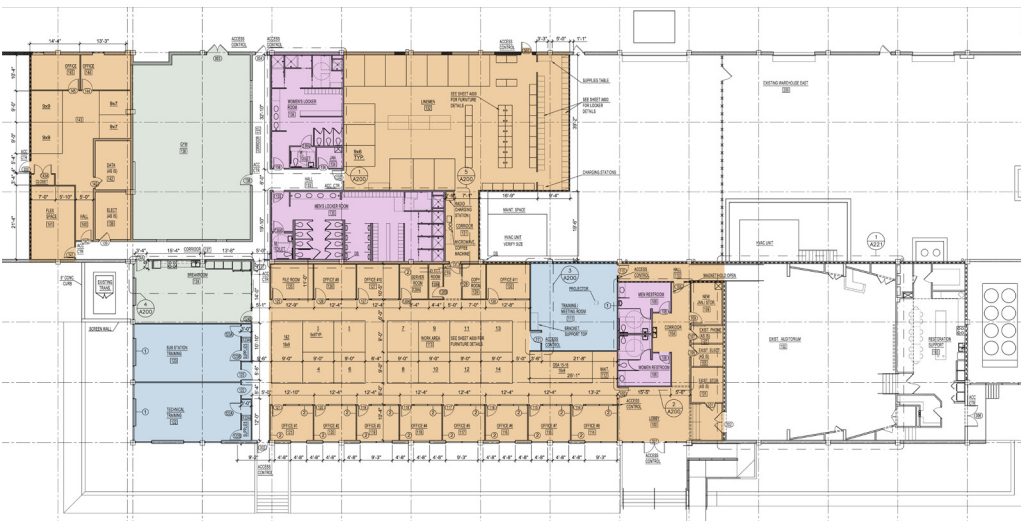

Project Information:

Size: 17,803 SF

Cost: \$4.7 Million

Date Completed: 2021

Client: Public

Contact:

Jennifer Bacmeister, PMP

21 West Church Street

Jacksonville, FL 32202

904-665-4656

stokjl@jea.com

Services of team members:

Architecture/Interior Design

Principal-in-Charge

Rob Hoenshel, AIA, LEED

Relevance:

- Design Criteria Package
- Programming/Space Eval.
- Economic Analyses
- Assessments & Studies
- Charrettes



Jacksonville, Florida



Project Information:

Size: 13,360 SF

Cost: Budget: \$4.5-\$5 Million

Contact:

Jennifer Bacmeister, PMP

21 West Church Street

Jacksonville, FL 32202
904.445.4454

904-665-4656
stokjl@jea.com

Services of team members:

Architecture/Interior Design

Principal-in-Charge

Relevance:

- Design Criteria Package
- Programming/Space Eval.
- Economic Analyses
- Assessments & Studies
- Charrettes

The criteria package for the renovation of 13,360 sf for the Southside Service Center included similar elements to those for the Westside Service Center and also included an Assembly area for large groups of employees and for public gatherings. Construction documents are now 30% complete.

Jacksonville, Florida

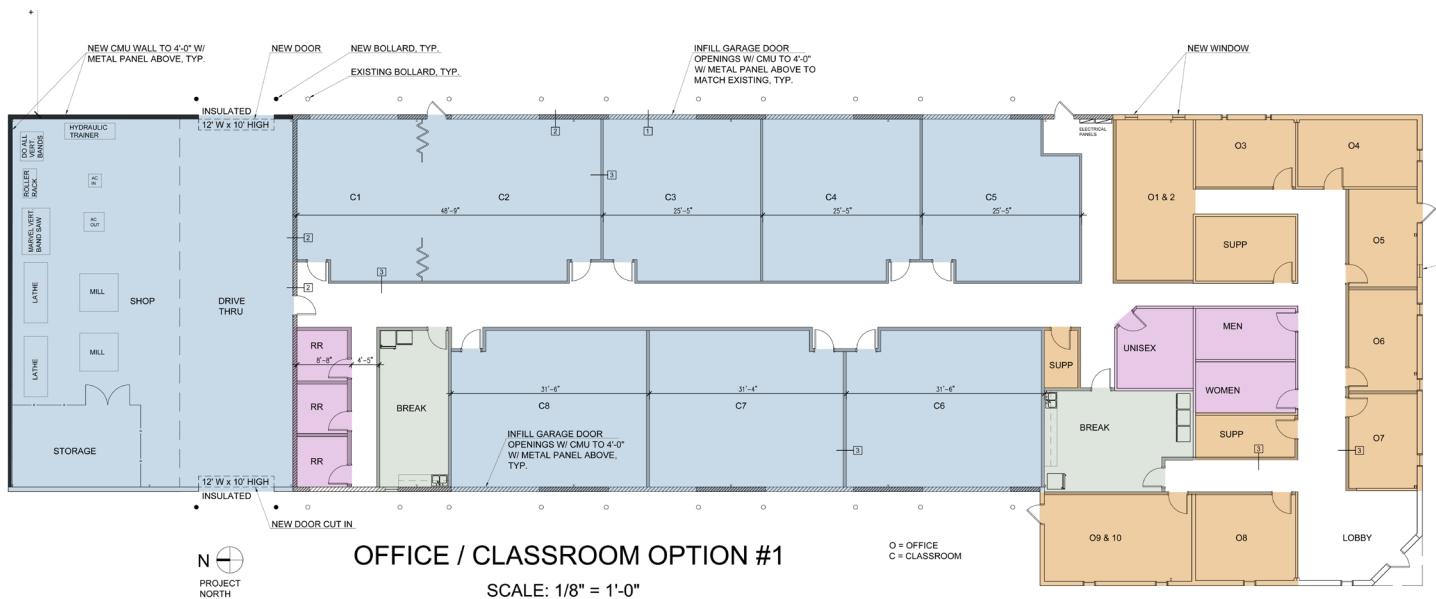

The criteria package for the renovation of 20,639sf of space for the JU Training Center started out as an evaluation of an existing property that JEA wanted to confirm that the property and existing building could accommodate their training needs for power poles, excavation welding, electric meter installation, classrooms, and teachers offices.

Project Information:

Size: 14,380 SF
Cost: Budget: \$5.2 Million
Date Completed: 2021
Client: Public
Contact:
Greg Griffin
21 West Church Street
Jacksonville, FL 32202
904-665-4656
grifgr@jea.com

Services of team members:

Architecture/Interior Design
Principal-in-Charge
Rob Hoenshel, AIA, LEED

Relevance:

- Design Criteria Package
- Programming/Space Eval.
- Economic Analyses
- Assessments & Studies
- Charrettes

7.

ATTACHMENTS

ADDENDUM ACKNOWLEDGMENT

NASSAU COUNTY REQUEST FOR QUALIFICATIONS
NC21-052-RFQual (RE-BID) - NCJC COURTROOM 3
DESIGN CRITERIA PROFESSIONAL

ATTACHMENT "C"
ADDENDA ACKNOWLEDGMENT

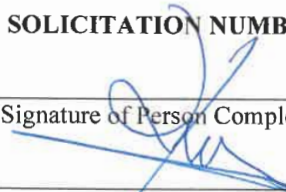
Acknowledgment is hereby made of receipt of addenda issued during the solicitation period. SOLICITATION NUMBER: NC21-052-RFQual	Addendum # <u>1</u> through # <u>1</u> Date: 12/06/21
Signature of Person Completing: 	
Printed Name: RICARDO QUINONES	Title: President

>>>Failure to submit this form may disqualify your response<<<

Addendum #1 from November 12, 2021 about the Statement of Bondability

PUBLIC ENTITIES CRIMES STATEMENT

NASSAU COUNTY REQUEST FOR QUALIFICATIONS NC21-052-RFQual (RE-BID) - NCJC COURTROOM 3 DESIGN CRITERIA PROFESSIONAL

ATTACHMENT "D" SWORN STATEMENT UNDER FLORIDA STATUTE 287.133(3)(a) ON PUBLIC ENTITY CRIMES

TO BE RETURNED WITH BID

THIS MUST BE SIGNED IN THE PRESENCE OF A NOTARY PUBLIC OR OTHER OFFICER
AUTHORIZED TO ADMINISTER OATHS

1. This sworn statement is submitted with Bid, Proposal or Contract for Nassau County Justice Center Courtroom #3 Design Criteria Professional (RE-BID).
2. This sworn statement is submitted by POH Group Design, Inc. (entity submitting sworn statement), whose business address is 4141 Southpoint Drive East Suite 200 Jacksonville, FL 32216 and its Federal Employee Identification Number (FEIN) is 47-2933964. (If the entity has no FEIN, include the Social Security Number of the individual signing this sworn statement: _____.)
3. My name is Ricardo Quiñones, AIA, LEED AP BD+C (please print name of individual signing), and my relationship to the entity named above is President.
4. I understand that a "public entity crime" as defined in Paragraph 287.133(1)(g), Florida Statutes, means a violation of any state or federal law by a person with respect to and directly related to the transaction of business with any public entity or with an agency or political subdivision of any other state or with the United States, including, but not limited to, any bid or contract for goods or services, any leases for real property, or any contract for the construction or repair of a public building or public work, to be provided to any public entity or an agency or political subdivision of any other state or of the United States and involving antitrust, fraud, theft, bribery, collusion, racketeering, conspiracy, or material misrepresentation.
5. I understand that "convicted" or "conviction" as defined in paragraph 287.133(1)(b), Florida Statutes, means a finding of guilt or a conviction or a public entity crime, with or without an adjudication of guilt, in any federal or state trial court of record relating to charges brought by indictment or information after July 1, 1989, as a result of a jury verdict or a plea of guilty or nolo contendere.
6. I understand that an "affiliate" as defined in paragraph 287.133(1)(c) includes:
 - a) A predecessor or successor of a person convicted of a public entity crime.
 - b) An entity under the control of any natural person who has been convicted of a public entity crime. This includes those officers, directors, executives, partners, members, and agents who are active in the management of the entity and who have been convicted of a public entity crime. A person who knowingly enters into a joint venture or pooling of equipment or income among persons when an arm's length agreement, shall be prima facie case that the person is an affiliate. A person who knowingly enters into a joint venture or pooling of equipment or income among persons when an arm's length agreement, shall be prima facie case that the person is an affiliate. A person who knowingly enters into a joint venture or pooling of equipment or income among persons when an arm's length agreement, shall be prima facie case that the person is an affiliate.
7. I understand that a "person" as defined in Paragraph 287.133(1)(d), Florida Statutes, means a natural person or entity organized under the laws of any state or of the United States and which bids or applies to bid for, or which otherwise transacts or applies to transact business with, a public entity, or which otherwise transacts or applies to transact business with, a public entity, or which otherwise transacts or applies to transact business with, a public entity. "person" includes those officers, directors, executives, partners, members, and agents who are active in management of an entity.

NASSAU COUNTY REQUEST FOR QUALIFICATIONS NC21-052-RFQual (RE-BID) - NCJC COURTROOM 3 DESIGN CRITERIA PROFESSIONAL

8. Based on information and belief, the statement, which I have marked below, is true in relation to the entity submitting this sworn statement. (Please indicate which statement applies.)

☒ Neither the entity submitting this sworn statement, nor any of its officers, directors, executives, partners, shareholders, employees, members, or agents who are active in management of the entity, nor any affiliate of the entity have been charged with and convicted of a public entity crime subsequent to July 1, 1989.

_____. The entity submitting this sworn statement, or one of more of the officers, directors, executives, partners, shareholders, employees, members, or agents who are active in management of the entity, or an affiliate of the entity has been charged with and convicted of a public entity crime subsequent to July 1, 1989, and (Please indicate which additional statement applies.)

_____. There has been a proceeding concerning the conviction before a hearing officer of the State of Florida, Division of Administrative Hearings. The final order entered by the Hearing Officer did not place the person or affiliate on the convicted vendor list. (Please attach a copy of the final order.)

_____. The person or affiliate was placed on the convicted vendor list. There has been a subsequent proceeding before a hearing officer of the State of Florida, Division of Administrative Hearings. The final order entered by the hearing officer determined that it was in the public interest to remove the person or affiliate from the convicted vendor list. (Please attach a copy of the final order.)

_____. The person or affiliate has not been placed on the convicted vendor list. (Please describe any action taken by or pending with the Department of General Services.)

Signature
12/06/21
Date

State of: Florida
County of: Duval

Sworn to (or affirmed) and subscribed before me by means of ☒ physical presence or _____ online notarization, this 6 day of December, 2021 by Ricardo E. Quiñones who is ☒ personally known to me or _____ produced _____ as identification.

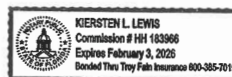

Kiersten L. Lewis
Notary Public
My commission expires 2-3-26

DRUG FREE WORKPLACE

NASSAU COUNTY REQUEST FOR QUALIFICATIONS NC21-052-RFQual (RE-BID) - NCJC COURTROOM 3 DESIGN CRITERIA PROFESSIONAL

ATTACHMENT "E" DRUG FREE WORKPLACE CERTIFICATE

I, the undersigned, in accordance with Florida Statute 287.087, hereby certify that _____
PQH Group Design, Inc. (print or type name of firm)

1. Publishes a written statement notifying that the unlawful manufacture, distribution, dispensing, possession or use of a controlled substance in the workplace named above, and specifying actions that will be taken against violations of such prohibition.
2. Informs employees about the dangers of drug abuse in the workplace, the firm's policy of maintaining a drug free working environment, and available drug counseling, rehabilitation, and employee assistance programs, and the penalties that may be imposed upon employees for drug use violations.
3. Gives each employee engaged in providing commodities or contractual services that are under bid or proposal, a copy of the statement specified above.
4. Notifies the employees that as a condition of working on the commodities or contractual services that are under bid or proposal, the employee will abide by the terms of the statement and will notify the employer of any conviction of, plea of guilty or nolo contendere to, any violation of Chapter 1893, or any controlled substance law of the State of Florida or the United States, for a violation occurring in the work place, no later than five (5) days after such conviction, and requires employees to sign copies of such written statement to acknowledge their receipt.
5. Imposes a sanction on, or requires the satisfactory participation in, a drug abuse assistance or rehabilitation program, if such is available in the employee's community, by any employee who is so convicted.
6. Makes a good faith effort to continue to maintain a drug free workplace through the implementation of a drug free workplace program.

"As a person authorized to sign a statement, I certify that the above-named business, firm, or corporation complies fully with the requirements set forth herein."

Authorized Signature

12/06/21

Date Signed

NASSAU COUNTY REQUEST FOR QUALIFICATIONS NC21-052-RFQual (RE-BID) - NCJC COURTROOM 3 DESIGN CRITERIA PROFESSIONAL

State of: Florida
County of: Duval

The foregoing, a Drug Free Workplace Certificate, was sworn to (or affirmed) and subscribed before me by means of ☒ physical presence or ☐ online notarization, this 6 day of December, 2021, by Ricardo E. Quirones who is ☒ personally known to me or ☐ produced _____ as identification.



Kiersten L. Lewis
Notary Public

My commission expires: 2-3-26

CERTIFICATE OF INSURANCE



CERTIFICATE OF LIABILITY INSURANCE

DATE (MM/DD/YYYY)
01/19/2021

THIS CERTIFICATE IS ISSUED AS A MATTER OF INFORMATION ONLY AND CONFERS NO RIGHTS UPON THE CERTIFICATE HOLDER. THIS CERTIFICATE DOES NOT AFFIRMATIVELY OR NEGATIVELY AMEND, EXTEND OR ALTER THE COVERAGE AFFORDED BY THE POLICIES BELOW. THIS CERTIFICATE OF INSURANCE DOES NOT CONSTITUTE A CONTRACT BETWEEN THE ISSUING INSURER(S), AUTHORIZED REPRESENTATIVE OR PRODUCER, AND THE CERTIFICATE HOLDER.

IMPORTANT: If the certificate holder is an ADDITIONAL INSURED, the policy(ies) must have ADDITIONAL INSURED provisions or be endorsed. If SUBROGATION IS WAIVED, subject to the terms and conditions of the policy, certain policies may require an endorsement. A statement on this certificate does not confer rights to the certificate holder in lieu of such endorsement(s).

PRODUCER Denny Doyle, Jr., Agent 7807 Baymeadows Rd E Suite 100 Jacksonville FL 32256	CONTACT NAME: Bonnie Skaggs PHONE (A/C, No., Ext.): 904-737-3777 FAX (A/C, No.): 904-737-0363 E-MAIL ADDRESS: bonnie.skaggs.p3hv@dennydoyle.com INSURER(S) AFFORDING COVERAGE: INSURER A: State Farm Florida Insurance Company INSURER B: INSURER C: INSURER D: INSURER E: INSURER F:
---	--

INSURED PQH Group, Inc.
PQH Group Design, Inc.
4141 Southpoint Dr E, Suite 200
Jacksonville FL 32216

COVERAGES **CERTIFICATE NUMBER:** **REVISION NUMBER:**

THIS IS TO CERTIFY THAT THE POLICIES OF INSURANCE LISTED BELOW HAVE BEEN ISSUED TO THE INSURED NAMED ABOVE FOR THE POLICY PERIOD INDICATED. NOTWITHSTANDING ANY REQUIREMENT, TERM OR CONDITION OF ANY CONTRACT OR OTHER DOCUMENT WITH RESPECT TO WHICH THIS CERTIFICATE MAY BE ISSUED OR MAY PERTAIN, THE INSURANCE AFFORDED BY THE POLICIES DESCRIBED HEREIN IS SUBJECT TO ALL THE TERMS, EXCLUSIONS AND CONDITIONS OF SUCH POLICIES. LIMITS SHOWN MAY HAVE BEEN REDUCED BY PAID CLAIMS.

INSR LTR	TYPE OF INSURANCE	ADDITIONAL INSURED	POLICY NUMBER	POLICY EFF (MM/DD/YYYY)	POLICY EXP (MM/DD/YYYY)	LIMITS
	COMMERCIAL GENERAL LIABILITY <input type="checkbox"/> CLAIMS-MADE <input type="checkbox"/> OCCUR <input type="checkbox"/> GEN'L AGGREGATE LIMIT APPLIES PER: <input type="checkbox"/> POLICY <input type="checkbox"/> PRO. SECT <input type="checkbox"/> LOC <input type="checkbox"/> OTHER					EACH OCCURRENCE DAMAGE TO RENTED PREMISES (Ea occurrence) MED EXP (Per person) PERSONAL & AD&J INJURY GENERAL AGGREGATE PRODUCTS - COMP/OP AGG
A	AUTOMOBILE LIABILITY <input checked="" type="checkbox"/> ANY AUTO <input checked="" type="checkbox"/> OWNED AUTOS ONLY <input checked="" type="checkbox"/> HIRED AUTOS ONLY <input checked="" type="checkbox"/> Comp 250 <input checked="" type="checkbox"/> SCHEDULED AUTOS <input checked="" type="checkbox"/> NON-OWNED AUTOS ONLY <input checked="" type="checkbox"/> Coll 500	X X	E22 4470-C09-59C E89 1664-B27-59B 262 0504-C11-59Q	03/09/2021 02/24/2021 03/11/2021	03/09/2022 02/24/2022 03/11/2022	COMBINED SINGLE LIMIT (Ea accident) BODILY INJURY (Per person) BODILY INJURY (Per accident) PROPERTY DAMAGE (Per accident)
	UMBRELLA LIAB <input type="checkbox"/> EXCESS LIAB <input type="checkbox"/> OCCUR <input type="checkbox"/> CLAIMS-MADE <input type="checkbox"/> RETENTIONS					EACH OCCURRENCE AGGREGATE
	WORKERS COMPENSATION AND EMPLOYERS' LIABILITY ANY PROPRIETOR/PARTNER/EXECUTIVE OFFICER/OWNER EXCLUDED? (Mandatory in NH) If yes, describe under DESCRIPTION OF OPERATIONS below	Y/N	N/A			<input type="checkbox"/> FOR STATUTE <input type="checkbox"/> OTHER E.L. EACH ACCIDENT E.L. DISEASE - EA EMPLOYEE E.L. DISEASE - POLICY LIMIT

DESCRIPTION OF OPERATIONS / LOCATIONS / VEHICLES (ACORD 101, Additional Remarks Schedule, may be attached if more space is required)

CERTIFICATE HOLDER FOR PROPOSAL PURPOSES	CANCELLATION SHOULD ANY OF THE ABOVE DESCRIBED POLICIES BE CANCELLED BEFORE THE EXPIRATION DATE THEREOF, NOTICE WILL BE DELIVERED IN ACCORDANCE WITH THE POLICY PROVISIONS. AUTHORIZED REPRESENTATIVE
--	--

CERTIFICATE OF INSURANCE

Client#: 1048774		PQHGR0															
ACORD™		CERTIFICATE OF LIABILITY INSURANCE															
		DATE (MM/DD/YYYY) 6/08/2021															
<p>THIS CERTIFICATE IS ISSUED AS A MATTER OF INFORMATION ONLY AND CONFERS NO RIGHTS UPON THE CERTIFICATE HOLDER. THIS CERTIFICATE DOES NOT AFFIRMATIVELY OR NEGATIVELY AMEND, EXTEND OR ALTER THE COVERAGE AFFORDED BY THE POLICIES BELOW. THIS CERTIFICATE OF INSURANCE DOES NOT CONSTITUTE A CONTRACT BETWEEN THE ISSUING INSURER(S), AUTHORIZED REPRESENTATIVE OR PRODUCER, AND THE CERTIFICATE HOLDER.</p> <p>IMPORTANT: If the certificate holder is an ADDITIONAL INSURED, the policy(ies) must have ADDITIONAL INSURED provisions or be endorsed. If SUBROGATION IS WAIVED, subject to the terms and conditions of the policy, certain policies may require an endorsement. A statement on this certificate does not confer any rights to the certificate holder in lieu of such endorsement(s).</p>																	
PRODUCER USI Insurance Services, LLC 2502 N Rocky Point Drive Suite 400 Tampa, FL 33607		CONTACT NAME: PHONE (A/C, No, Ext): 813 321-7500 FAX (A/C, No): E-MAIL ADDRESS: <table border="1" style="width: 100%; border-collapse: collapse;"> <tr> <th style="width: 80%;">INSURER(S) AFFORDING COVERAGE</th> <th style="width: 20%;">NAIC #</th> </tr> <tr> <td>INSURER A : Phoenix Insurance Company</td> <td>25623</td> </tr> <tr> <td>INSURER B : Travelers Property Cas. Co. of America</td> <td>25674</td> </tr> <tr> <td>INSURER C : Travelers Casualty and Surety Company</td> <td>19038</td> </tr> <tr> <td>INSURER D : Capitol Specialty Insurance Corporation</td> <td>10328</td> </tr> <tr> <td>INSURER E :</td> <td></td> </tr> <tr> <td>INSURER F :</td> <td></td> </tr> </table>		INSURER(S) AFFORDING COVERAGE	NAIC #	INSURER A : Phoenix Insurance Company	25623	INSURER B : Travelers Property Cas. Co. of America	25674	INSURER C : Travelers Casualty and Surety Company	19038	INSURER D : Capitol Specialty Insurance Corporation	10328	INSURER E :		INSURER F :	
INSURER(S) AFFORDING COVERAGE	NAIC #																
INSURER A : Phoenix Insurance Company	25623																
INSURER B : Travelers Property Cas. Co. of America	25674																
INSURER C : Travelers Casualty and Surety Company	19038																
INSURER D : Capitol Specialty Insurance Corporation	10328																
INSURER E :																	
INSURER F :																	
INSURED PQH Group, Inc. & PQH Group Design, Inc. 4141 Southpoint Drive East #200 Jacksonville, FL 32216																	
COVERAGES		CERTIFICATE NUMBER:															
		REVISION NUMBER:															
<p>THIS IS TO CERTIFY THAT THE POLICIES OF INSURANCE LISTED BELOW HAVE BEEN ISSUED TO THE INSURED NAMED ABOVE FOR THE POLICY PERIOD INDICATED. NOTWITHSTANDING ANY REQUIREMENT, TERM OR CONDITION OF ANY CONTRACT OR OTHER DOCUMENT WITH RESPECT TO WHICH THIS CERTIFICATE MAY BE ISSUED OR MAY PERTAIN, THE INSURANCE AFFORDED BY THE POLICIES DESCRIBED HEREIN IS SUBJECT TO ALL THE TERMS, EXCLUSIONS AND CONDITIONS OF SUCH POLICIES. LIMITS SHOWN MAY HAVE BEEN REDUCED BY PAID CLAIMS.</p>																	
INSR LTR	TYPE OF INSURANCE	ADDL INSR	SUBR WVD	POLICY NUMBER	POLICY EFF (MM/DD/YYYY)	POLICY EXP (MM/DD/YYYY)	LIMITS										
A	<input checked="" type="checkbox"/> COMMERCIAL GENERAL LIABILITY <input type="checkbox"/> CLAIMS-MADE <input checked="" type="checkbox"/> OCCUR GEN'L AGGREGATE LIMIT APPLIES PER: <input type="checkbox"/> POLICY <input checked="" type="checkbox"/> PRO-JECT <input type="checkbox"/> LOC OTHER:	X	X	6800J939206	05/15/2021	05/15/2022	EACH OCCURRENCE \$2,000,000 DAMAGE TO RENTED PREMISES (Ea occurrence) \$1,000,000 MED EXP (Any one person) \$10,000 PERSONAL & ADV INJURY \$2,000,000 GENERAL AGGREGATE \$4,000,000 PRODUCTS - COMP/OP AGG \$4,000,000 \$										
	AUTOMOBILE LIABILITY <input type="checkbox"/> ANY AUTO <input type="checkbox"/> OWNED AUTOS ONLY <input type="checkbox"/> SCHEDULED AUTOS <input type="checkbox"/> HIRED AUTOS ONLY <input type="checkbox"/> NON-OWNED AUTOS ONLY						COMBINED SINGLE LIMIT (Ea accident) \$ BODILY INJURY (Per person) \$ BODILY INJURY (Per accident) \$ PROPERTY DAMAGE (Per accident) \$ \$										
B	<input checked="" type="checkbox"/> UMBRELLA LIAB <input checked="" type="checkbox"/> OCCUR <input type="checkbox"/> EXCESS LIAB <input type="checkbox"/> CLAIMS-MADE <input type="checkbox"/> DED <input checked="" type="checkbox"/> RETENTION \$10,000	X	X	CUP4E109717	05/15/2021	05/15/2022	EACH OCCURRENCE \$2,000,000 AGGREGATE \$2,000,000 \$										
C	WORKERS COMPENSATION AND EMPLOYERS' LIABILITY ANY PROPRIETOR/PARTNER/EXECUTIVE OFFICER/MEMBER EXCLUDED? <input type="checkbox"/> Y / <input checked="" type="checkbox"/> N (Mandatory in NH) If yes, describe under DESCRIPTION OF OPERATIONS below		X	UB9M968370	05/15/2021	05/15/2022	<input checked="" type="checkbox"/> PER STATUTE <input type="checkbox"/> OTH-ER E.L. EACH ACCIDENT \$1,000,000 E.L. DISEASE - EA EMPLOYEE \$1,000,000 E.L. DISEASE - POLICY LIMIT \$1,000,000										
D	Professional Liability			AE20211040	06/06/2021	06/06/2022	\$3,000,000 per claim \$3,000,000 annl aggr.										
DESCRIPTION OF OPERATIONS / LOCATIONS / VEHICLES (ACORD 101, Additional Remarks Schedule, may be attached if more space is required) Professional Liability coverage is written on a claims-made basis.																	
CERTIFICATE HOLDER				CANCELLATION													
For Proposal Purposes				SHOULD ANY OF THE ABOVE DESCRIBED POLICIES BE CANCELLED BEFORE THE EXPIRATION DATE THEREOF, NOTICE WILL BE DELIVERED IN ACCORDANCE WITH THE POLICY PROVISIONS.													
				AUTHORIZED REPRESENTATIVE 													

E-VERIFY MOU OR AFFIDAVIT WITH OTHER PROOF OF REGISTRATION WITH E-VERIFY



NASSAU COUNTY
BOARD OF COUNTY COMMISSIONERS
96135 Nassau Place, Suite 6
Yulee, Florida 32097

John Martin
Aaron C. Bell
Jeff Gray
Thomas R. Ford
Klynn Farmer

Dist. No. 1 Fernandina Beach
Dist. No. 2 Amelia Island
Dist. No. 3 Yulee
Dist. No. 4 Bryceville/Hillard
Dist. No. 5 Callahan/West Yulee

JOHN A. CRAWFORD
Ex-Officio Clerk

MICHAEL S. MULLIN
County Attorney

TACO E. POPE, AICP
County Manager

E-VERIFY FORM UNDER SECTION 448.095, FLORIDA STATUTES

Project Name: Nassau County Justice Center Courtroom #3 - Design Criteria Professional (RE-BID)

Bid No./Contract No.: NC21-052-RFQual-(RE-BID)

DEFINITIONS:

"Contractor" means a person or entity that has entered or is attempting to enter into a contract with a public employer to provide labor, supplies, or services to such employer in exchange for salary, wages, or other remuneration. "Contractor" includes, but is not limited to, a vendor or consultant.

"Subcontractor" means a person or entity that provides labor, supplies, or services to or for a contractor or another subcontractor in exchange for salary, wages, or other remuneration.

"E-Verify System" means an internet-based system operated by the United States Department of Homeland Security that allows participating employers to electronically verify the employment eligibility of newly hired employees.

Effective January 1, 2021, Contractors, shall register with and use the E-Verify System in order to verify the work authorization status of all newly hired employees. Contractor shall register for and utilize the U.S. Department of Homeland Security's E-Verify System to verify the employment eligibility of:

- Should vendor become the successful Contractor awarded for the above-named project, by entering into the contract, the Contractor shall comply with the provisions of Section 448.095, Florida Statutes, "Employment Eligibility", as amended from time to time. This includes, but is not limited to, registration and utilization of the E-Verify System to verify the work authorization status of all newly hired employees. The Contractor shall also execute the attached affidavit (Exhibit "A") attesting that the Contractor does not employ, contract with, or subcontract with, an unauthorized alien. The Contractor shall maintain a copy of such affidavit for the duration of the contract; and
- Contractor shall also require all subcontractors to execute the attached affidavit (Exhibit "B") attesting that the subcontractor does not employ, contract with, or subcontract with, an unauthorized alien. The Contractor shall maintain a copy of such affidavit for the duration of the contract.

CONTRACT TERMINATION:

- If Nassau County has a good faith belief that a person or entity with which it is contracting has knowingly violated §448.09(1), Florida Statutes, the contract shall be terminated.
- If Nassau County has a good faith belief that a subcontractor knowingly violated §448.095(2), but the Contractor otherwise complied with §448.095(2), Florida Statutes, shall promptly notify the Contractor and order the Contractor to immediately terminate the contract with the subcontractor.
- A contract terminated under subparagraph a) or b) is not a breach of contract and may not be considered as such.
- Any challenge to termination under this provision must be filed in the Circuit Court no later than twenty (20) calendar days after the date of termination.
- If the contract is terminated for a violation of the Statute by the Contractor, the

EXHIBIT "A"

CONTRACTOR E-VERIFY AFFIDAVIT

I hereby certify that PQH Group Design, Inc. (Contractor Company Name) does not employ, contract with, or subcontract with an unauthorized alien, and is otherwise in full compliance with Section 448.095, Florida Statutes.

All employees hired on or after January 1, 2021 have had their work authorization status verified through the E-Verify system.

A true and correct copy of PQH Group Design, Inc. (Contractor Company Name) proof of registration in the E-Verify system is attached to this Affidavit.

Print Name: Ricardo Quiñones, AIA, LEED AP BD+C

Date: 12/06/21

STATE OF FLORIDA

COUNTY OF Duval

The foregoing instrument was acknowledged before me by means of physical presence or online notarization, this 12/06/21 (Date) by Ricardo E. Quiñones (Name of Officer or Agent, Title of Officer or Agent) of PQH Group Design, Inc. (Name of Contractor Company Acknowledging), a Florida (State or Place of Incorporation) Corporation, on behalf of the Corporation. He/She is personally known to me or has produced as identification.

Kiersten L. Lewis
Notary Public

Kiersten L. Lewis
Printed Name

My Commission Expires: 2-3-26



An official website of the United States government
[Here's how you know](#)



Menu

My Company Account

My Company Profile

Company Information

Company Name

PQH Group Design, Inc.

Doing Business As (DBA)

Company ID

301336

Enrollment Date

02/03/2010

Employer ID Number

472933964

DUNS Number

Total Number of Employees

10 to 19

NAICS Code

541

Sector

EXHIBIT "B"
SUBCONTRACTOR E-VERIFY AFFIDAVIT

I hereby certify that TLC Engineering Solutions (Subcontractor Company Name) does not employ, contract with, or subcontract with an unauthorized alien, and is otherwise in full compliance with Section 448.095, Florida Statutes.

All employees hired on or after January 1, 2021 have had their work authorization status verified through the E-Verify system.

A true and correct copy of TLC Engineering Solutions (Subcontractor Company Name) proof of registration in the E-Verify system is attached to this Affidavit.

Print Name: Mark A. Gelfo, PE

Date: Oct. 28, 2021

STATE OF FLORIDA

COUNTY OF Duval

The foregoing instrument was acknowledged before me by means of ☐ physical presence or ☐ online notarization, this 10/28/2021 (Date) by Mark A. Gelfo, PE, (Name of Officer or Agent, Title of Officer or Agent) of TLC Engineering Solutions (Name of Contractor Company Acknowledging), a Florida (State or Place of Incorporation) Corporation, on behalf of the Corporation. He/She is personally known to me or has produced as identification.

Notary Public

Sheila Adams
 Printed Name



Sheila Adams
 Notary Public
 State of Florida
 Comm# HH114752
 Expires 5/9/2025

My Commission Expires: May 9, 2025

TRUTH IN NEGOTIATION
(PROVIDED ON PORTAL, BUT NOT ASKED FOR IN TAB 7: ATTACHMENTS)

TRUTH IN NEGOTIATION CERTIFICATION

05/14

Pursuant to Section 287.055(5)(a), Florida Statutes, for any lump-sum or cost-plus-a-fixed fee professional services contract over the threshold amount provided in Section 287.017, Florida Statutes for CATEGORY FOUR, the Department of Transportation (Department) requires the Consultant to execute this certificate and include it with the submittal of the Technical Proposal, or as prescribed in the contract advertisement.

The Consultant hereby certifies, covenants, and warrants that wage rates and other factual unit costs supporting the compensation for this project's agreement are accurate, complete, and current at the time of contracting.

The Consultant further agrees that the original agreement price and any additions thereto shall be adjusted to exclude any significant sums by which the Department determines the agreement price was increased due to inaccurate, incomplete, or noncurrent wage rates and other factual unit costs. All such agreement adjustments shall be made within (1) year following the end of the contract. For purposes of this certificate, the end of the agreement shall be deemed to be the date of final billing or acceptance of the work by the Department, whichever is later.

PQH Group Design, Inc.
 Name of Consultant

By: [Signature]

12/06/21
 Date

NASSAU COUNTY REQUEST FOR QUALIFICATIONS
NC21-052-RFQual (RE-BID) - NCJC COURTROOM 3
DESIGN CRITERIA PROFESSIONAL

ATTACHMENT "C"
ADDENDA ACKNOWLEDGMENT

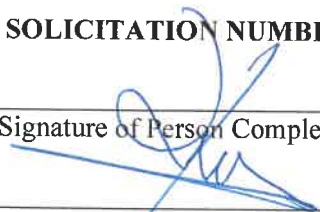
Acknowledgment is hereby made of receipt of addenda issued during the solicitation period. SOLICITATION NUMBER: NC21-052-RFQual	Addendum # <u>1</u> through # <u>1</u> Date: 12/06/21
Signature of Person Completing: 	
Printed Name: RICARDO QUINONES	Title: President

>>>Failure to submit this form may disqualify your response<<<



NASSAU COUNTY
BOARD OF COUNTY COMMISSIONERS
96135 Nassau Place, Suite 6
Yulee, Florida 32097

John Martin
Aaron C. Bell
Jeff Gray
Thomas R. Ford
Klynt Farmer

Dist. No. 1 Fernandina Beach
Dist. No. 2 Amelia Island
Dist. No. 3 Yulee
Dist. No. 4 Bryceville/Hilliard
Dist. No. 5 Callahan/West Yulee

JOHN A. CRAWFORD
Ex-Officio Clerk

MICHAEL S. MULLIN
County Attorney

TACO E. POPE, AICP
County Manager

E-VERIFY FORM UNDER SECTION 448.095, FLORIDA STATUTES

Project Name: Nassau County Justice Center Courtroom #3 - Design Criteria Professional (RE-BID)

Bid No./Contract No.: NC21-052-RFQual-(RE-BID)

DEFINITIONS:

“Contractor” means a person or entity that has entered or is attempting to enter into a contract with a public employer to provide labor, supplies, or services to such employer in exchange for salary, wages, or other remuneration. “Contractor” includes, but is not limited to, a vendor or consultant.

“Subcontractor” means a person or entity that provides labor, supplies, or services to or for a contractor or another subcontractor in exchange for salary, wages, or other remuneration.

“E-Verify System” means an internet-based system operated by the United States Department of Homeland Security that allows participating employers to electronically verify the employment eligibility of newly hired employees.

Effective January 1, 2021, Contractors, shall register with and use the E-Verify System in order to verify the work authorization status of all newly hired employees. Contractor shall register for and utilize the U.S. Department of Homeland Security’s E-Verify System to verify the employment eligibility of:

- a) All persons employed by a Contractor to perform employment duties within Florida during the term of the contract; and
- b) All persons (including subvendors/subconsultants/subcontractors) assigned by Contractor to perform work pursuant to the contract with Nassau County. The Contractor acknowledges and agrees that registration and use of the U.S. Department of Homeland Security’s E-Verify System during the term of the contract is a condition of the contract with Nassau County; and

(904) 530-6100

An Affirmative Action / Equal Opportunity Employer

- c) Should vendor become the successful Contractor awarded for the above-named project, by entering into the contract, the Contractor shall comply with the provisions of Section 448.095, Florida Statutes, "Employment Eligibility", as amended from time to time. This includes, but is not limited to, registration and utilization of the E-Verify System to verify the work authorization status of all newly hired employees. The Contractor shall also execute the attached affidavit (Exhibit "A") attesting that the Contractor does not employ, contract with, or subcontract with, an unauthorized alien. The Contractor shall maintain a copy of such affidavit for the duration of the contract; and
- d) Contractor shall also require all subcontractors to execute the attached affidavit (Exhibit "B") attesting that the subcontractor does not employ, contract with, or subcontract with, an unauthorized alien. The Contractor shall maintain a copy of such affidavit for the duration of the contract.

CONTRACT TERMINATION:

- a) If Nassau County has a good faith belief that a person or entity with which it is contracting has knowingly violated §448.09(1), Florida Statutes, the contract shall be terminated.
- b) If Nassau County has a good faith belief that a subcontractor knowingly violated §448.095(2), but the Contractor otherwise complied with §448.095(2), Florida Statutes, shall promptly notify the Contractor and order the Contractor to immediately terminate the contract with the subcontractor.
- c) A contract terminated under subparagraph a) or b) is not a breach of contract and may not be considered as such.
- d) Any challenge to termination under this provision must be filed in the Circuit Court no later than twenty (20) calendar days after the date of termination.
- e) If the contract is terminated for a violation of the Statute by the Contractor, the Contractor may not be awarded a public contract for a period of one (1) year after the date of termination.

EXHIBIT "A"

CONTRACTOR E-VERIFY AFFIDAVIT

I hereby certify that PQH Group Design, Inc. (Contractor Company Name) does not employ, contract with, or subcontract with an unauthorized alien, and is otherwise in full compliance with Section 448.095, Florida Statutes.

All employees hired on or after January 1, 2021 have had their work authorization status verified through the E-Verify system.

A true and correct copy of PQH Group Design, Inc. (Contractor Company Name) proof of registration in the E-Verify system is attached to this Affidavit.

Print Name: Ricardo Quiñones, AIA, LEED AP BD+C

Date: 12/06/21

STATE OF FLORIDA

COUNTY OF Duval

The foregoing instrument was acknowledged before me by means of ☒ physical presence or ☐ online notarization, this 12/6/21 (Date) by Ricardo E. Quiñones (Name of Officer or Agent, Title of Officer or Agent) of PQH Group Design, Inc. (Name of Contractor Company Acknowledging), a Florida (State or Place of Incorporation) Corporation, on behalf of the Corporation. He/She is personally known to me or has produced _____ as identification.

Kiersten L. Lewis
Notary Public

Kiersten L. Lewis
Printed Name

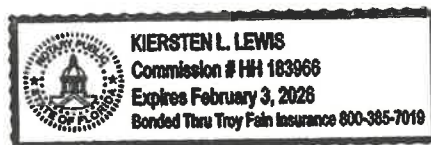

My Commission Expires: 2-3-26

ACORD™

CERTIFICATE OF LIABILITY INSURANCE

DATE (MM/DD/YYYY)

6/08/2021

THIS CERTIFICATE IS ISSUED AS A MATTER OF INFORMATION ONLY AND CONFERS NO RIGHTS UPON THE CERTIFICATE HOLDER. THIS CERTIFICATE DOES NOT AFFIRMATIVELY OR NEGATIVELY AMEND, EXTEND OR ALTER THE COVERAGE AFFORDED BY THE POLICIES BELOW. THIS CERTIFICATE OF INSURANCE DOES NOT CONSTITUTE A CONTRACT BETWEEN THE ISSUING INSURER(S), AUTHORIZED REPRESENTATIVE OR PRODUCER, AND THE CERTIFICATE HOLDER.

IMPORTANT: If the certificate holder is an ADDITIONAL INSURED, the policy(ies) must have ADDITIONAL INSURED provisions or be endorsed. If SUBROGATION IS WAIVED, subject to the terms and conditions of the policy, certain policies may require an endorsement. A statement on this certificate does not confer any rights to the certificate holder in lieu of such endorsement(s).

PRODUCER USI Insurance Services, LLC 2502 N Rocky Point Drive Suite 400 Tampa, FL 33607	CONTACT NAME: PHONE (A/C, No, Ext): 813 321-7500 FAX (A/C, No): E-MAIL ADDRESS:														
INSURED PQH Group, Inc. & PQH Group Design, Inc. 4141 Southpoint Drive East #200 Jacksonville, FL 32216	<table border="1"> <thead> <tr> <th data-bbox="816 426 1433 453">INSURER(S) AFFORDING COVERAGE</th> <th data-bbox="1433 426 1572 453">NAIC #</th> </tr> </thead> <tbody> <tr> <td data-bbox="816 453 1433 483">INSURER A : Phoenix Insurance Company</td> <td data-bbox="1433 453 1572 483">25623</td> </tr> <tr> <td data-bbox="816 483 1433 512">INSURER B : Travelers Property Cas. Co. of America</td> <td data-bbox="1433 483 1572 512">25674</td> </tr> <tr> <td data-bbox="816 512 1433 541">INSURER C : Travelers Casualty and Surety Company</td> <td data-bbox="1433 512 1572 541">19038</td> </tr> <tr> <td data-bbox="816 541 1433 571">INSURER D : Capitol Specialty Insurance Corporation</td> <td data-bbox="1433 541 1572 571">10328</td> </tr> <tr> <td data-bbox="816 571 1433 600">INSURER E :</td> <td data-bbox="1433 571 1572 600"></td> </tr> <tr> <td data-bbox="816 600 1433 634">INSURER F :</td> <td data-bbox="1433 600 1572 634"></td> </tr> </tbody> </table>	INSURER(S) AFFORDING COVERAGE	NAIC #	INSURER A : Phoenix Insurance Company	25623	INSURER B : Travelers Property Cas. Co. of America	25674	INSURER C : Travelers Casualty and Surety Company	19038	INSURER D : Capitol Specialty Insurance Corporation	10328	INSURER E :		INSURER F :	
INSURER(S) AFFORDING COVERAGE	NAIC #														
INSURER A : Phoenix Insurance Company	25623														
INSURER B : Travelers Property Cas. Co. of America	25674														
INSURER C : Travelers Casualty and Surety Company	19038														
INSURER D : Capitol Specialty Insurance Corporation	10328														
INSURER E :															
INSURER F :															

COVERAGES

CERTIFICATE NUMBER:

REVISION NUMBER:

THIS IS TO CERTIFY THAT THE POLICIES OF INSURANCE LISTED BELOW HAVE BEEN ISSUED TO THE INSURED NAMED ABOVE FOR THE POLICY PERIOD INDICATED. NOTWITHSTANDING ANY REQUIREMENT, TERM OR CONDITION OF ANY CONTRACT OR OTHER DOCUMENT WITH RESPECT TO WHICH THIS CERTIFICATE MAY BE ISSUED OR MAY PERTAIN, THE INSURANCE AFFORDED BY THE POLICIES DESCRIBED HEREIN IS SUBJECT TO ALL THE TERMS, EXCLUSIONS AND CONDITIONS OF SUCH POLICIES. LIMITS SHOWN MAY HAVE BEEN REDUCED BY PAID CLAIMS.

INSR LTR	TYPE OF INSURANCE	ADDL INSR	SUBR WVD	POLICY NUMBER	POLICY EFF (MM/DD/YYYY)	POLICY EXP (MM/DD/YYYY)	LIMITS
A	<input checked="" type="checkbox"/> COMMERCIAL GENERAL LIABILITY <input type="checkbox"/> CLAIMS-MADE <input checked="" type="checkbox"/> OCCUR GEN'L AGGREGATE LIMIT APPLIES PER: <input type="checkbox"/> POLICY <input checked="" type="checkbox"/> PRO-JECT <input type="checkbox"/> LOC OTHER:	X	X	6800J939206	05/15/2021	05/15/2022	EACH OCCURRENCE \$2,000,000 DAMAGE TO RENTED PREMISES (Ea occurrence) \$1,000,000 MED EXP (Any one person) \$10,000 PERSONAL & ADV INJURY \$2,000,000 GENERAL AGGREGATE \$4,000,000 PRODUCTS - COMP/OP AGG \$4,000,000 \$
	AUTOMOBILE LIABILITY <input type="checkbox"/> ANY AUTO OWNED AUTOS ONLY <input type="checkbox"/> HIRED AUTOS ONLY <input type="checkbox"/> SCHEDULED AUTOS NON-OWNED AUTOS ONLY						COMBINED SINGLE LIMIT (Ea accident) \$ BODILY INJURY (Per person) \$ BODILY INJURY (Per accident) \$ PROPERTY DAMAGE (Per accident) \$ \$
B	<input checked="" type="checkbox"/> UMBRELLA LIAB <input type="checkbox"/> EXCESS LIAB <input checked="" type="checkbox"/> RETENTION \$10,000	X	X	CUP4E109717	05/15/2021	05/15/2022	EACH OCCURRENCE \$2,000,000 AGGREGATE \$2,000,000 \$
C	WORKERS COMPENSATION AND EMPLOYERS' LIABILITY ANY PROPRIETOR/PARTNER/EXECUTIVE OFFICER/MEMBER EXCLUDED? <input type="checkbox"/> Y/N (Mandatory in NH) If yes, describe under DESCRIPTION OF OPERATIONS below		X	UB9M968370	05/15/2021	05/15/2022	<input checked="" type="checkbox"/> PER STATUTE <input type="checkbox"/> OTH-ER E.L. EACH ACCIDENT \$1,000,000 E.L. DISEASE - EA EMPLOYEE \$1,000,000 E.L. DISEASE - POLICY LIMIT \$1,000,000
D	Professional Liability			AE20211040	06/06/2021	06/06/2022	\$3,000,000 per claim \$3,000,000 annl aggr.

DESCRIPTION OF OPERATIONS / LOCATIONS / VEHICLES (ACORD 101, Additional Remarks Schedule, may be attached if more space is required)

Professional Liability coverage is written on a claims-made basis.

CERTIFICATE HOLDER

CANCELLATION

For Proposal Purposes

SHOULD ANY OF THE ABOVE DESCRIBED POLICIES BE CANCELLED BEFORE THE EXPIRATION DATE THEREOF, NOTICE WILL BE DELIVERED IN ACCORDANCE WITH THE POLICY PROVISIONS.

AUTHORIZED REPRESENTATIVE





CERTIFICATE OF LIABILITY INSURANCE

DATE (MM/DD/YYYY)
01/19/2021

THIS CERTIFICATE IS ISSUED AS A MATTER OF INFORMATION ONLY AND CONFERS NO RIGHTS UPON THE CERTIFICATE HOLDER. THIS CERTIFICATE DOES NOT AFFIRMATIVELY OR NEGATIVELY AMEND, EXTEND OR ALTER THE COVERAGE AFFORDED BY THE POLICIES BELOW. THIS CERTIFICATE OF INSURANCE DOES NOT CONSTITUTE A CONTRACT BETWEEN THE ISSUING INSURER(S), AUTHORIZED REPRESENTATIVE OR PRODUCER, AND THE CERTIFICATE HOLDER.

IMPORTANT: If the certificate holder is an ADDITIONAL INSURED, the policy(ies) must have ADDITIONAL INSURED provisions or be endorsed. If SUBROGATION IS WAIVED, subject to the terms and conditions of the policy, certain policies may require an endorsement. A statement on this certificate does not confer rights to the certificate holder in lieu of such endorsement(s).

PRODUCER

State Farm

Denny Doyle, Jr., Agent
7807 Baymeadows Rd E Suite 100
Jacksonville FL 32256

CONTACT NAME: Bonnie Skaggs

PHONE (A/C, No, Ext): 904-737-3777

E-MAIL: bonnie.skaggs.p3hv@dennydoyle.com

FAX (A/C, No): 904-737-0363

INSURER(S) AFFORDING COVERAGE

INSURER A: State Farm Florida Insurance Company

NAIC #

10739

INSURER B:

INSURER C:

INSURER D:

INSURER E:

INSURER F:

INSURED

PQH Group, Inc.
PQH Group Design, Inc.
4141 Southpoint Dr E, Suite 200
Jacksonville FL 32216

COVERAGES

CERTIFICATE NUMBER:

REVISION NUMBER:

THIS IS TO CERTIFY THAT THE POLICIES OF INSURANCE LISTED BELOW HAVE BEEN ISSUED TO THE INSURED NAMED ABOVE FOR THE POLICY PERIOD INDICATED. NOTWITHSTANDING ANY REQUIREMENT, TERM OR CONDITION OF ANY CONTRACT OR OTHER DOCUMENT WITH RESPECT TO WHICH THIS CERTIFICATE MAY BE ISSUED OR MAY PERTAIN, THE INSURANCE AFFORDED BY THE POLICIES DESCRIBED HEREIN IS SUBJECT TO ALL THE TERMS, EXCLUSIONS AND CONDITIONS OF SUCH POLICIES. LIMITS SHOWN MAY HAVE BEEN REDUCED BY PAID CLAIMS.

INSR LTR	TYPE OF INSURANCE	ADDL SUBR (INSR) (W/D)	POLICY NUMBER	POLICY EFF (MM/DD/YYYY)	POLICY EXP (MM/DD/YYYY)	LIMITS
	COMMERCIAL GENERAL LIABILITY					
	<input type="checkbox"/> CLAIMS-MADE <input type="checkbox"/> OCCUR					EACH OCCURRENCE \$
						DAMAGE TO RENTED PREMISES (Ea occurrence) \$
						VED EXP (Any one person) \$
	GENL AGGREGATE LIMIT APPLIES PER:					PERSONAL & ADV INJURY \$
	POLICY <input type="checkbox"/> PRO-JECT <input type="checkbox"/> LOC					GENERAL AGGREGATE \$
	OTHER:					PRODUCTS - COMPROP AGG \$
						\$
	AUTOMOBILE LIABILITY	X X	E22 4470-C09-59C	03/09/2021	03/09/2022	COMBINED SINGLE LIMIT (Ea accident) \$
	<input checked="" type="checkbox"/> ANY AUTO		E89 1664-B27-59B	02/24/2021	02/24/2022	BODILY INJURY (Per person) \$ 1,000,000
	<input checked="" type="checkbox"/> OWNED AUTOS ONLY	<input checked="" type="checkbox"/> SCHEDULED AUTOS	262 0504-C11-59Q	03/11/2021	03/11/2022	BODILY INJURY (Per accident) \$ 1,000,000
	<input checked="" type="checkbox"/> HIRED AUTOS ONLY	<input checked="" type="checkbox"/> NON-OWNED AUTOS ONLY				PROPERTY DAMAGE (Per accident) \$ 1,000,000
	<input checked="" type="checkbox"/> Comp 250	<input checked="" type="checkbox"/> Coll 500				\$
	UMBRELLA LIAB					EACH OCCURRENCE \$
	EXCESS LIAB					AGGREGATE \$
	DED RETENTION \$					\$
	WORKERS COMPENSATION AND EMPLOYERS' LIABILITY					PER STATUTE <input type="checkbox"/> OTH-ER <input type="checkbox"/>
	ANY PROPRIETOR/PARTNER/EXECUTIVE OFFICER/MEMBER EXCLUDED? (Mandatory in NH)	Y/N <input type="checkbox"/> N/A				E1 EACH ACCIDENT \$
	If yes, describe under DESCRIPTION OF OPERATIONS below					E1 DISEASE - EA EMPLOYEE \$
						E1 DISEASE - POLICY LIMIT \$

DESCRIPTION OF OPERATIONS / LOCATIONS / VEHICLES (ACORD 101, Additional Remarks Schedule, may be attached if more space is required)

CERTIFICATE HOLDER

CANCELLATION

SHOULD ANY OF THE ABOVE DESCRIBED POLICIES BE CANCELLED BEFORE THE EXPIRATION DATE THEREOF, NOTICE WILL BE DELIVERED IN ACCORDANCE WITH THE POLICY PROVISIONS.

AUTHORIZED REPRESENTATIVE

FOR PROPOSAL PURPOSES

Bonnie Skaggs

© 1988-2015 ACORD CORPORATION. All rights reserved.

Request for Taxpayer Identification Number and Certification

Give Form to the
requester. Do not
send to the IRS.

► Go to www.irs.gov/FormW9 for instructions and the latest information.

Print or type.
See Specific Instructions on page 3.

1 Name (as shown on your income tax return). Name is required on this line; do not leave this line blank. PQH Group Design, Inc.	
2 Business name/disregarded entity name, if different from above	
3 Check appropriate box for federal tax classification of the person whose name is entered on line 1. Check only one of the following seven boxes. <input type="checkbox"/> Individual/sole proprietor or single-member LLC <input checked="" type="checkbox"/> C Corporation <input type="checkbox"/> S Corporation <input type="checkbox"/> Partnership <input type="checkbox"/> Trust/estate <input type="checkbox"/> Limited liability company. Enter the tax classification (C=C corporation, S=S corporation, P=Partnership) ► Note: Check the appropriate box in the line above for the tax classification of the single-member owner. Do not check LLC if the LLC is classified as a single-member LLC that is disregarded from the owner unless the owner of the LLC is another LLC that is not disregarded from the owner for U.S. federal tax purposes. Otherwise, a single-member LLC that is disregarded from the owner should check the appropriate box for the tax classification of its owner. <input type="checkbox"/> Other (see instructions) ►	
4 Exemptions (codes apply only to certain entities, not individuals; see instructions on page 3): Exempt payee code (if any) _____ Exemption from FATCA reporting code (if any) _____ <small>(Applies to accounts maintained outside the U.S.)</small>	
5 Address (number, street, and apt. or suite no.) See instructions. 4141 Southpoint Drive East, Suite # 200	Requester's name and address (optional)
6 City, state, and ZIP code Jacksonville, FL 32216	
7 List account number(s) here (optional)	

Part I Taxpayer Identification Number (TIN)

Enter your TIN in the appropriate box. The TIN provided must match the name given on line 1 to avoid backup withholding. For individuals, this is generally your social security number (SSN). However, for a resident alien, sole proprietor, or disregarded entity, see the instructions for Part I, later. For other entities, it is your employer identification number (EIN). If you do not have a number, see *How to get a TIN*, later.

Note: If the account is in more than one name, see the instructions for line 1. Also see *What Name and Number To Give the Requester* for guidelines on whose number to enter.

Social security number								
			-			-		
or								
Employer identification number								
4	7	-	2	9	3	3	9	6

Part II Certification

Under penalties of perjury, I certify that:

1. The number shown on this form is my correct taxpayer identification number (or I am waiting for a number to be issued to me); and
2. I am not subject to backup withholding because: (a) I am exempt from backup withholding, or (b) I have not been notified by the Internal Revenue Service (IRS) that I am subject to backup withholding as a result of a failure to report all interest or dividends, or (c) the IRS has notified me that I am no longer subject to backup withholding; and
3. I am a U.S. citizen or other U.S. person (defined below); and
4. The FATCA code(s) entered on this form (if any) indicating that I am exempt from FATCA reporting is correct.

Certification instructions. You must cross out item 2 above if you have been notified by the IRS that you are currently subject to backup withholding because you have failed to report all interest and dividends on your tax return. For real estate transactions, item 2 does not apply. For mortgage interest paid, acquisition or abandonment of secured property, cancellation of debt, contributions to an individual retirement arrangement (IRA), and generally, payments other than interest and dividends, you are not required to sign the certification, but you must provide your correct TIN. See the instructions for Part II, later.

Sign Here	Signature of U.S. person ► 	Date ► 9-1-20
------------------	--	---------------

General Instructions

Section references are to the Internal Revenue Code unless otherwise noted.

Future developments. For the latest information about developments related to Form W-9 and its instructions, such as legislation enacted after they were published, go to www.irs.gov/FormW9.

Purpose of Form

An individual or entity (Form W-9 requester) who is required to file an information return with the IRS must obtain your correct taxpayer identification number (TIN) which may be your social security number (SSN), individual taxpayer identification number (ITIN), adoption taxpayer identification number (ATIN), or employer identification number (EIN), to report on an information return the amount paid to you, or other amount reportable on an information return. Examples of information returns include, but are not limited to, the following.

- Form 1099-INT (interest earned or paid)

- Form 1099-DIV (dividends, including those from stocks or mutual funds)
- Form 1099-MISC (various types of income, prizes, awards, or gross proceeds)
- Form 1099-B (stock or mutual fund sales and certain other transactions by brokers)
- Form 1099-S (proceeds from real estate transactions)
- Form 1099-K (merchant card and third party network transactions)
- Form 1098 (home mortgage interest), 1098-E (student loan interest), 1098-T (tuition)
- Form 1099-C (canceled debt)
- Form 1099-A (acquisition or abandonment of secured property)

Use Form W-9 only if you are a U.S. person (including a resident alien), to provide your correct TIN.

If you do not return Form W-9 to the requester with a TIN, you might be subject to backup withholding. See What is backup withholding, later.

NASSAU COUNTY REQUEST FOR QUALIFICATIONS
NC21-052-RFQual (RE-BID) - NCJC COURTROOM 3 DESIGN
CRITERIA PROFESSIONAL

ATTACHMENT "E"
DRUG FREE WORKPLACE CERTIFICATE

I, the undersigned, in accordance with Florida Statute 287.087, hereby certify that _____
PQH Group Design, Inc. (print or type name of firm)

1. Publishes a written statement notifying that the unlawful manufacture, distribution, dispensing, possession or use of a controlled substance in the workplace named above, and specifying actions that will be taken against violations of such prohibition.
2. Informs employees about the dangers of drug abuse in the workplace, the firm's policy of maintaining a drug free working environment, and available drug counseling, rehabilitation, and employee assistance programs, and the penalties that may be imposed upon employees for drug use violations.
3. Gives each employee engaged in providing commodities or contractual services that are under bid or proposal, a copy of the statement specified above.
4. Notifies the employees that as a condition of working on the commodities or contractual services that are under bid or proposal, the employee will abide by the terms of the statement and will notify the employer of any conviction of, plea of guilty or nolo contendere to, any violation of Chapter 1893, or any controlled substance law of the State of Florida or the United States, for a violation occurring in the work place, no later than five (5) days after such conviction, and requires employees to sign copies of such written statement to acknowledge their receipt.
5. Imposes a sanction on, or requires the satisfactory participation in, a drug abuse assistance or rehabilitation program, if such is available in the employee's community, by any employee who is so convicted.
6. Makes a good faith effort to continue to maintain a drug free workplace through the implementation of a drug free workplace program.

"As a person authorized to sign a statement, I certify that the above-named business, firm, or corporation complies fully with the requirements set forth herein."



Authorized Signature

12/06/21

Date Signed

NASSAU COUNTY REQUEST FOR QUALIFICATIONS
NC21-052-RFQual (RE-BID) - NCJC COURTROOM 3 DESIGN
CRITERIA PROFESSIONAL

State of: Florida

County of: Duval

The foregoing, a Drug Free Workplace Certificate, was sworn to (or affirmed) and subscribed before me by means of ☒ physical presence or ☐ online notarization, this 6 day of December, 2021 by Ricardo E. Quirones who is ☒ personally known to me or ☐ produced _____ as identification.

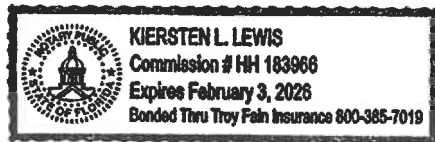

Kiersten L Lewis

Notary Public

My commission expires: 2-3-26

NASSAU COUNTY REQUEST FOR QUALIFICATIONS
NC21-052-RFQual (RE-BID) - NCJC COURTROOM 3
DESIGN CRITERIA PROFESSIONAL

ATTACHMENT "D"
SWORN STATEMENT
UNDER FLORIDA STATUTE 287.133(3)(a) ON PUBLIC ENTITY CRIMES

TO BE RETURNED WITH BID

THIS MUST BE SIGNED IN THE PRESENCE OF A NOTARY PUBLIC OR OTHER OFFICER
AUTHORIZED TO ADMINISTER OATHS

1. This sworn statement is submitted with Bid, Proposal or Contract for Nassau County Justice Center Courtroom #3 Design Criteria Professional (RE-BID).
2. This sworn statement is submitted by PQH Group Design, Inc. (entity submitting sworn statement), whose business address is 4141 Southpoint Drive East Suite 200 Jacksonville, FL 32216 and its Federal Employee Identification Number (FEIN) is 47-2933964. (If the entity has no FEIN, include the Social Security Number of the individual signing this sworn statement: _____.)
3. My name is Ricardo Quiñones, AIA, LEED AP BD+C (please print name of individual signing), and my relationship to the entity named above is President.
4. I understand that a "public entity crime" as defined in Paragraph 287.133(1)(g), Florida Statutes, means a violation of any state or federal law by a person with respect to and directly related to the transaction of business with any public entity or with an agency or political subdivision of any other state or with the United States, including, but not limited to, any bid or contract for goods or services, any leases for real property, or any contract for the construction or repair of a public building or public work, to be provided to any public entity or an agency or political subdivision of any other state or of the United States and involving antitrust, fraud, theft, bribery, collusion, racketeering, conspiracy, or material misrepresentation.
5. I understand that "convicted" or "conviction" as defined in paragraph 287.133(1)(b), Florida Statutes, means a finding of guilt or a conviction or a public entity crime, with or without an adjudication of guilt, in any federal or state trial court of record relating to charges brought by indictment or information after July 1, 1989, as a result of a jury verdict, non-jury trial, or entry of a plea of guilty or nolo contendere.
6. I understand that an "affiliate" as defined in paragraph 287.133(1)(a), Florida Statutes, means:
 - a) A predecessor or successor of a person convicted of a public entity crime; or
 - b) An entity under the control of any natural person who is active in the management of the entity and who has been convicted of a public entity crime. The term "affiliate" includes those officers, directors, executives, partners, shareholders, employees, members, and agents who are active in the management of an affiliate. The ownership by one person of shares constituting a controlling interest in another person, or a pooling of equipment or income among persons when not to fair market value under an arm's length agreement, shall be prima facie case that one person controls another person. A person who knowingly enters into a joint venture with a person who has been convicted of a public entity crime in Florida during the preceding thirty-six (36) months shall be considered an affiliate.
7. I understand that a "person" as defined in Paragraph 287.133(1)(e), Florida Statutes, means any natural person or entity organized under the laws of any state or of the United States with the legal power to enter into binding contract and which bids or applies to bid on contracts let by a public entity, or which otherwise transacts or applies to transact business with a public entity. The term "person" includes those officers, directors, executives, partners, shareholders, employees, members, and agents who are active in management of an entity.

NASSAU COUNTY REQUEST FOR QUALIFICATIONS
NC21-052-RFQual (RE-BID) - NCJC COURTROOM 3
DESIGN CRITERIA PROFESSIONAL

8. Based on information and belief, the statement, which I have marked below, is true in relation to the entity submitting this sworn statement. (Please indicate which statement applies.)

☒ Neither the entity submitting this sworn statement, nor any of its officers, directors, executives, partners, shareholders, employees, members, or agents who are active in management of the entity, nor any affiliate of the entity have been charged with and convicted of a public entity crime subsequent to July 1, 1989.

☐ The entity submitting this sworn statement, or one of more of the officers, directors, executives, partners, shareholders, employees, members, or agents who are active in management of the entity, or an affiliate of the entity has been charged with and convicted of a public entity crime subsequent to July 1, 1989, and (Please indicate which additional statement applies.)

☐ There has been a proceeding concerning the conviction before a hearing officer of the State of Florida, Division of Administrative Hearings. The final order entered by the Hearing Officer did not place the person or affiliate on the convicted vendor list. (Please attach a copy of the final order.)

☐ The person or affiliate was placed on the convicted vendor list. There has been a subsequent proceeding before a hearing officer of the State of Florida, Division of Administrative Hearings. The final order entered by the hearing officer determined that it was in the public interest to remove the person or affiliate from the convicted vendor list. (Please attach a copy of the final order.)

☐ The person or affiliate has not been placed on the convicted vendor list. (Please describe any action taken by or pending with the Department of General Services.)

Signature

12/06/21

Date

State of: Florida

County of: Duval

Sworn to (or affirmed) and subscribed before me by means of ☒ physical presence or ☐ online notarization, this 6 day of December, 2021 by Ricardo E. Quinones who is ☒ personally known to me or ☐ produced _____ as identification.

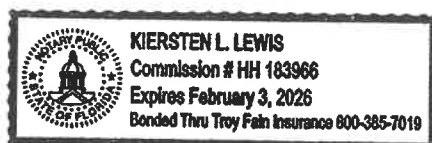

Kiersten L. Lewis
Notary Public

My commission expires: 2-3-26