

## Legend

- 1 50-Meter Olympic Pool
- 2 Aquatics Center Building
- 3 Aquatics Center Deck with Seating, Umbrellas, and Pavilions
- 4 Dog Park
- 5 Fitness Corral with Shade Sails
- 6 Group Pavilion
- 7 Lake (6.3 Acres)
- 8 Lazy River
- 9 Main Park Drive
- 10 Multi-generational, Universally Accessible Playground
- 11 Multi-Purpose Aquatic Building (15,000 sf.)
- 12 Multi-Purpose Open Space
- 13 Multi-Purpose Trail
- 14 Nature Playground
- 15 Nature Trail
- 16 On-Street Parking
- 17 Outdoor Amphitheater Stage
- 18 Parking (Total: 377)
- 19 Picnic Area
- 20 Pier with Look-Out Pavilion
- 21 Pine Plantation
- 22 Residential Street Network
- 23 Resource Recreation Concessionaire with Dock
- 24 Restored Habitat with Canopy Trees
- 25 Splash Pad
- 26 Therapeutic Pool

### Notes:

(X) = Approximate number of parking spaces in each parking area within parking boundary, on-street parking along park boundary is not included.

School Site

# Wildlight Aquatics Regional Park

## Conceptual Park Site Master Plan



## Water Quality and Quantity Analysis

Water quality analyses needs were completed for the Conceptual Park Master Plan based on St. Johns Water Management District (SJRWMD) requirements. The analyses suggests that 270,507 cubic feet are needed. The conceptual master plan includes 1,051,900+ cubic feet.

Water quantity requirements are required when the construction area is greater than 50% of the impervious area, therefore a water quantity analysis may be required for this park. A detailed stormwater analysis is recommended during detailed design with a stormwater model of the site improvements to calculate the water quantity storage requirements. For the purpose of this conceptual master plan, water quantity calculations were not performed. Additional storage beyond those identified in this plan may be required to meet water quantity requirements.



### Water Quality and Quantity Analysis

Water quality analyses needs were completed for the Conceptual Park Master Plan based on St. Johns Water Management District (SJRWMD) requirements. The analyses suggests that 112,385 cubic feet are needed for retention. The conceptual master plan includes 115,316+ cubic feet.

Water quantity requirements are required when the construction area is greater than 50% of the impervious area, therefore a water quantity analysis may be required for this park. A detailed stormwater analysis is recommended during detailed design with a stormwater model of the site improvements to calculate the water quantity storage requirements. For the purpose of this conceptual master plan, water quantity calculations were not performed. Additional storage beyond those identified in this plan may be required to meet water quantity requirements.

# Bluff Overlook Park

## Conceptual Park Site Master Plan

FEMA 100-year Flood Zone

CHN Upland Area

CHN Wetland Area

115,316 Cu-ft

Proposed Mobility Network

St. Marys River

### Legend

- ① Bluff Overlook Center and Patio
- ② Green Ribbon Trail
- ③ Main Park Drive
- ④ Multi-Purpose Trail
- ⑤ Multi-Purpose Open Space
- ⑥ Nature Trail
- ⑦ Parking (Total: 100)
- ⑧ Rental Cottage
- ⑨ Rental Pavilion
- ⑩ Service Drive

### Notes:

(X) = Approximate number of parking spaces in each parking area.

Scale: 1"=200'

0' 100' 200'

N

**Barth Associates**  
PUBLIC REALM PLANNING, DESIGN, AND FACILITATION



Water Quality and Quantity Analysis

Water quality analyses needs were completed for the Conceptual Park Master Plan based on St. Johns Water Management District (SJRWMD) requirements. The analyses suggests that 38,333 cubic feet are needed for retention. The conceptual master plan includes 38,421+ cubic feet.

Water quantity requirements are required when the construction area is greater than 50% of the impervious area, therefore a water quantity analysis may be required for this park. A detailed stormwater analysis is recommended during detailed design with a stormwater model of the site improvements to calculate the water quantity storage requirements. For the purpose of this conceptual master plan, water quantity calculations were not performed. Additional storage beyond those identified in this plan may be required to meet water quantity requirements.







**Legend**

- ① Baseball Fields
- ② Dog Park
- ③ Fitness Corral with Shade Sales
- ④ Floating Boardwalk
- ⑤ Group Pavilion
- ⑥ Lake (Total: 42 Acres)
- ⑦ Main Park Drive
- ⑧ Maintenance Compound
- ⑨ Multi-generation, Universally Accessible Playground with Shade Sales
- ⑩ Multi-Purpose Open Space
- ⑪ Multi-Purpose Trail
- ⑫ On-Street Parking
- ⑬ Outdoor Amphitheater Stage
- ⑭ Parking (Total: 1,003)
- ⑮ Pavilion
- ⑯ Pickleball Court
- ⑰ Pine Plantation
- ⑱ Recreation Center (57,800 sf.)
- ⑲ Restored Habitat with Canopy Trees
- ⑳ Soccer Field
- ㉑ Softball Fields
- ㉒ Tennis Court

Notes:  
(X) = Approximate number of parking spaces in each parking area within parking boundary, on-street parking along park boundary is not included.

**Water Quality and Quantity Analysis**

Water quality analyses needs were completed for the Conceptual Park Master Plan based on St. Johns Water Management District (SJRWMD) requirements. The analyses suggests that 1,575,563 cubic feet are needed for retention. The conceptual master plan includes 2,043,884+ cubic feet.

Water quantity requirements are required when the construction area is greater than 50% of the impervious area, therefore a water quantity analysis may be required for this park. A detailed stormwater analysis is recommended during detailed design with a stormwater model of the site improvements to calculate the water quantity storage requirements. For the purpose of this conceptual master plan, water quantity calculations were not performed. Additional storage

# Expanded Yulee Regional Park

Conceptual Park Site Master Plan

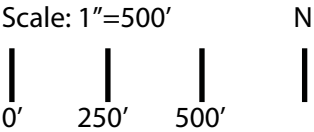





**Legend**

- ① Baseball Fields
- ② Dog Park
- ③ Fitness Corral with Shade Sales
- ④ Floating Boardwalk
- ⑤ Group Pavilion
- ⑥ Lake (Total: 42 Acres)
- ⑦ Main Park Drive
- ⑧ Maintenance Compound
- ⑨ Multi-generation, Universally Accessible Playground with Shade Sales
- ⑩ Multi-Purpose Open Space
- ⑪ Multi-Purpose Trail
- ⑫ On-Street Parking
- ⑬ Outdoor Amphitheater Stage
- ⑭ Parking (Total: 1,159)
- ⑮ Pavilion
- ⑯ Pickleball Court
- ⑰ Pine Plantation
- ⑱ Recreation Center (57,800 sf.)
- ⑲ Restored Habitat with Canopy Trees
- ⑳ Soccer Field
- ㉑ Softball Fields
- ㉒ Splash Pad
- ㉓ Tennis Court

Notes:  
(X) = Approximate number of parking spaces in each parking area within parking boundary, on-street parking along park boundary is not included.

**Water Quality and Quantity Analysis**

Water quality analyses needs were completed for the Conceptual Park Master Plan based on St. Johns Water Management District (SJRWMD) requirements. The analyses suggests that 1,575,563 cubic feet are needed for retention. The conceptual master plan includes 4,486,059+ cubic feet.

Water quantity requirements are required when the construction area is greater than 50% of the impervious area, therefore a water quantity analysis may be required for this park. A detailed stormwater analysis is recommended during detailed design with a stormwater model of the site improvements to calculate the water quantity storage requirements. For the purpose of this conceptual master plan, water quantity calculations were not performed. Additional storage

# Expanded Yulee Regional Park Alt.

Conceptual Park Site Master Plan

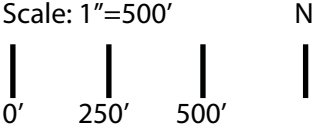





# Wildlight Adventure Park

## Conceptual Park Site Master Plan

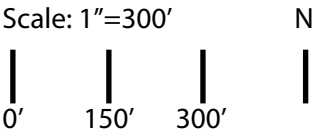





0'      250'      500'

 **Barth Associates**  
PUBLIC REALM PLANNING, DESIGN, AND FACILITATION





**Water Quality and Quantity Analysis**

Water quality analyses needs were completed for the Conceptual Park Master Plan based on St. Johns Water Management District (SJRWMD) requirements. The analyses suggests that 110,642 cubic feet are needed for retention. The conceptual master plan includes 656,151+ cubic feet.

Water quantity requirements are required when the construction area is greater than 50% of the impervious area, therefore a water quantity analysis may be required for this park. A detailed stormwater analysis is recommended during detailed design with a stormwater model of the site improvements to calculate the water quantity storage requirements. For the purpose of this conceptual master plan, water quantity calculations were not performed. Additional storage beyond those identified in this plan may be required to meet water quantity requirements.

**Inclusive Park**  
Conceptual Park Site Master Plan

Scale: 1"=300'  
0' 300'

600'