

GENERAL NOTES

ALL ASPHALT, LIMESTONE, AND CONSTRUCTION DEBRIS SHALL BE REMOVED FROM PLANTING BEDS AND SOD AREAS PRIOR TO LANDSCAPE INSTALLATION. IF ENCOUNTERED DURING CONSTRUCTION OR INSTALLATION, THESE SHALL BE EXCAVATED AND REMOVED FROM THE SITE. PLANTING DEPTH OF SOIL IN SUCH AREAS SHOULD BE AT LEAST 3'. IF FILL MUST BE ADDED, IT MUST BE FLORIDA CLEAN DEEP FILL (FREE OF WEED SEEDS) WITH pH 6.0 - 7.5.

ALL LANDSCAPED AREAS SHALL BE MULCHED WITH 3" THICKNESS OF MULCH. PINE BARK MULCH SHALL BE USED IN ALL AREAS, EXCEPT RETENTION AREAS. PINE STRAW MULCH SHALL BE USED IN RETENTION AREAS.

NEW TREES OUTSIDE OF MULCHED LANDSCAPED BEDS WILL BE PROTECTED FROM MOWER AND STRING TRIMMER DAMAGE WITH 10" OF PLASTIC DRAIN TUBING.

LEADER SHOOTS AND MAIN STRUCTURAL LIMBS OF TREES SHALL NOT BE TOPPED OR PRUNED. TREES WILL BE STAKED AS NEEDED. GUYLINES WILL BE OF NON-SYNTHETIC BIODEGRADABLE MATERIAL.

INVASIVE EXOTIC PLANT MATERIAL

ALL INVASIVE PLANT SPECIES TO BE REMOVED FROM SITE PRIOR TO ISSUANCE OF THE CERTIFICATE OF OCCUPANCY.

GRASSING

ALL DISTURBED AND UNPAVED AREAS TO BE GRASSED WITH SOD THAT IS FREE OF NOXIOUS WEEDS INCLUDING TROPICAL SODA APPLE OR SHALL BE SEEDED AND MULCHED. SEE CIVIL SITE PLANS FOR ADDITIONAL RELATED INFORMATION.

PLANT MATERIAL

ALL PLANT MATERIAL TO BE FLORIDA NO.1 OR BETTER, GRADED IN ACCORDANCE WITH THE STATE OF FLORIDA DEPARTMENT OF AGRICULTURE, DIVISION OF PLANT INDUSTRY'S 'GRADES AND STANDARDS FOR NURSERY PLANTS', CURRENT EDITION AT THE TIME PLANS ARE ISSUED. CALL THE CITY URBAN FORESTRY INSPECTOR AT 352-334-5023 AND LANDSCAPE ARCHITECT PRIOR TO PURCHASING ANY PLANT MATERIAL FOR AN ON SITE INSPECTION AND REVIEW OF LANDSCAPE PLAN.

PLANT QUANTITIES SHOWN ARE FOR PERMITTING PURPOSES ONLY. IT IS THE RESPONSIBILITY OF THE CONTRACTOR TO CONFIRM ALL QUANTITIES SHOWN ON THE PLAN.

LANDSCAPE

ALL TREES SHALL BE PLANTED IN A MINIMUM DIMENSION OF TEN (10) FEET. THIS MINIMUM PLANTING AREA MUST BE FREE OF ALL PLACEMENT AND VEHICLE OVERHAND IN ORDER TO PREVENT POSSIBLE TREE DAMAGE [LDC SECTION 37.05(B)(1)].

SHRUBS SHALL HAVE A MINIMUM HEIGHT OF EIGHTEEN (18) INCHES WHEN PLANTED. WHEN PLANTED AS A HEDGE, THE MAXIMUM SPACING IS 30 INCHES ON CENTER. ALL SHRUBS USED FOR VISUAL SCREENING SHALL BE OF A PLANT SPECIES THAT IS CAPABLE OF REACHING A HEIGHT OF FOUR (4) FEET WITHIN TWENTY-FOUR (24) MONTHS UNDER NORMAL GROWING CONDITIONS. SHRUBS USED AS ACCENT GROUNDCOVERS AND VINES MAY VARY IN SIZE DEPENDING ON THE TYPE OF PLANT MATERIAL AND THE DESIRED EFFECT [LDC SECTION 37.05(B)(2)].

GROUNDCOVERS SHALL BE PLANTED IN SUCH A MANNER AS TO PRESENT A FINISHED APPEARANCE AND COMPLETE COVERAGE WITHIN ON (1) YEAR AFTER PLANING [LDC SECTION 37.05(B)(3)].

ALL TREES PLANTED SHALL BE STAKED OR GUYED FOR A PERIOD OF AT LEAST SIX (6) MONTHS IN ACCORDANCE WITH THE ADOPTED PLANTING DETAIL [LDC SECTION 37.05(B)].

THE PROPERTY OWNER IS RESPONSIBLE FOR THE MAINTENANCE OF ALL LANDSCAPE AREAS REQUIRED BY THIS SECTION. MAINTENANCE INCLUDES IRRIGATION, MOWING, TRIMMING, FERTILIZING AND CARRYING OUT THOSE ACTIVITIES NECESSARY TO KEEP THE PLANT MATERIAL IN A HEALTHY AND GROWING CONDITION, MAINTAIN VISUAL CLEARANCE AND ALLOW PASSAGE OF VEHICLES AND PEDESTRIANS ON PUBLIC ROADS AND NON-EXCLUSIVE EASEMENTS [LDC SECTION 37.05(K)].

UPON DETERMINATION BY THE COUNTY THAT A REQUIRED TREE OR PLANT IS DEAD OR SEVERELY DAMAGED OR DISEASED, THE TREE OR PLANT SHALL BE REPLACED BY THE OWNER WITH PLANT MATERIAL MEETING THE REQUIREMENTS OF THIS SECTION [LDC SECTION 37.05(K)(1)].

ALL BUFFER AREAS REQUIRED AS PART OF A DEVELOPMENT PLAN, WHETHER IN COMMON OR PRIVATE OWNERSHIP, SHALL BE THE RESPONSIBILITY OF THAT DEVELOPMENT'S PROPERTY OWNERS' ASSOCIATION. WHERE THERE IS NO PROPERTY OWNERS' ASSOCIATION, SUCH LANDSCAPE AREAS SHALL BE THE RESPONSIBILITY OF THE PROPERTY OWNER [LDC SECTION 37.05(K)(2)].

TREES ON DEVELOPED PROPERTIES MAY BE PRUNED TO MAINTAIN SHAPE AND PROMOTE THEIR SHADE-GIVING QUALITIES. THEY SHOULD BE PRUNED TO REMOVE DISEASED OR DYING PORTIONS IN AREAS WHERE FALLING LIMBS COULD BE HAZARDOUS TO PEOPLE OR PROPERTY. LOWER LIMBS MAY BE REMOVED TO PROVIDE CLEARANCE. IN ADDITION, TREES LOCATED IN ASSOCIATION WITH VEHICULAR USE AREAS SHALL ALSO BE PRUNED TO ALLOW A SEVEN-FOOT CLEARANCE FROM GROUND LEVEL TO AVOID POTENTIAL FOR DAMAGE OR INJURY TO PEDESTRIANS AND CLEARED TO THIRTEEN (13) FEET ABOVE PAVEMENT LEVEL FOR VEHICLES. HOWEVER, THE EXCESSIVE PRUNING OR POLLARDING OF TREES INTO ROUND BALLS OF CROWN OR BRANCHES RESULTING IN AN UNNECESSARY REDUCTION OF SHADE IS PROHIBITED AND MAY REQUIRE SUPPLEMENTAL PLANTINGS. ALL PRUNING SHALL BE DONE FOLLOWING THE AMERICAN NATIONAL STANDARD FOR TREE CARE OPERATIONS 'TREE, SHRUB AND OTHER WOODY PLANT MAINTENANCE - STANDARD PRACTICES' [LDC SECTION 37.05(K)(3)].

THE USE OF A WALL OR FENCE IS PERMITTED PROVIDED THE WALL OR FENCE IS LOCATED ON THE INNER MOST BOUNDARY (BEHIND THE VEGETATION AS VIEWED FROM OUTSIDE THE DEVELOPMENT) OF THE PERIMETER LANDSCAPING ADJACENT TO RIGHTS-OF-WAY/STREETS, REQUIRED UNCOMPLEMENTARY LAND USE BUFFER OR OTHER LANDSCAPE AREA [LDC SECTION 37.05(D)].

KEY MAP

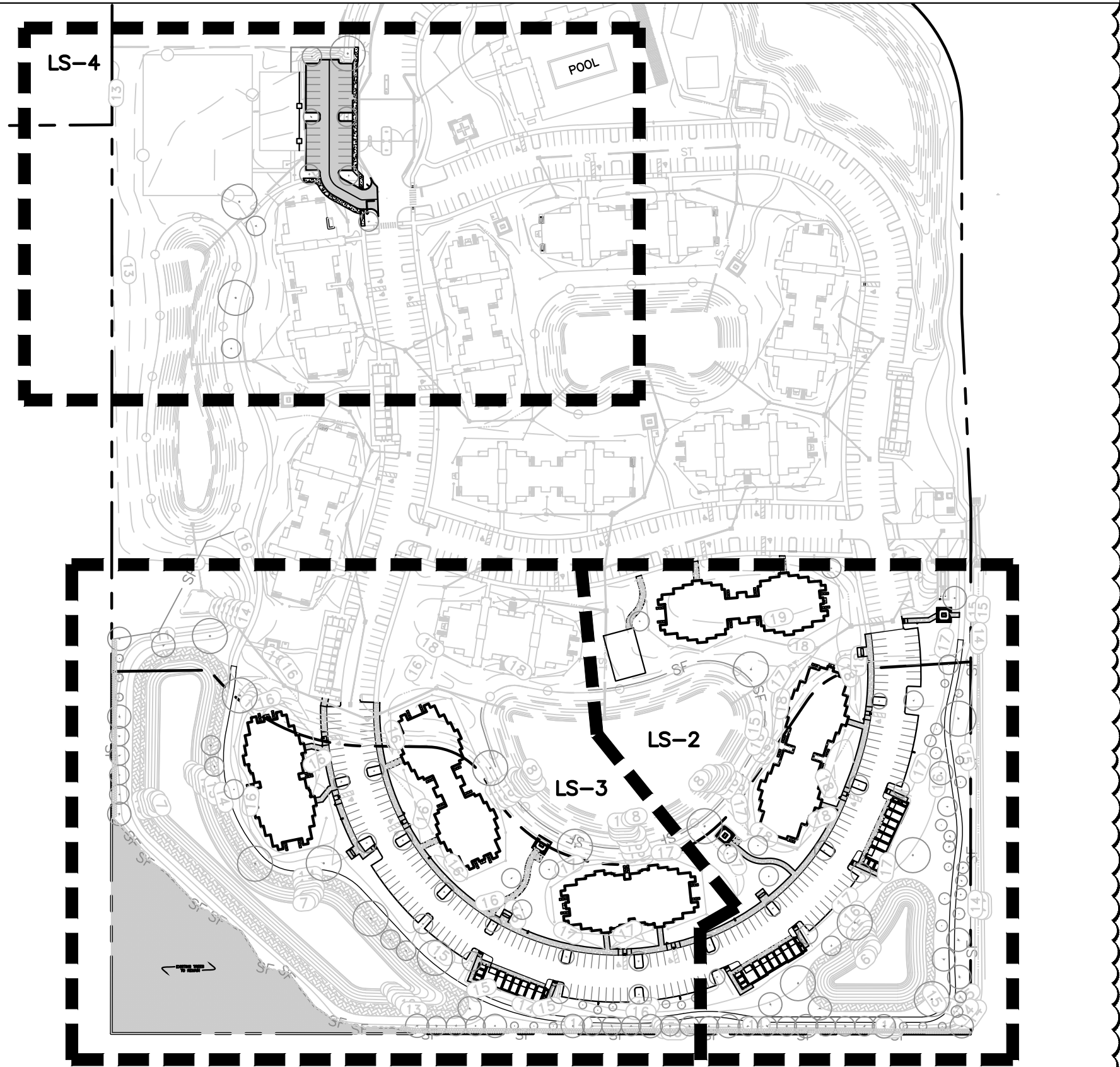

LANDSCAPED AREA QUANTITIES
PER LDC SECTION 37.05(G)

TOTAL PROJECT AREA.....	10.94 ACRES
TOTAL IMPERVIOUS AREA.....	165,438 SF
TOTAL STORMWATER AREA.....	41,463 SF
TOTAL LANDSCAPE AREA.....	174,162 SF
TOTAL LAND USE BUFFER AREA.....	21,425 SF
TOTAL LOCAL ROAD BUFFER AREA.....	9,339 SF

NOTE:
A PORTION OF THE REQUIRED PERIMETER LAND USE BUFFER IS BEING PROVIDED BY THE PRESERVATION OF EXISTING VEGETATION.

- NOTE:**
1. TREE BARRICADES MUST BE INSPECTED AND APPROVED BY THE CHW INSPECTOR PRIOR TO ANY CLEARING, DEMOLITION, OR GRUBBING WORK BEGINS.
 2. TREE BARRICADES SHALL REMAIN IN-PLACE, AND IN WORKING ORDER THROUGHOUT THE CONSTRUCTION PHASE. BARRICADES SHALL BE REMOVED ONCE MAJOR CONSTRUCTION IS COMPLETE AND PRIOR TO COMPLETION OF LANDSCAPE INSTALLATION.
 3. NO CONSTRUCTION EQUIPMENT, MATERIALS, SUPPLIES, FUELS OR CHEMICALS SHALL BE STORED WITHIN THE TREE BARRICADE LIMITS.
 4. TREE BARRICADE STAKING MAY BE ADJUSTED TO FIT CONSTRUCTION NEEDS.
 5. HEAVY MULCH COVER 6"-10" DEEP TO REDUCE COMPACTION.
 6. INVIGORATE TREES PRIOR TO CONSTRUCTION - LIGHT FERTILIZER (1LB. N/1000 SF)(WATER IF POSSIBLE).
 7. "PRE-CUT" ROOTS AT LIMITS OF CONSTRUCTION TO PREVENT TEARING BY EQUIPMENT.

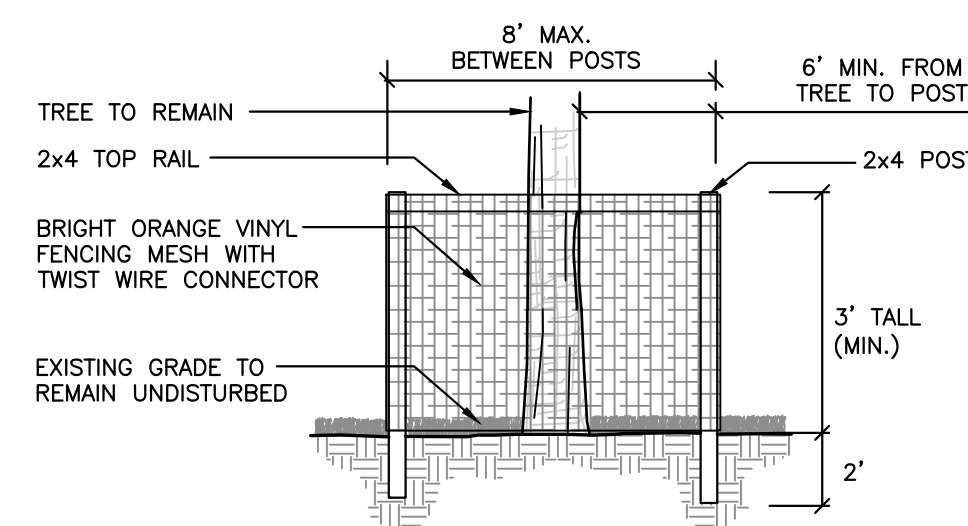

3 TREE PROTECTION DETAIL
SCALE: N.T.S.

PLANT SCHEDULE

TREES	QTY	BOTANICAL NAME	COMMON NAME	SIZE
AR	26	ACER RUBRUM 'FLORIDA FLAME'	FLORIDA FLAME RED MAPLE	3" CAL MIN, 10' HT MIN
CC	2	CERCIS CANADENSIS	EASTERN REDBUD	3" CAL MIN, 10' HT MIN
CF	10	CORNUS FLORIDA 'CLOUD NINE'	CLOUD NINE DOGWOOD	3" CAL MIN, 10' HT MIN
IAE	11	ILEX X ATTENUATA 'EAST PALATKA'	EAST PALATKA HOLLY	3" CAL MIN, 10' HT MIN
JS	19	JUNIPERUS SILICICOLA	SOUTHERN RED CEDAR	3" CAL MIN, 10' HT MIN
LC	3	LAGERSTROEMIA INDICA 'CATAWBA'	CATAWBA CRAPE MYRTLE	3" CAL MIN, 10' HT MIN
LIM	5	LAGERSTROEMIA INDICA 'MUSKOGEE'	MUSKOGEE CRAPE MYRTLE	3" CAL MIN, 10' HT MIN
LIO	2	LAGERSTROEMIA INDICA X FAURIEI 'TONTIO'	TONTO CRAPE MYRTLE	3" CAL MIN, 10' HT MIN
LIW	5	LAGERSTROEMIA INDICA 'WHIT II' TM	DYNAMITE CRAPE MYRTLE	3" CAL MIN, 10' HT MIN
MGL	19	MAGNOLIA GRANDIFLORA 'LITTLE GEM'	LITTLE GEM MAGNOLIA	3" CAL MIN, 10' HT MIN
PA	8	PRUNUS ANGUSTIFOLIA	CHICKASAW PLUM	3" CAL MIN, 10' HT MIN
QS	9	QUERCUS SHUMARDII	SHUMARD RED OAK	3" CAL MIN, 10' HT MIN
QV	15	QUERCUS VIRGINIANA	SOUTHERN LIVE OAK	3" CAL MIN, 10' HT MIN
QVB	3	QUERCUS VIRGINIANA 'BOARDWALK'	BOARDWALK LIVE OAK	3" CAL MIN, 10' HT MIN
SHRUBS	QTY	BOTANICAL NAME	COMMON NAME	SIZE
IDB	161	ILEX CORNUTA 'DWARF BURFORDII'	DWARF BURFORD HOLLY	3 GAL, 18" HT X 12" SPR
LL	161	LOROPETALUM CHINENSE 'PLUM'	PLUM LOROPETALUM	3 GAL, 18" HT X 12" SPR
VO	161	VIBURNUM OBOVATUM 'MRS. SCHILLER'S DELIGHT'	MRS. SCHILLER'S DELIGHT VIBURNUM	3 GAL, 18" HT X 12" SPR
VOL	161	VIBURNUM ODORATISSIMUM	SWEET VIBURNUM	3 GAL, 18" HT X 12" SPR
SOD/SEED	BOTANICAL NAME	COMMON NAME	SIZE	
SOD	PASPALUM NOTATUM 'ARGENTINE'	BAHIA GRASS	WEED FREE AND SAND GROWN SOD	

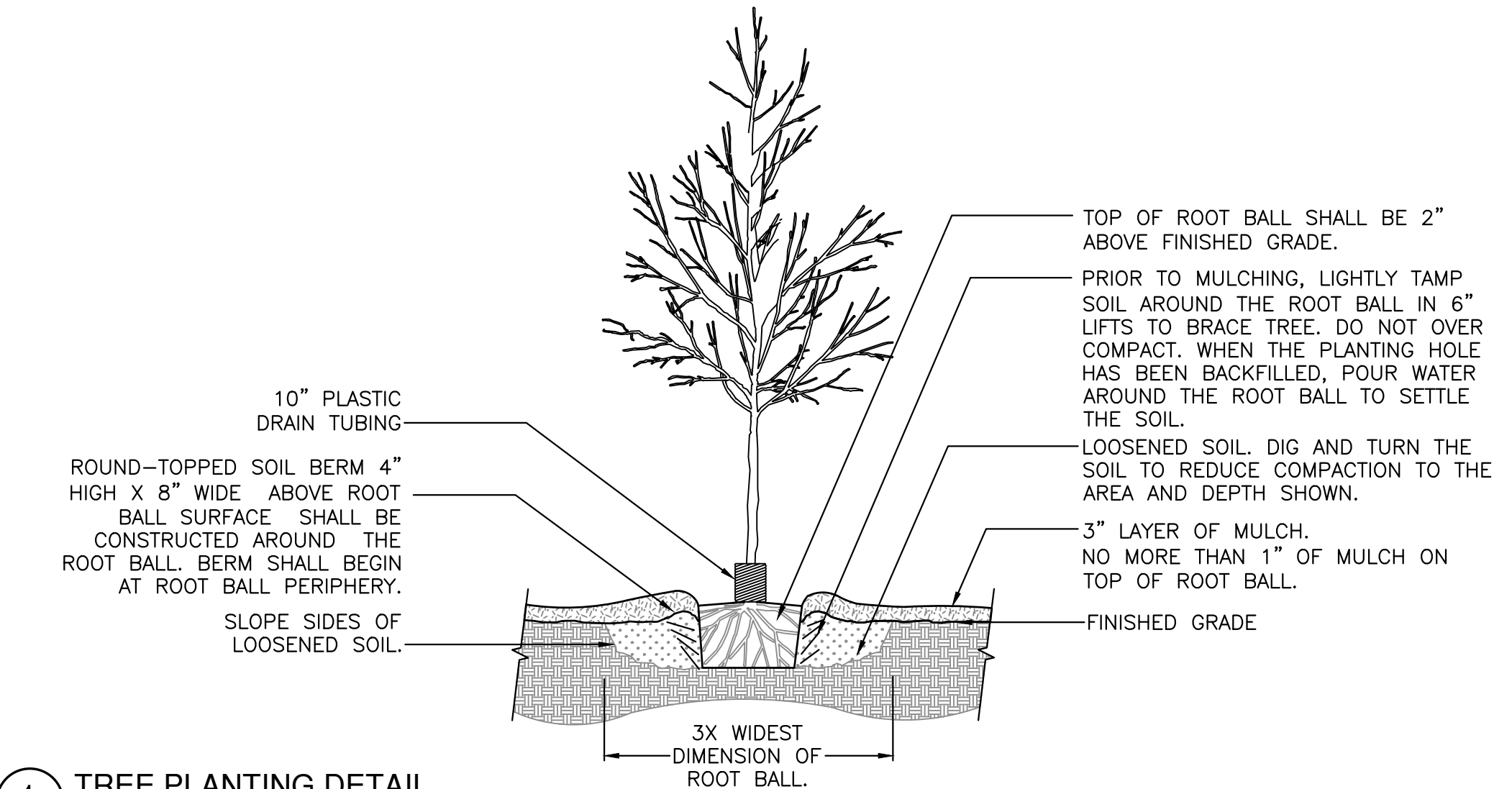

1 TREE PLANTING DETAIL
SCALE: N.T.S.

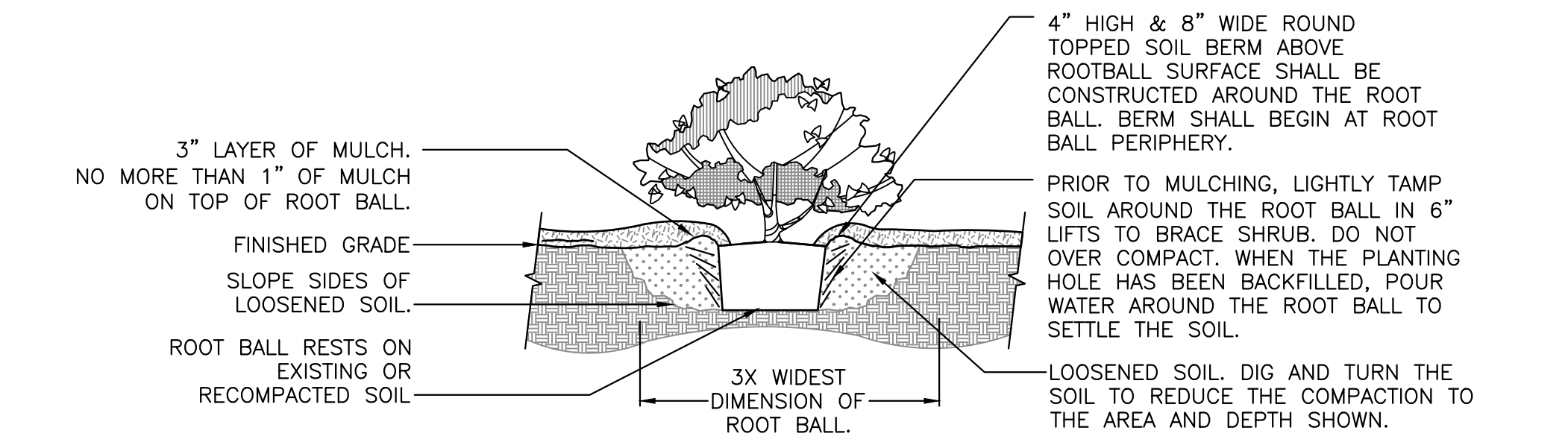

2 SHRUB PLANTING DETAIL
SCALE: N.T.S.

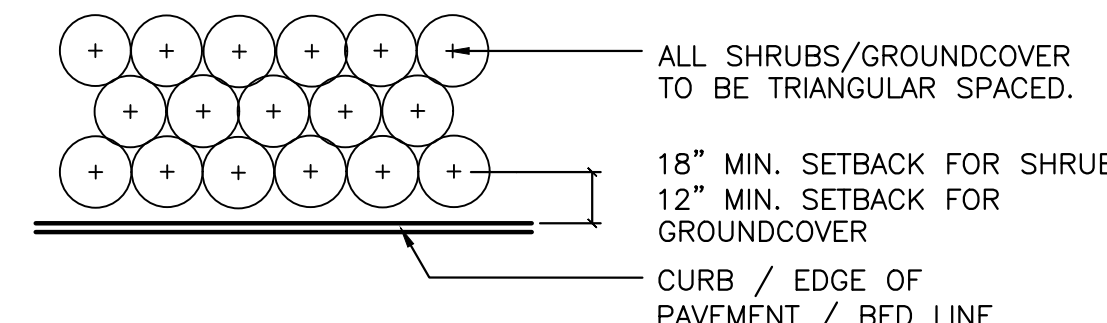

NOTE: THE PERIMETER OF ALL CURVED PLANTING BEDS SHALL BE PLANTED WITH A ROW OF SHRUBS AS SHOWN IN THE PLANS AND AT THE SPACING SHOWN IN THE PLANT LIST. INTERIOR PORTIONS OF EACH BED SHALL BE PLANTED AT APPROPRIATE SPACING ACCORDING TO THIS PLANT SCHEDULE.

5 SHRUB PLANTING DETAIL
SCALE: N.T.S.

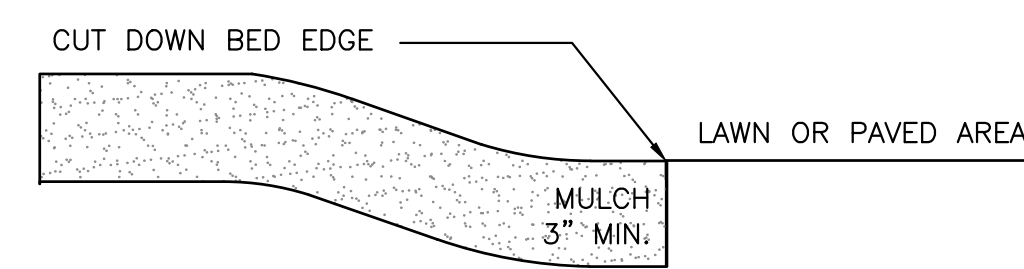

4 MULCH DETAIL
SCALE: N.T.S.

811
KNOW WHAT'S BELOW
ALWAYS CALL 811 BEFORE YOU DIG
It's fast, it's free, it's the law.
Call 811 two business days before digging

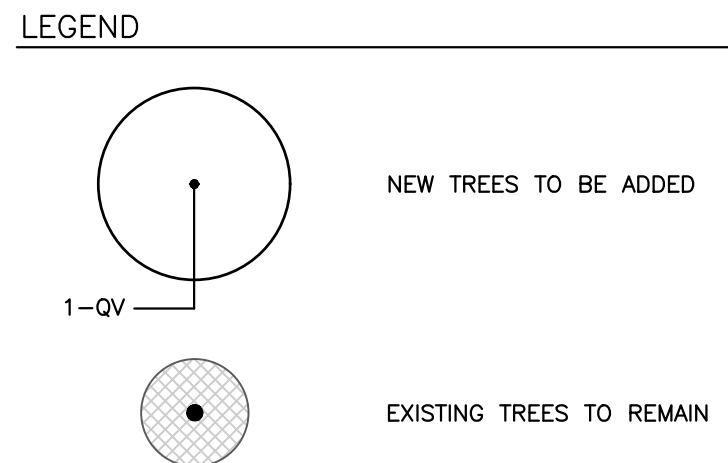

8466 Merchants Way, Ste. 102
Jacksonville, Florida 32222
(904) 619-6521
www.chw-inc.com
est. 1988
FLORIDA
LA0001683

CHW
Professional Consultants

SCALE: N/A
DESIGN: N/A
DATE: 05/17/2023
BY: JMS
CHECKED: JMS
APPROVED: JMS

CONSTRUCTION/REV. REVISIONS:
10/23/23 - REVISION #1

DATE: 05/17/2023
SUBMITTAL: FIRST SUBMITTAL
05/17/2023
SUBMITTAL: SECOND SUBMITTAL
06/23/2023
SUBMITTAL: THIRD SUBMITTAL
09/12/2023
SUBMITTAL: FOURTH SUBMITTAL

CLIENT: DAVIS AND SONS
PROJECT: MILLS CREEK PRESERVE PHASE 2
SHEET TITLE: LANDSCAPE SCHEDULE, NOTES, AND DETAILS
PROJECT NUMBER: 17-0279

DESIGNER: CV
CHECKER: CV
PROJECT CONTROL: JMS

REGISTERED LANDSCAPE ARCHITECT
MICHAEL SIMMONS
LA6667436
STATE OF FLORIDA

SHEET NO.: **LS-1**

File Name: L:\2017\17-0279\Design\02_Production\02_SPK\02_DWG (P1 23)\01_Landscaping\17-0279 design-bas.dwg
Text: jahn-mishara For Date: Oct 23, 2023 3:58pm



KNOW WHAT'S BELOW
ALWAYS CALL 811 BEFORE YOU DIG
It's fast, it's free, it's the law.
Call 811 two business days before digging

NOTE:
ANY PLANT MATERIAL PLANTED AS PART OF THE PREVIOUS PHASE DURING THE CONSTRUCTION OF PHASE 2 SHALL BE REMOVED AND REPLACED. CONTACT THE LANDSCAPE ARCHITECT TO DISCUSS ALTERNATIVE LOCATIONS IF THE PLANT MATERIAL CANNOT BE REPLACED IN THE SAME LOCATION.

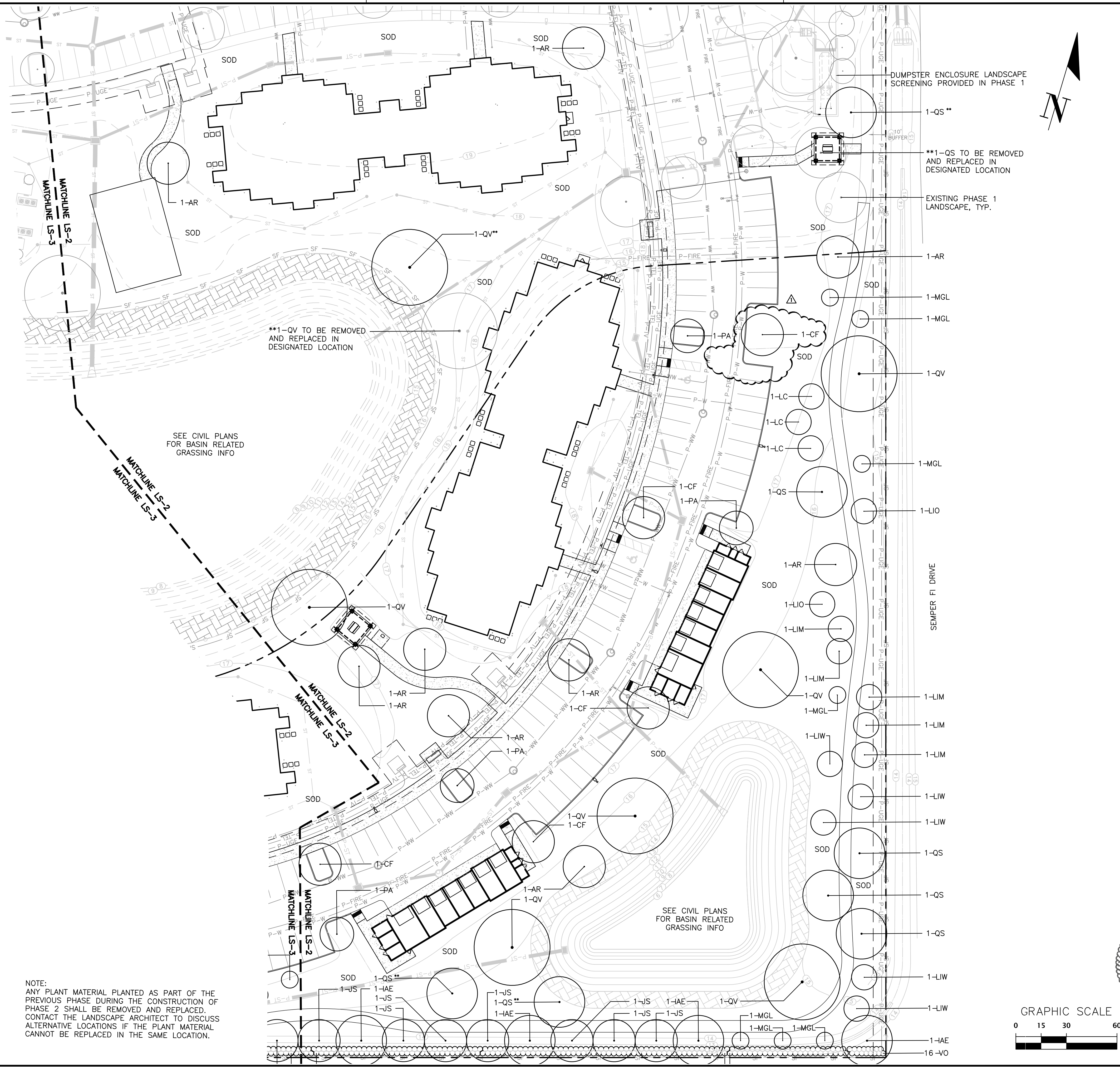

SEE CIVIL PLANS FOR BASIN RELATED GRASSING INFO

SEE CIVIL PLANS FOR BASIN RELATED GRASSING INFO

DUMPSTER ENCLOSURE LANDSCAPE SCREENING PROVIDED IN PHASE 1

1-QS **

**1-QS TO BE REMOVED AND REPLACED IN DESIGNATED LOCATION

EXISTING PHASE 1 LANDSCAPE, TYP.

1-AR

1-MGL

1-MGL

1-QV

1-LC

1-LC

1-LC

1-MGL

1-LIO

1-AR

1-LIO

1-LIM

1-LIM

1-LIM

1-LIM

1-LIW

1-LIW

1-LIW

1-LIW

1-QS

1-QS

1-QS

1-QS

1-LIW

1-LIW

1-LIW

1-AE

1-MGL

1-MGL

16-V0

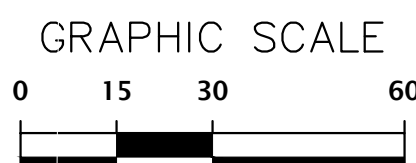

8466 Merchants Way, Ste. 102
Jacksonville, Florida 32222
www.chw-inc.com
est. 1988 FLA0001683

CHW
Professional Consultants

SCALE: 1"=30'
THIS SCALE IS FOR REFERENCE ONLY. ALL DIMENSIONS SHALL BE BASED ON THE ORIGINAL DRAWING. DIMENSIONS SHOWN ON THIS SHEET SHALL ADJUST TO THE ORIGINAL DRAWING SCALES ACCORDINGLY.

CONSTRUCTION/REVISIONS:
10/23/23 - REVISION #1

DATE: 10/23/23

REVISIONS:
01/17/2023 FIRST SUBMITTAL
05/16/2023 SECOND SUBMITTAL
06/23/2023 THIRD SUBMITTAL
09/12/2023 FOURTH SUBMITTAL

CLIENT: DAVIS AND SONS
PROJECT: MILLS CREEK PRESERVE PHASE 2
SHEET TITLE: LANDSCAPE PLAN

DESIGNER: CV
CHECKER: CV
QUALITY CONTROL: JMS
PROJECT NUMBER: 17-0279

STATE OF FLORIDA
LANDSCAPE ARCHITECT
MICHAEL SIMON
LA6667436

SHEET NO: LS-2

File Name: L:\2017\17-0279\Design\02_Production\02_SPK\02_DWG (P1) (1) - 17-0279.dwg
 Plot Date: 04/23/2023 3:58pm
 Plotter: John-mishere

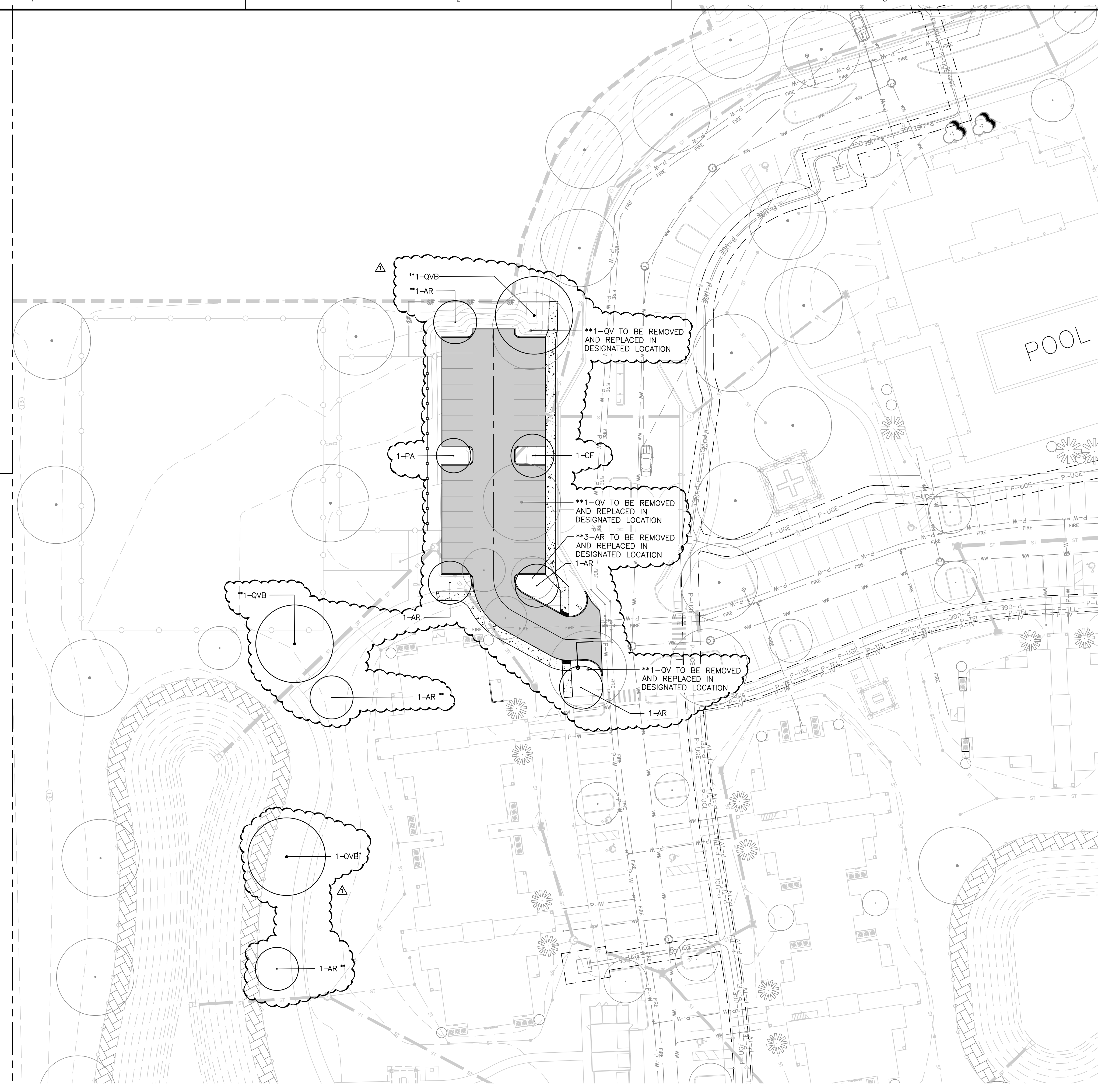

811 KNOW WHAT'S BELOW
 ALWAYS CALL 811 BEFORE YOU DIG
 It's fast, it's free, it's the law.
 Call 811 two business days before digging

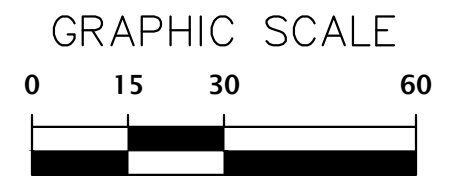
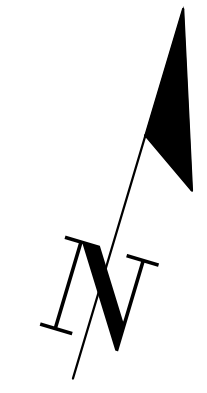

<p>8466 Merchants Way, Ste. 102 Jacksonville, Florida 32222 (904) 619-6521 www.chw-inc.com est. 1988 LA0001683</p>	
<p>CHW Professional Consultants</p>	
<p>SCALE: 1"=30'</p>	<p>REVISIONS: 01/17/2023 FIRST SUBMITTAL 05/23/2023 SECOND SUBMITTAL 09/12/2023 THIRD SUBMITTAL 09/12/2023 FOURTH SUBMITTAL</p>
<p>CONSTRUCTION/REV. REVISIONS: 10/25/23 - REVISION #1</p>	<p>CLIENT: DAVIS AND SONS PROJECT: MILLS CREEK PRESERVE PHASE 2 SHEET TITLE: LANDSCAPE PLAN</p>
<p>DESIGNER: CV CHECKER: CV QUALITY CONTROL: JMS PROJECT NUMBER: 17-0279</p>	<p>REGISTERED LANDSCAPE ARCHITECT MICHAEL SIMON LA6667436 STATE OF FLORIDA</p>
<p>SHEET NO: LS-4</p>	